

vax

RapideSpringClean CARPET WASHER

WASHES CARPETS
LEAVING THEM CLEAN
AND FRESH

LET'S GET STARTED.

2 YEAR WARRANTY

VCWRS700



Let's talk safety



Basic safety precautions

This Carpet Washer is intended for household use only and NOT for commercial or industrial use.

READ ALL THE INSTRUCTIONS BEFORE USING THIS APPLIANCE

- This appliance is not intended for use by persons (including children) with reduced physical, sensory or mental capabilities, or lack of experience and knowledge, unless they have been given supervision or instruction concerning the use of the appliance by a person responsible for their safety.

- Using improper voltage may result in damage to the motor and possible injury to the user. The correct voltage is listed on the rating label.

Please keep instructions for further use.



Don'ts

- ✗ Do not leave the carpet washer unattended when plugged in. Unplug it from socket when not in use.
- ✗ To prevent electric shock do not use outdoors.
- ✗ Not to be used as a toy. Children should be supervised to ensure that they do not play with the appliance.
- ✗ Do not use the carpet washer if it has been dropped, damaged, left outdoors or dropped into water. Do not use the carpet washer with a damaged cord or plug. If the supply cord is damaged, it must be replaced by the manufacturer or a recommended Service Agent to avoid hazard and invalidating the guarantee.
- ✗ Do not pull or carry by cord/hose. Do not use the cord/hose as a handle, close a door on the cord/hose or pull cord/hose around sharp edges or corners. Do not run the carpet washer over the cord/hose. Keep the cord away from heated surfaces.
- ✗ Do not unplug by pulling on the cord.
- ✗ Do not handle the plug or carpet washer with wet hands.
- ✗ Do not put any objects into openings or operate with openings blocked, keep them free of anything that may reduce airflow.
- ✗ Do not use the carpet washer on any glowing, burning or smoking particles.
- ✗ Do not use without the solution tank and dirty water tank in place.
- ✗ Do not use to pick up flammable or combustible liquids such as petrol, or use in areas where they may be present.
- ✗ Do not attempt to remove blockages with sharp objects as they may cause damage.
- ✗ A hazard may occur if the carpet washer runs over the power supply cord.
- ✗ To prevent dirty water from running into the motor, do not hold the appliance upside-down or lay on its side. Use appliance in normal cleaning position.
- ✗ Do not carry appliance while motor is running.



Do's

- ✓ Use only as described in this manual.
- ✓ Keep hair, loose clothing, fingers and all parts of the body away from openings and moving parts.
- ✓ Turn off all controls before unplugging.
- ✓ Keep the unit on the floor.
- ✓ Store indoors put away after use to prevent tripping accidents.
- ✓ Use extra care when cleaning on stairs.
- ✓ Use only SAA approved 10amp extension cords. Non-approved cords may overheat. Care should be taken to arrange the cord so that the cord cannot be tripped over.

WARNING: Always switch off and unplug your machine from the electrical outlet before filling and emptying the clean water tank, emptying the dirty water tank, before assembling, opening, before connecting/disconnecting the attachments, or carrying out maintenance or troubleshooting checks and storage.

NOTE: Carpets should be dry vacuumed thoroughly before washing.

IMPORTANT: If the hose or tools are blocked, switch off and unplug the carpet washer and remove the blockage(s) before re-starting your machine.

IMPORTANT: Even with regular cleaning, filters have a limited lifespan and will eventually need to be replaced during the lifetime of the cleaner. If the performance of your cleaner is compromised and/or the filters are severely discoloured, the filters may need to be replaced. As a general guide, Vax recommends filters be replaced every 3-6 months depending on the level of use to ensure optimum performance of your cleaner.

This machine is intended for household use only, and NOT for commercial or industrial use.

PLEASE KEEP THESE INSTRUCTIONS FOR FURTHER USE.

Thank you for buying this Rapide Spring Clean.

Taking care of your carpets

The Rapide Spring Clean is designed to make carpet cleaning as quick and convenient as possible and this user guide will help you get the most out of your machine.

Taking care of your Rapide Spring Clean

Also inside this guide are instructions on maintaining your new machine, so that it's always ready when you need it.

We're here if you need us

The Vax logo is displayed in a bold, orange, sans-serif font. The letters 'v' and 'a' are lowercase, while 'x' is uppercase. A registered trademark symbol (®) is located at the top right of the 'x'.

For troubleshooting simply visit or call:

Australia: 1300 361 505*
vax.com.au

New Zealand: 0800 800 900*
vax.co.nz

*Monday – Friday: 8:30am -5:00pm

Calls are charged at the standard local rate. Please make note of the serial number and model number of the product before calling.

Let's talk safety

Getting to know your machine

Getting started

Using your machine

Taking care of your machine

What to do if it goes wrong

Getting in touch

Rapide Spring Clean

Included with
your machine



Vax Cleaning
Solution Bottle

Getting to know your machine

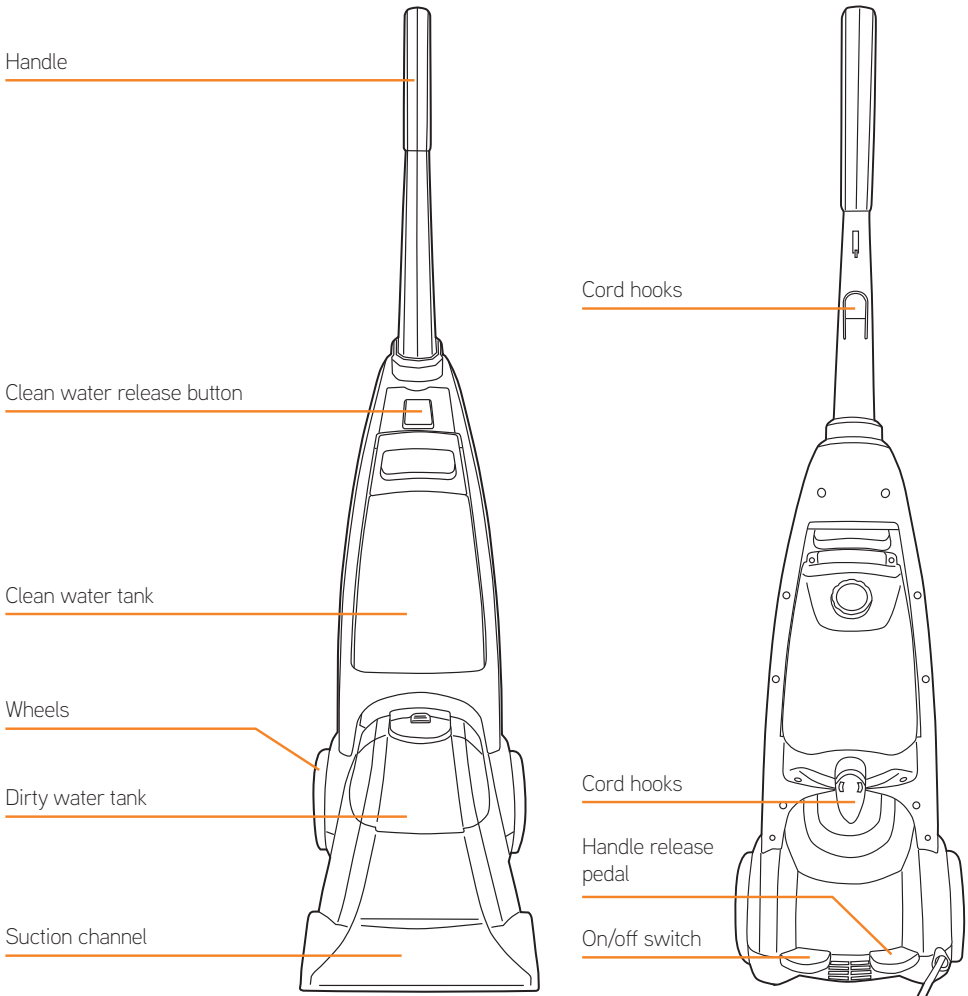

Technical Specification

Name **Rapide Spring Clean**
Model No **VCWRS700**
Voltage **220-240V ~ 50Hz**
Wattage **700W**

Capacity **Clean water tank 2.6L**
Dirty water tank 1.8L
Weight **6.2kg**
Cord length **6m**

PLEASE READ 'LET'S TALK SAFETY' AT THE BEGINNING BEFORE USE

Assembly: Putting your cleaner together

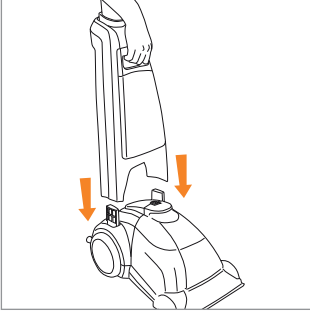

Insert middle frame to machine base.

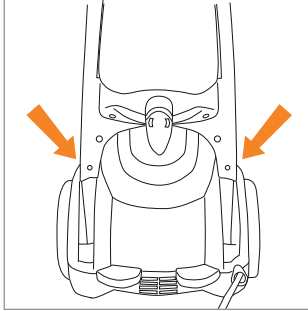

Insert one screw on either side of middle frame to secure.

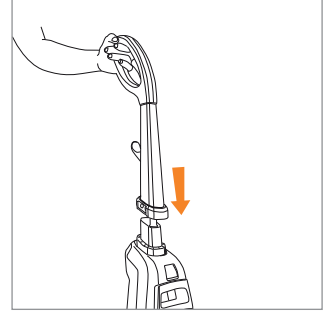

Slide the upper handle down onto the unit. The handle will click and lock in place. Run the mains wire above the upper cord hook and secure with the cord clip.

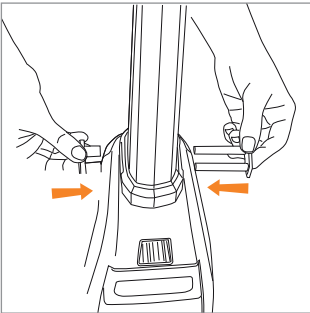

Insert locking pins into either side of handle.

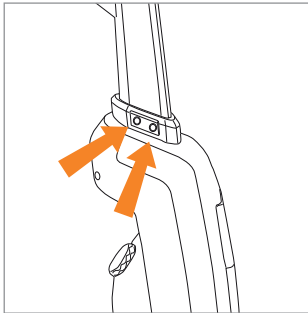

Screw locking pins into handle.

Using your machine

IMPORTANT: Turn off when emptying and filling the tanks and performing any maintenance.

Putting the Vax Cleaning Solution into the machine

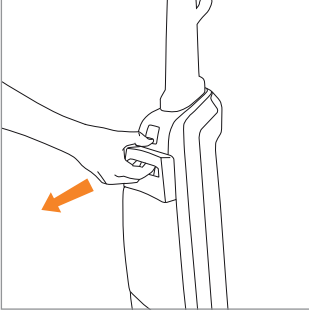

Grasp the solution reservoir under the handle and press the handle release lever.

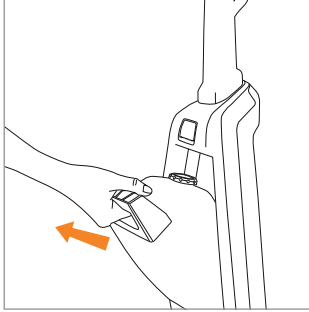

Tilt the solution reservoir away from the cleaner and remove.

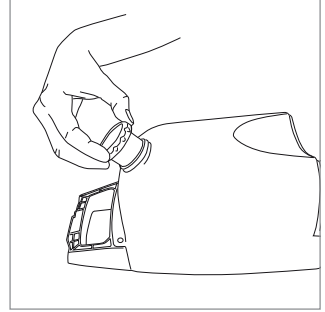

Unscrew the cap from the back of the solution reservoir.

Pour the correct amount of Vax Solution as directed on the solution label into the clean water tank.

Using your machine

Operation

IMPORTANT: Maximum water temperature 50°C

IMPORTANT: Never leave the cleaner unattended with the power on.

NOTE: Vacuum carpets thoroughly with dry vacuum cleaner before washing.

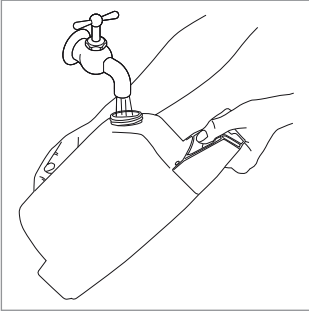

Fill the remaining space in the solution reservoir with warm tap water. Replace the measuring cap.

NOTE: use only Vax Solution, using other cleaning solutions may cause excessive foaming. This may cause the float to shut off the cleaner prematurely. Using other cleaning solutions will invalidate your warranty.

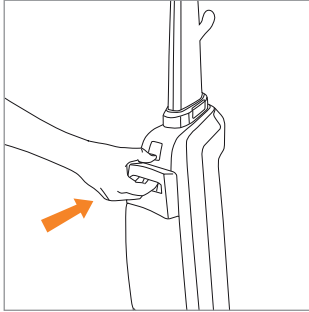

Place the bottom of the solution reservoir into the cleaner and push into place. There will be an audible click when the reservoir is in the correct position.

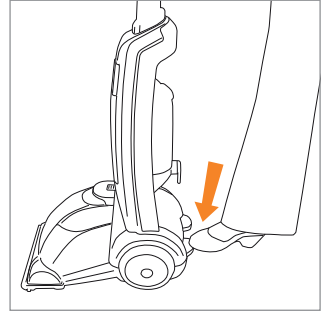

Plug the cord into a mains electricity socket. Turn the power switch on.

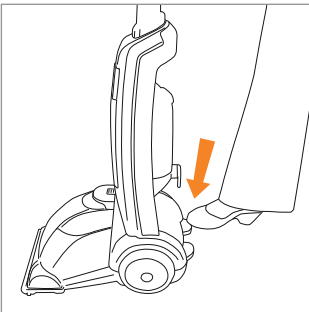

The switch is located on the back of the cleaner, next to the handle release.

The power switch controls the vacuum motor. Press on the handle release pedal and pull the cleaner back into a reclined position.

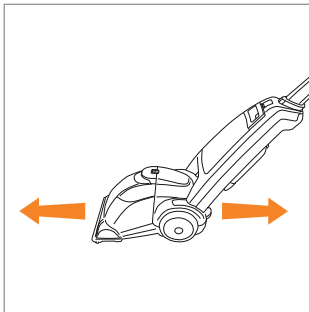

Whilst depressing solution spray trigger, push carpet washer in a forwards motion. Release trigger and pull unit backwards in same path to remove dirty water and solution from the carpet.

Repeat if necessary, when the dirty water reaches the max fill line on the dirty water tank empty the tank.

Taking care of your machine

Emptying the dirty water tank

NOTE: The float in your Rapide is located in the lid of the dirty water tank. It will shut off the suction when the dirty water tank is full. For best results use a smooth steady motion keeping the nozzle flat against the carpet.

Tipping the cleaner and breaking the seal of the nozzle against the carpet will cause the float to rise cutting off suction. Once the float is activated, empty the dirty water tank. If the tank does not appear full turn off the power switch and wait for the float to settle. For best results use only Vax Solution.

You will hear a change in motor pitch when the tank is full and needs emptying.

IMPORTANT: Unplug your cleaner before emptying the dirty water tank.

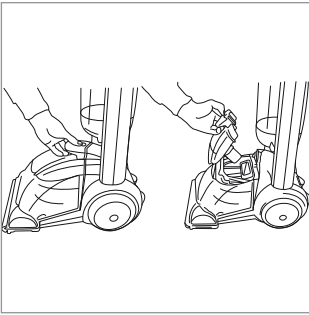

Grasp the top of the dirty water tank handle and press the release latch. Pull to remove from the base, take care to ensure that no dirty water leaks from the front.

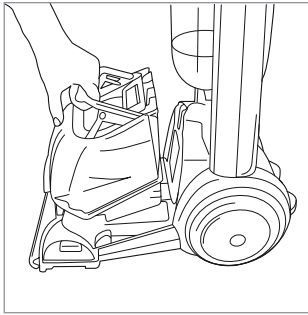

Remove dirty water tank.

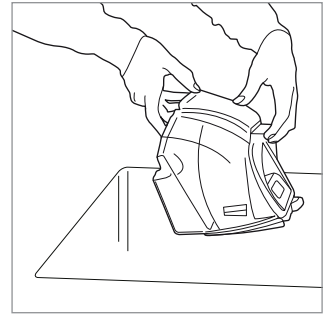

To empty the water tank grasp the handle with one hand and nozzle with the other and empty into the sink.

Cleaning the dirty water tank

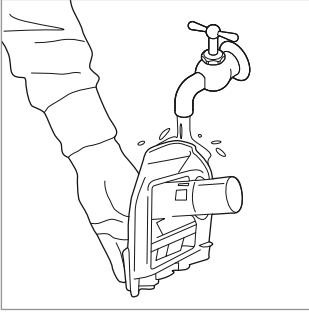

Rinse the dirty water tank and top thoroughly, with warm water.
You should allow them to dry fully before replacing them on your cleaner to prevent mildew.
Do not use any chemicals in the cleaning process.

Replacing the dirty water tank

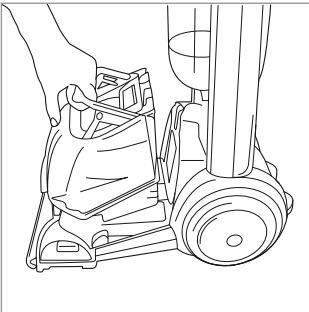

Lift the front of the carpet cleaner base off the carpet with one hand. Grasp the handle and hook the front of the dirty water tank into the base, making sure that the front of the dirty water tank is resting on the base.

Failure to install the dirty water tank correctly will result in poor dirty water pick up.

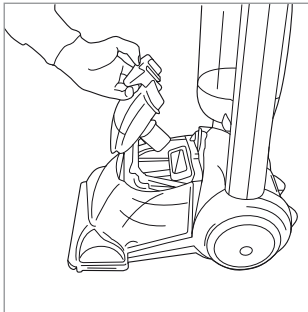

While making sure the dirty water tank is resting on the base of the cleaner, place the rear of the tank into the base of the cleaner, push down on the handle until it latches.

Replace top of dirty water tank by pressing it into place.

Taking care of your machine

Brush removal and replacement

NOTE: The plug must be removed from socket outlet before cleaning or maintaining the appliance.

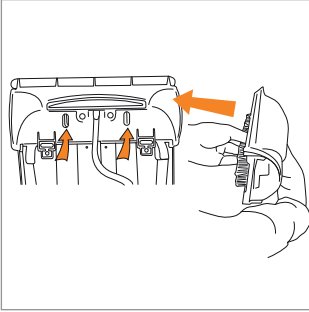

Switch off and unplug carpet washer, then remove the water tank.

Flip the cleaner on its side to expose the nozzle base.

Lift out the floating brush bar by pressing the two latches and pulling it gently.

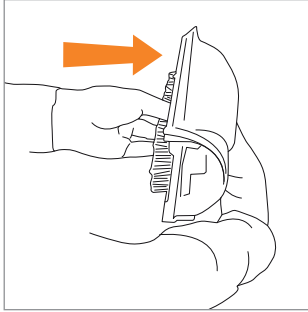

Replace floating brushbar.

Taking care of your machine

Cleaning the tank filter

IMPORTANT: Do not use any detergents or boiling water to wash the filters. Vax recommends checking the filters.

NOTE: All filters must be in place before using your machine.

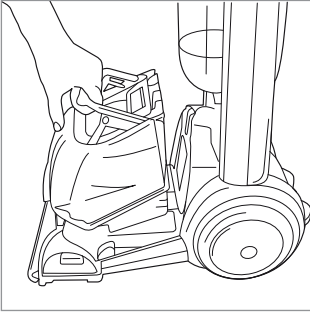

Remove the dirty water tank from the unit.

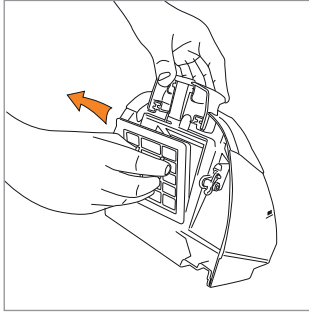

Remove the filter cover from the back of the tank.

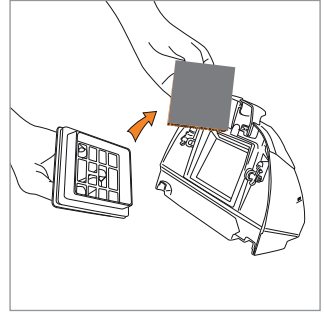

Separate the filter from the filter cover.

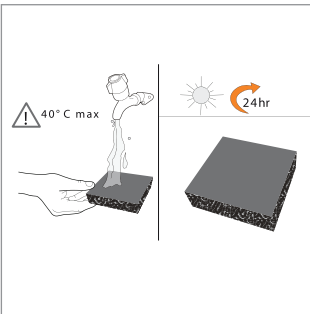

The filter can be rinsed in warm water (max. 40°C).

IMPORTANT: Ensure filter is fully dry (allow 24hrs) before replacing back into the machine.

What to do if it goes wrong

Problem

Solution

The cleaner won't run.

- Not properly plugged into electrical outlet. Plug in firmly.
- No electricity in electrical outlet. Check fuse or breaker.
- On/off switch not turned on. Push on/off switch to 'on'.
- Blown fuse/tripped breaker. Reset circuit breaker or replace fuse.

Cleaner won't pick up/loss of suction.

- Dirty water tank is full. Switch off and unplug cleaner. Empty dirty water tank.
- Dirty water tank not installed correctly. For fitting information, refer to "Replacing Dirty Water Tank" in the "Taking Care of your machine" section.
- Obstruction in hose/nozzle. Solution: Remove hose and clear obstruction.

Liquid escaping from the carpet washer.

- Dirty water tank is full. Switch off and unplug cleaner. Empty dirty water tank refer to "Emptying the Dirty Water Tank" in the "Taking Care of your machine" section.
- Dirty water tank not installed correctly. For fitting information, refer to "Replacing Dirty Water Tank" in the "Taking Care of your machine" section.
- Solution tank not installed correctly. Make sure the tank is securely locked in place.

Clean solution won't dispense.

- Solution tank not installed correctly. Make sure the tank is securely locked in place.
- Solution tank empty. Refill tank. Refer to "Using you machine" section.
- Handle not fitted correctly. Solution: Ensure handle is fitted correctly.

Taking care of you

2 YEAR WARRANTY

We're here if you need us. For trouble shooting, simply call or visit:

Australia: 1300 361 505*

vax.com.au

New Zealand: 0800 800 900*

vax.co.nz

*Monday-Friday 8.30am to 5.00pm

vax[®]

Distributed by Techtronic Industries Australia Pty. Ltd.
31 Gilby Road, Mt Waverley, VIC 3149 Australia.
Careline AU: 1300 361 505 www.vax.com.au
Careline NZ: 0800 800 900 www.vax.co.nz