

vax

SteamClassic
STEAM CLEANER

QUICK AND EASY
STEAM CLEANING

LET'S GET STARTED.

1 YEAR WARRANTY

VX69



vax.com.au
vax.co.nz



Let's talk safety



Basic safety precautions

READ ALL THE INSTRUCTIONS BEFORE USING THIS APPLIANCE

This steam mop is intended for household use only and NOT for commercial or industrial use.

When using the cleaner basic safety precautions should always be observed, including the following:

- Only use the steam mop indoors away from rain and moisture and keep the area you're cleaning well lit
- Turn OFF the on/off switch on the steam mop controls before disconnecting or connecting from the mains supply
- Always unplug the steam mop and allow it to cool before connecting or disconnecting accessories or performing any maintenance
- Children should be supervised to ensure that they do not play with the appliance
- This appliance is not intended for use by children and persons with reduced physical, sensory or mental capabilities or lack of experience and knowledge, unless they have been given supervision or instruction concerning use of the appliance by a person responsible for their safety
- Please refer to floor manufacturer's care recommendations before use, and test your flooring/carpet/rugs by running the steam mop over a small hidden area, if no pile distortion or no damage occurs continue cleaning. Not suitable for use on wax polished floors or furniture, acrylic surfaces and synthetic, velvet or steam/water sensitive materials
- Keep fingers, hair and loose clothing from moving parts and openings whilst using the steam mop
- This steam mop should not be used to clean electrical appliances such as microwaves, oven, televisions and electrical heating systems etc



WARNING: Danger of scalding

WARNING: The stick steam mop head gets very hot during operation.

IMPORTANT: The steam mop is equipped with a thermostat and a thermal cut-out. If for any reason the unit should overheat, the thermostat will automatically turn the unit off. Should this occur, unplug the steam mop from the electrical outlet and turn off the switch. Let the unit cool, remove and empty the water tank. To re-start the machine, plug it into an electrical outlet and switch it back on.

IMPORTANT: We recommend the use of a Residual Current Device with a Residual Current rating of 30mA or less.

IMPORTANT: This steam mop may not be suitable for all floating floorboards or sealed floors – please check with your floorboard manufacturer first prior to use.

DAMAGE TO THE STEAM MOP CAUSED AS A DIRECT RESULT OF NOT ADHERING TO THE GENERAL SAFETY INFORMATION AND THE INSTRUCTIONS IN THIS USER GUIDE INVALIDATES THE WARRANTY

PLEASE KEEP THESE INSTRUCTIONS FOR FUTURE REFERENCE

Let's talk safety



Don'ts

- Don't touch any hot areas/accessories on your steam mop. It's normal for the steam mop and accessories to heat up during use, always allow them to cool down before handling
- Don't use the steam mop if it has been dropped, if there are visible signs of damage or if it is leaking, if it has been immersed in water or left outdoors
- Don't handle the plug or use the steam mop with wet hands
- Don't pull or carry this steam mop by the power cord
- Don't use the power cord as a handle, pull the power cord around corners or sharp edges or close a door over the power cord
- Don't attempt to remove blockages with sharp objects as this may cause damage to the steam mop, remove blockages only as instructed in this guide
- Don't unplug steam mop by pulling on the power cord or run over the power cord. If the power cord or plug is damaged please contact our Customer Care Line
- Don't aim the steam mop at people, animals, plants and electrical components such as interior of ovens or wires. Never touch the floor head from a short distance (there is a risk of scalding)



Do's

- Always fill the clean water tank with water only, never add perfume, stain remover or products containing alcohol. Filling the clean water tank with hot or boiling water will damage the machine and invalidate your warranty
- Always make sure tank is fitted correctly before using the steam mop
- Always vacuum your carpets thoroughly and ensure hard floor areas are free from grit and debris before using the steam mop
- Always carry the steam mop by the handle
- Always unplug the steam mop before carrying out any maintenance or when unattended
- Turn off all controls on the steam mop before disconnecting or connecting the power cord, after use always wrap the power cord around the cord clips provided
- Take extra care when cleaning on stairs
- Always protect the power cable from heated surfaces or near open flames
- Store the steam mop in a cool, dry area away from children
- Before storing the steam mop please ensure all water is removed from the tank

- Don't use the steam mop with incorrect voltage as this may result in damage or injury to the user. The correct voltage is listed on the ratings label
- Don't leave this steam mop unattended while it is connected to the supply mains
- Do not use this steam mop with a damaged cord or plug. If the supply cord is damaged return the steam mop to an authorised Service Agent
- Do not use without the tank cap in place. Ensure that the water tank cap has been screwed down fully before use
- Never immerse the steam mop in water or in other liquids
- Do not operate the steam mop without water in the tank
- Do not use the unit on leather, wax polished furniture or floors, synthetic fabrics, velvet or other delicate steam or water sensitive materials
- Do not use on acrylic surfaces
- Do not overfill the tank. Do not exceed the maximum prescribed filling level

WARNING: Never leave the steam mop in one spot on any surface for an extended period of time, as this may damage the floor surface.

- The force and heat of the steam may have an adverse effect on some materials. Always check whether a surface is suitable for treatment with the steam by carrying out a test before hand on a concealed area
- The steam mop must be kept level during operation
- Always remove the mains plug from the socket and allow the steam mop to cool down completely before topping up with water
- In wet rooms, e.g. bathrooms, connect the appliance to sockets with an RCD adaptor connected in series
- Be very careful when cleaning tiled walls with sockets

WARNING: Always switch off and unplug the steam mop from the electrical outlet before assembling, opening or emptying the water tank, or before connecting/disconnecting the attachments.

Thank you for buying this Steam Cleaner.

Taking care of your hard floors and above floor cleaning

The Steam Classic is a lightweight steam cleaner, designed to make the chore of cleaning hard floors and above floor cleaning such as bathrooms and kitchens as easy and efficient as possible and this user guide will help you to get the most out of your machine.

The incredible power of steam eliminates 99.9% of harmful germs and bacteria around the home, breaking down stubborn grease and grime and leaving every surface spotless and hygienic for a healthier home environment.

Taking care of your Steam Cleaner

Also inside this guide are instructions on maintaining your new machine, so that it's always ready when you are to tackle your hard floors and above floor cleaning.

We're here if you need us

For troubleshooting simply visit or call:

Australia: 1300 VAX AUS (1300 829 287)*

New Zealand: 0800 VAX NZL (0800 829 695)*

vax.com.au

vax.co.nz

The VAX logo is displayed in a bold, orange, sans-serif font. The letters are thick and closely spaced, with a slight shadow effect behind them.

*Monday – Friday: 8:30am -5:00pm

Calls are charged at the standard local rate. Please make note of the serial number and model number of the product before calling.

Contents

- Let's talk safety
- Getting to know your machine
- Getting started
- Using your machine
- Taking care of your machine
- What to do if it goes wrong
- Getting in touch
- Accessories

Steam Cleaner

Included with your machine

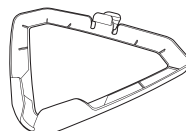

Carpet glider

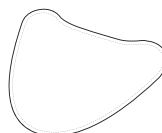

Microfibre pad

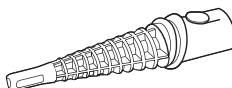

Concentration nozzle

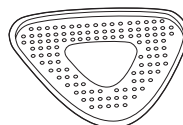

Cooling tray

Getting to know your machine

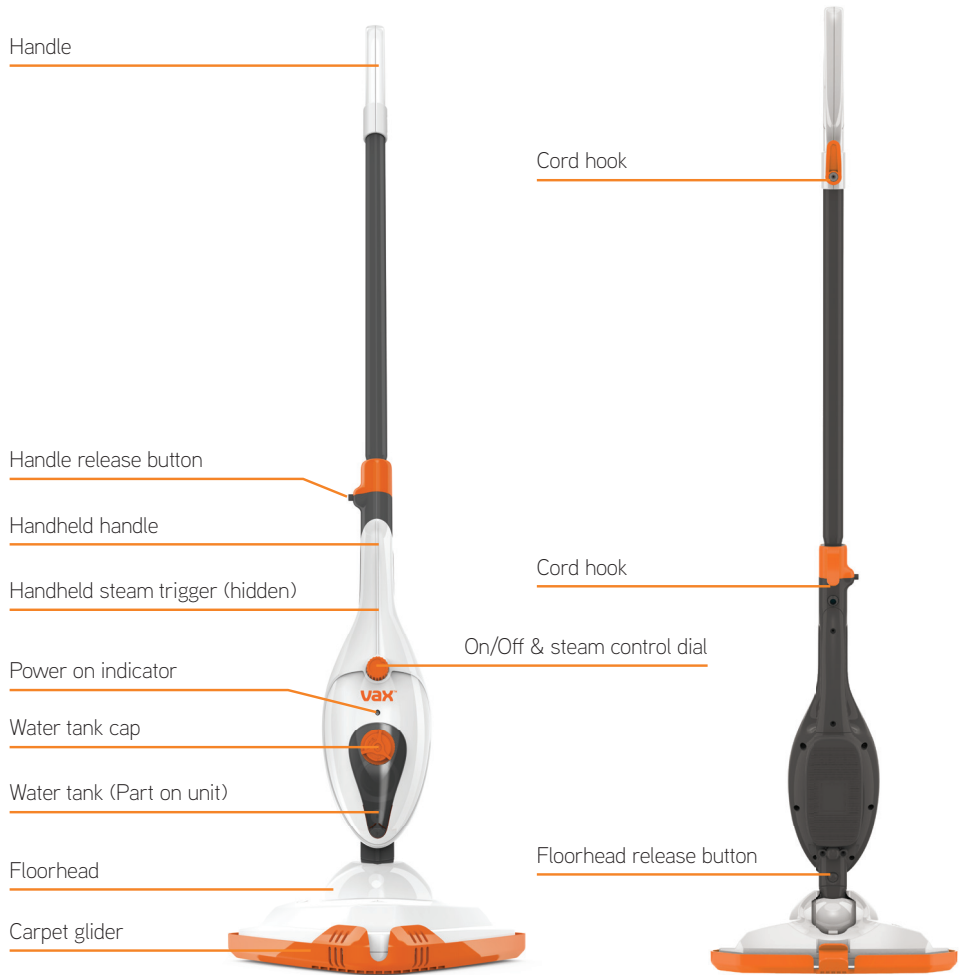

Technical Specification

Model **VX69**
Voltage **220-240V ~ 50/60Hz**
Wattage **1300W**
Cord length **5m**
Weight **2.1kg**

Accessories

Microfibre pads **VTHSP & VTHSP4**



This product meets applicable regulatory requirements



Indoor Use Only



Read Instructions

IPX4

Made in China to our exact specifications

Subject to technical change without notice.

*To purchase consumables and accessories, please visit vax.com.au

PLEASE READ 'LET'S TALK SAFETY' AT THE BEGINNING BEFORE USE

CAUTION:

- The steamer and accessories get very hot during use, always allow them to cool down before handling.
- Always unplug and switch off the steamer when assembling or disassembling.
- Always switch off the steamer before emptying the water tank or changing the cloths/accessories.

IMPORTANT:

- Please refer to floor manufacturer's care recommendations before use and test the steamer on a hidden area of flooring to begin with. Check with flooring manufacturer for suitability on sealed floors prior to use.
- Test for colour fastness in a small hidden area of upholstery/fabric to check for colour removal before use.
- When using the steamer, basic safety precautions should always be observed.
- Don't aim the steamer at people, animals, plants and electrical components or wires. Never touch the steam jet or floorhead from a short distance (there is a risk of scalding).
- The steamer is equipped with a thermostat and a thermal fuse. If for any reason the steamer overheats it will switch off. If this happens turn off and unplug the steamer, allow to cool for at least 2 to 4 hours and re-try.
- Don't use hot or boiling water to fill or clean water tank.

Assembling your steamer

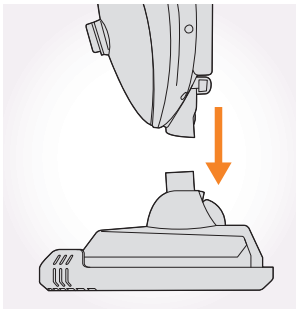

Push the main body down into the floorhead until it clicks into place.

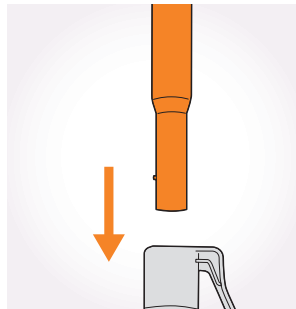

Push the handle into main body until it clicks into place. The collar should be gripped when connecting or releasing the handle.

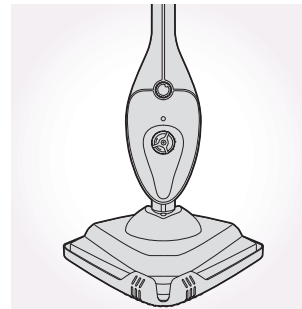

Stand the steamer upright by pushing the main body forward to lock into position.

Using your machine

Filling the water tank

IMPORTANT: Never turn the steamer over when water is in the tank, as some water may leak through the air valve. It is normal for the water tube to make a rattling sound inside the water tank during use.

IMPORTANT: Always fill the clean water tank with WATER ONLY. No solutions, detergents, alcohol or perfume to be used.

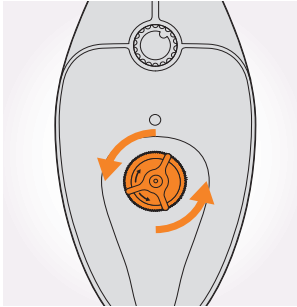

Remove floorhead and handle and place steamer on flat surface. Twist water tank cap anticlockwise and lift to remove.

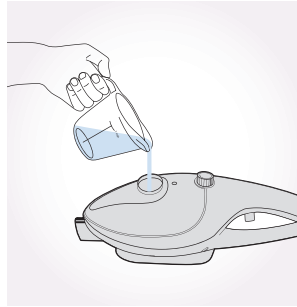

Do not fill directly from tap or over sink. Keep steamer on flat surface. Use a Measuring Jug to fill the tank with 330ml of water.

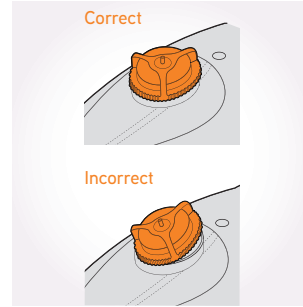

Replace cap, align tabs and twist clockwise to tighten.

Using your machine



Cleaning hard floors

IMPORTANT: Never use the steamer without a Microfibre Pad attached to the floorhead. Never leave the steamer on one spot for an extended period of time or with a damp or wet Microfibre Pad attached as this may damage the floor surface.

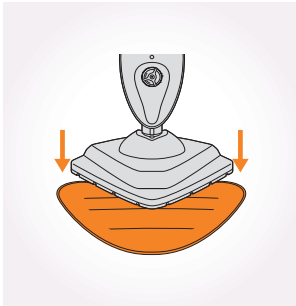

Place the Microfibre Pad on the floor white side facing up. Place the floorhead onto Microfibre Pad making sure the Microfibre Pad covers the entire floorhead.

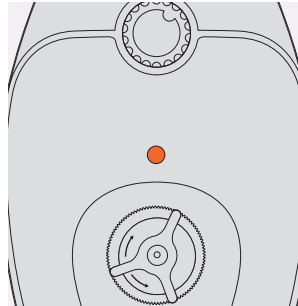

Plug into mains, turn dial to 'ON'; the red light will illuminate to indicate power on. The steamer will be ready after approximately 30 seconds. There will be no sounds for the first 30 seconds whilst it is heating up.

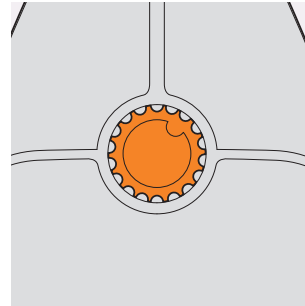

To steam your floors twist the steam control dial to desired setting. Steam is activated automatically. Take care when changing settings during cleaning.

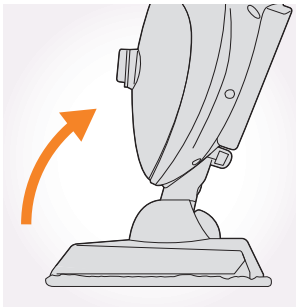

Place foot onto the floorhead and pull handle backwards to recline.

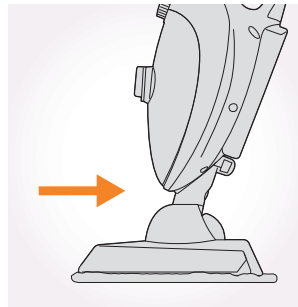

Move the steamer slowly backwards and forwards across the floor paying particular attention to high traffic areas.

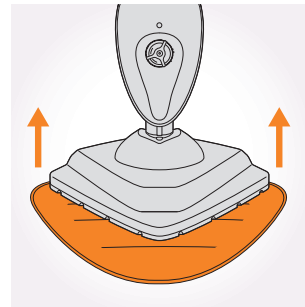

Turn dial to 'OFF' position and allow steamer to cool, the red light will switch off. Hold corner of pad down with your foot and lift steamer to peel away.

Using your machine

Refreshing Carpets

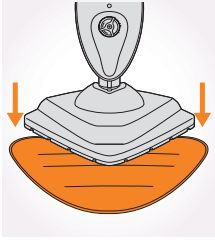

Place the Microfibre Pad on the floor white side facing up. Place steamer onto pad making sure the entire pad covers the floorhead.

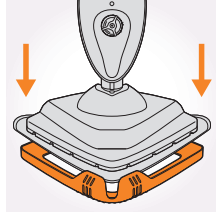

With Microfibre Pad attached, push steamer into front of the Carpet Glider, then place back of the floorhead into the clip. The Carpet Glider should only be used when refreshing carpets.

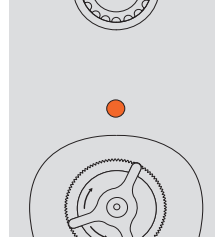

Plug into mains, turn dial to 'ON' position, the red light will illuminate to indicate power on. There will be no sounds for the first 30 seconds whilst it is heating up.

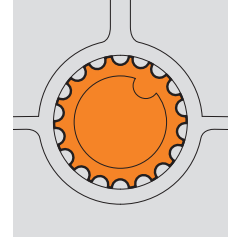

Twist the steam control dial to desired setting. Steam is activated automatically. Take care when changing settings during cleaning.

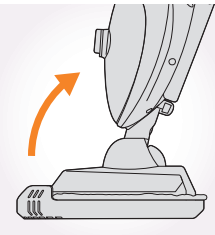

Place your foot on floorhead and pull handle backwards to recline.

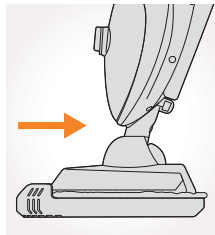

Move the steamer slowly backwards and forwards across the carpet paying particular attention to high traffic areas.

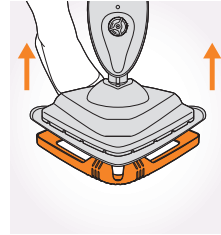

To release the Carpet Glider, place your foot on clip and push down. Lift steamer to remove.

IMPORTANT: When using on carpets, always make sure the Microfibre Pad is used and covers the floorhead entirely before using the Carpet Glider. Only use the Carpet Glider when refreshing carpets, not for hard floors.

Using your machine



Using the machine as a handheld

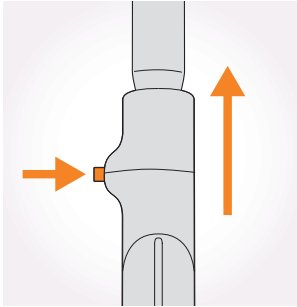

Push handle release button and lift handle to remove. The collar should be gripped with one hand when releasing the handle with the other hand.

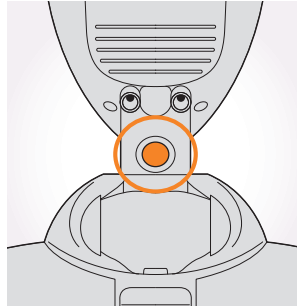

Press accessory release button and lift steamer to release floorhead.

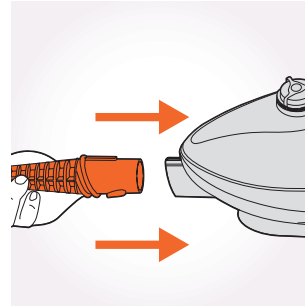

Push Concentration Nozzle into steamer until it clicks into place.



Plug into mains, turn the dial to 'on' position. The red light will illuminate to indicate power on.

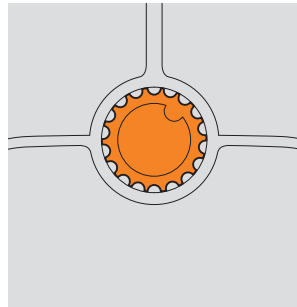

Twist the steam control dial to desired setting.

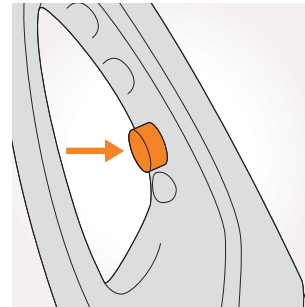

To produce steam squeeze the trigger in short bursts. Don't hold the trigger continuously to prevent over wetting. Allow 30 seconds for steamer to warm up. No sound will be heard until trigger is pressed. No steam will be visible until after 30 seconds.

Taking care of your machine

Emptying the water tank

IMPORTANT: Don't use bleach or fabric softener when washing the Microfibre Pad. Always allow the steamer to fully cool down before removing the Microfibre Pad.

IMPORTANT: Never remove the water tank cap with the product upright as water could leak out—always remove the floorhead and handle and place on a flat surface before removing the water tank cap.

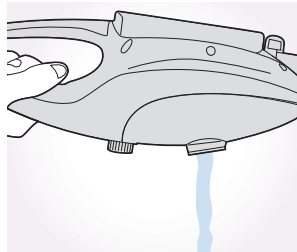
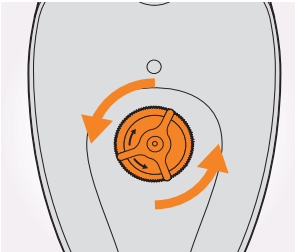

Unplug, remove floorhead and handle place steamer on flat surface. Twist water tank cap anticlockwise and lift to remove.

Cleaning the microfibre pad

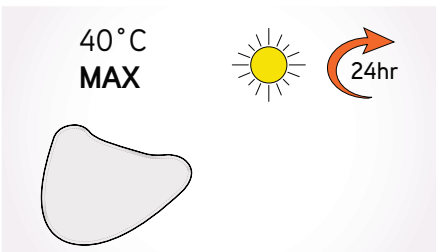

The Microfibre Pad is machine washable (Max 40°C) allow to fully dry again before use.

Taking care of your machine



Clearing blockages

IMPORTANT: Turn dial on steamer to 'OFF' position, switch off at mains and unplug safely. Allow to fully cool down before performing maintenance or troubleshooting checks.

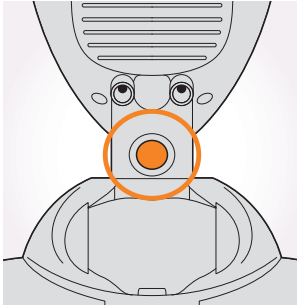

Push the accessory floorhead release button and lift the main body from the floorhead to remove. Also remove the handle.

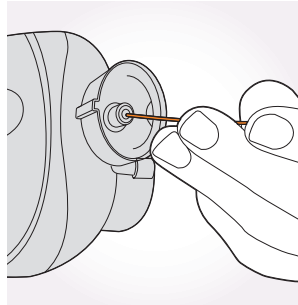

Use a small thin object such as a paperclip to insert into the nozzle and clear any blockage.

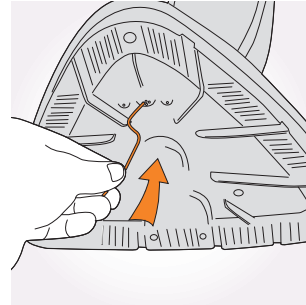

To clear a blockage in the floorhead, remove the Microfibre Pad from the floorhead, insert a small thin object, such as a paperclip, into the steam holes to remove any blockage.

What to do if it goes wrong

Problem

There is an accessory missing.

Solution

- Check the 'This pack contains' panel on the box to make sure the part is included with your steamer.
- If it is missing, we're here to help. Simply call us on
AUS: 1300 VAX AUS (1300 829 287)
NZ: 0800 VAX NZL (0800 829 695)

The steamer has no power

- Check the on/off control dial position.
- Check the amber light is illuminated.
- The plug may not be fully pushed into the electrical socket.
- Check the fuse in the plug if this needs replacing, always replace with a SAA 10amp fuse.

Why is the steamer not producing steam?

- There may be no water in water tank, check the water tank has water.
- Check the water tank cap is securely fitted onto the water tank.
- The water may not yet be at temperature. The steamer will take approximately 30 seconds to heat up.
- Steam path may be blocked. Go to 'Maintenance Section'.
- Check steam control dial has been turned to 'on'.
- Water tank level may be low, refill with water.
- If using as a stick mop - handle may not be fully inserted. Release handle, press handheld trigger to check steam is working. Re-insert handle until it clicks into place.

Why won't the Microfibre pad pick up dirt?

- The Microfibre Pad may already be saturated or dirty.

CAUTION: To reduce the risk of personal injury, unplug the product before performing maintenance/troubleshooting checks.

Getting in touch

Taking care of you

We're here if you need us. For trouble shooting, simply call or visit:

Australia: 1300 829 287*

vax.com.au

New Zealand: 0800 829 695*

vax.co.nz

*Monday-Friday 8.30am to 5.00pm

* Calls are charged at the standard local rate. Please make a note of the serial number and model number of the vacuum cleaner before calling.



Notes

Notes



vax

Distributed by

Techtronic Industries Australia Pty Ltd

31 Gilby Road, Mount Waverley, VIC 3149, Melbourne, Australia
Careline AU: 1300 VAX AUS (1300 829 287) www.vax.com.au

Techtronic Industries N.Z. Limited

2 Landing Drive, Mangere, Auckland, 2022, New Zealand
Careline NZ: 0800 VAX NZL (0800 829 695) www.vax.co.nz