



Performance is everything.™

2 year
warranty

Gator Car 12V

Let's get started



VX18

vax.com.au
vax.co.nz

Let's talk safety



Basic safety precautions

This handheld is intended for household use only and NOT for commercial or industrial use.

- This handheld is for indoor use only.
- For dry debris use, not to be used on wet surfaces.
- Keep fingers, hair and loose clothing from moving parts and openings whilst using the handheld.
- Only Vax recommend charger, tools and accessories should be used with this handheld.

- This appliance is not intended for use by persons (including children) with reduced physical, sensory or mental capabilities, or lack of experience and knowledge, unless they have been given supervision or instruction concerning use of the appliance by person responsible for their safety. Children should be supervised to ensure that they do not play with the appliance.

Please keep instructions for further use.



Don'ts

- ✗ Don't charge the handheld outdoors
- ✗ Don't use this handheld if it has been dropped, damaged, immersed in water or left outdoors.
- ✗ Don't run over the charger cord or use handheld if the charger cord or plug is damaged. Please contact AU: 1300 361 505 / NZ: 0800 800 900
- ✗ Don't handle the plug or use the handheld with wet hands.
- ✗ Don't throw the handheld into fire or expose to high temperatures, as the handheld contains a rechargeable nickel cadmium battery which may cause damage or burst.
- ✗ Don't vacuum flammable or combustible materials (lighter fluid, petrol, kerosene, etc) or use in the presence of explosive liquids or vapours.
- ✗ Don't vacuum harmful or toxic material (chlorine, bleach, ammonia, drain cleaner etc.)
- ✗ Don't pull or carry this handheld by the charger cord. Don't use the charger cord as a handle, pull the charger cord around corners or sharp edges or close a door over the charger cord. Don't unplug handheld by pulling on the charger cord.
- ✗ Don't attempt to remove blockages with sharp objects as this may cause damage to your handheld.
- ✗ Don't use the handheld charger with incorrect voltage as this may result in damage or injury to the user. The correct voltage is listed on the rating label.
- ✗ Don't vacuum up hot coals, cigarette butts, matches or smoking hot burning items or use in an area where there may be harmful fluids (chlorine, bleach, and ammonia drain cleaner).



Do's

- ✓ Always make sure filter and dirt container are fitted correctly before using your handheld.
- ✓ Always turn off the Gator handheld vacuum and disconnect the charger before carrying out any maintenance.
- ✓ Turn off all controls on the handheld before disconnecting or connecting the charger.
- ✓ Take extra care when cleaning on the stairs.
- ✓ Always protect the charger cable from heated surfaces or near open flames.
- ✓ Use only SAA approved 10amp extension cords, non-approved extension cords may overheat. Care should be taken to arrange the extension cord as it can be a trip hazard.
- ✓ Always carry the handheld by the handle.
- ✓ Store your handheld in a cool, dry area.

Please keep instructions for further use.

Thank you for buying this Gator.

Taking care of small cleaning tasks

The Gator Car 12V hand vac is designed to make cleaning as quick and convenient as possible and this user guide will help you get the most out of your machine.

The Gator Car 12V hand vac range is perfect for small cleaning tasks on surfaces and upholstery.

Taking care of your Gator

Also inside this guide are instructions on maintaining your new machine, so that it's always ready when you need to tackle those small jobs.

Taking care of you

We're here if you need us. For trouble shooting, simply call or visit:

Australia: 1300 361 505

vax.com.au

New Zealand: 0800 800 900

vax.co.nz



Monday-Friday 8.30am to 5.00pm

Calls are charged at the standard local rate. Please make a note of the serial number and model number of the product before calling.



Performance is everything.™

Contents

-  Let's talk safety
-  Getting to know your machine
-  Getting started
-  Using your machine
-  Taking care of your machine
-  Let's talk technical
-  What to do if it goes wrong
-  Getting in touch

Gator Car

Included with your machine

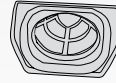

Filter
(located inside the hand vac)



Charger



Car adapter
(for use in the car or anywhere with a 12V power socket)

Getting to know your machine

Charging indicator
(red LED)

Filter
release button

Dirt container
release button

Retractable
crevice tool

Dirt container
release button



On/off switch

Handle

Car adapter socket

Charger socket



Technical Specification

Name	Gator Car
Voltage	12V
Weight	1.4kg
Capacity	0.3L
Cleaning Time	14 mins
Charging Time	12 hrs

Charger Specification

Model no.	HK-AC-190A015-AU
Input Voltage	100-240V ~ 50Hz

Getting started

PLEASE READ 'LET'S TALK SAFETY' AT THE BEGINNING BEFORE USE

CAUTION: For use picking up dry debris. Do not use on wet surfaces

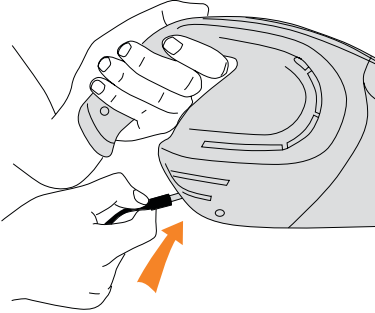

Plug charger into the mains and insert lead into back of machine. Initial charging time is 24 hours.

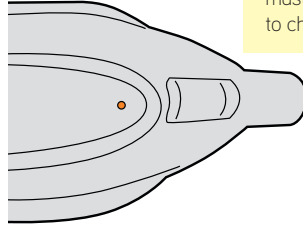

NOTE: The power switch must be in the off position to charge the battery.

The charging light will illuminate continuously whilst the charger is connected.

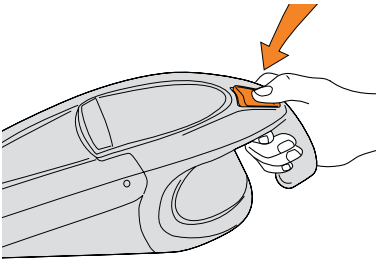

On/off switch: 0 Off
I On

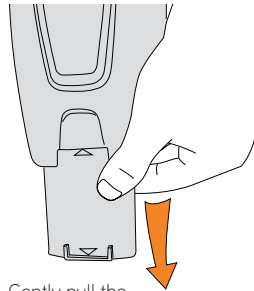

Gently pull the crevice tool.

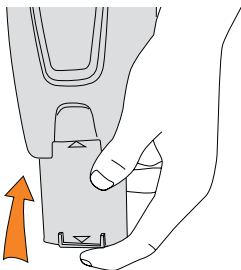

Push the crevice tool to retract.



WARNING

Failure to initially charge the battery for 24 hours, may result in poor battery performance.

Using your machine

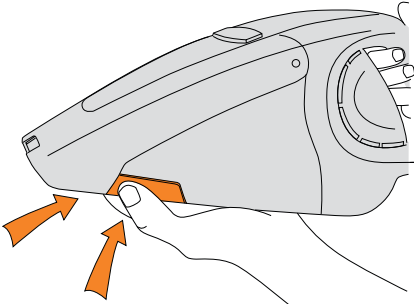

To empty the dirt container, press both buttons either side of the dirt container to release lid.

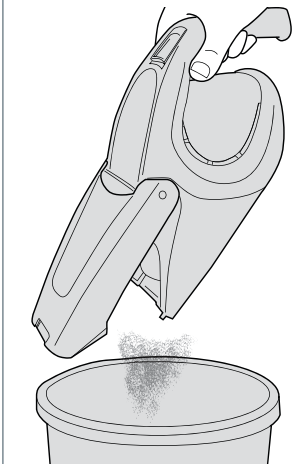
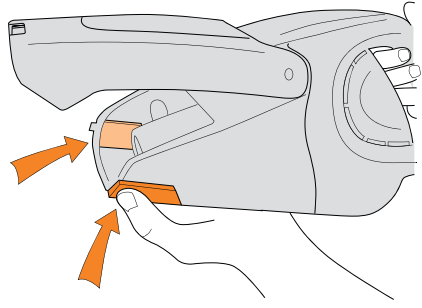

Empty dirt and debris over a bin.

We recommend to empty the dirt container after each use.



NOTE: Use the hand vac with car adapter for use in the car or anywhere with a 12V power socket. This will extend the runtime.

Taking care of your machine

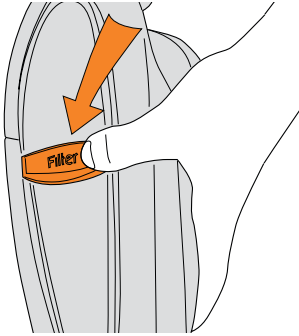

Press the filter removal button and pull dirt container from machine.



Whilst holding the dirt container over a bin, grasp the filter gently and pull out.



Shake any excess dirt or debris from the dirt container.

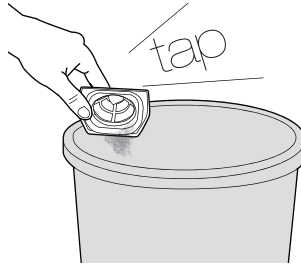

Tap filter against bin.

40°C max

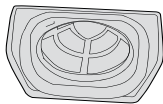

Wash the filter under running water and leave to fully dry for a least 24 hours before placing it back in the hand vac.

 **WARNING**

Do not use the hand vac with a clogged filter and without the filter in place.



Taking care of your machine

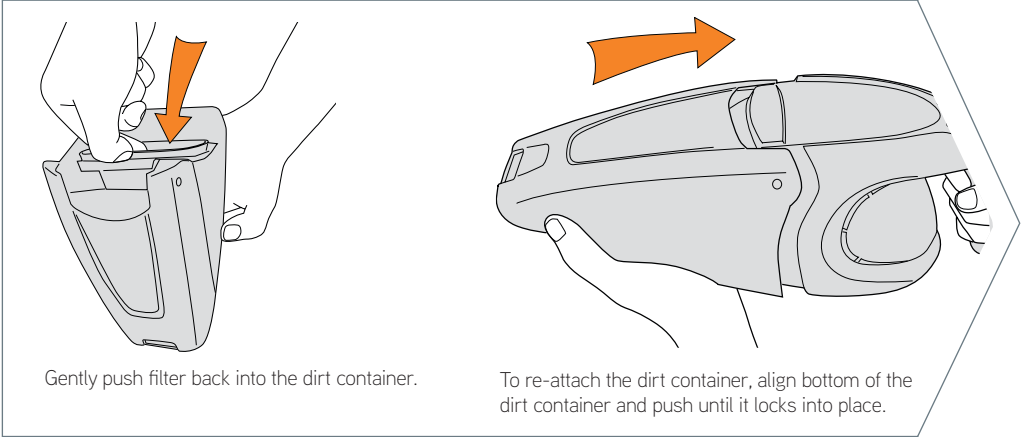

NOTE: Discoloured or damaged filters need to be replaced.

For replacement filters call AU: 1300 361 505 / NZ: 0800 800 900 or visit vax.com.au / vax.co.nz

BATTERY MAINTENANCE

- Never short-circuit the battery, i.e. never touch both poles simultaneously, especially with metal objects.
- Never dismantle the battery.
- Never expose the battery to high temperatures.
- Improper handling can lead to liquid leaking from the battery. This can cause skin irritations. Avoid any contact with the fluid.
- Do not replace the battery with a battery of a different type.
- If it becomes necessary to replace the battery, contact the Vax Careline on AU: 1300 361 505 / NZ: 0800 800 900 to determine the location of your nearest authorised service agent.



What to do if it goes wrong

Problem

Why does my handheld have no power?

Solution

- Battery may not be fully charged. If using the hand vac for the first time the initial charge should be 24 hours. The charging light will illuminate continuously when charger is connected.
-

Why won't the handheld pick up?

- The nozzle or crevice tool may be blocked, check and clear any blockage.
 - The filter may be clogged, clean the filter. Go to 'Taking care of your machine'.
 - The dirt container may be full, empty the dirt container. Go to 'Using your machine'.
 - The battery is getting weak, let the battery run until it stops and recharge.
-

Why won't the battery recharge?

- The charger may not be inserted correctly.

Taking care of you

We're here if you need us. For trouble shooting, simply call or visit:

Australia: 1300 361 505*

vax.com.au

New Zealand: 0800 800 900*

vax.co.nz

*Monday-Friday 8.30am to 5.00pm



Performance is everything.™

Distributed by Techtronic Industries Australia Pty. Ltd.
31 Gilby Road, Mt Waverley, VIC 3149 Australia.
Careline AU: 1300 361 505 www.vax.com.au
Careline NZ: 0800 800 900 www.vax.co.nz