

## REPLACING A ROTOR

- Place the sweeper upside down on a firm, even surface. The vinyl rotor is positioned in the middle of the sweeper.
- Each end of the rotor has an end cap with a knob sticking out at the end. The sweeper body has a plastic tab with a metal grommet on each side. The end caps mount inside these grommets.
- Pull one of the tabs out, while pushing the rotor in the opposite direction.
- The knob will come out of the grommet and you can remove the rotor.
- To install a new rotor, simply place the knob of one side of the rotor in one of the grommets. Push the opposite tab out and lower the second wheel knob into the grommet of the pushed out tab. Release the tab and the rotor will snap into place.
- For replacement vinyl rotors, please call the Vax Careline or visit:  
AU: 1300 361 505 [www.vax.com.au](http://www.vax.com.au) / NZ: 0800 800 900 [www.vax.co.nz](http://www.vax.co.nz)

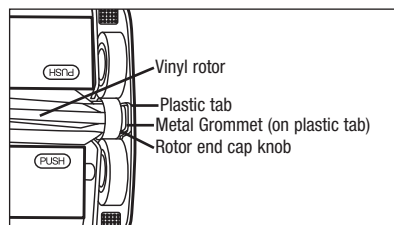

## CLEANING AND CARE

- The sweeper can not be cleaned with water or in a dishwasher.
- To empty the sweeper, turn it over and press the 'PUSH' markings on the dust containers to release the covers (see image Fig. 1).
- Shake out the dirt and push the covers back into place.
- Wipe the vinyl rotor clean before storage. If the vinyl rotor becomes very soiled, remove and wash with a mild cleaning solution and warm water. Let the rotor dry before reinserting it.
- Do not use any abrasive cleaning agents or brushes for cleaning. These can damage the sweeper.
- Store the sweeper in a dry and clean place with the comb tool clipped onto the bottom of the handle and the bracket of the sweeper.

### we're here to help

For troubleshooting please call or visit our website:

**AU: 1300 361 505**  
**[vax.com.au](http://vax.com.au)**

**NZ: 0800 800 900**  
**[vax.co.nz](http://vax.co.nz)**

This does not affect your statutory rights.



## WORKHORSE USER GUIDE

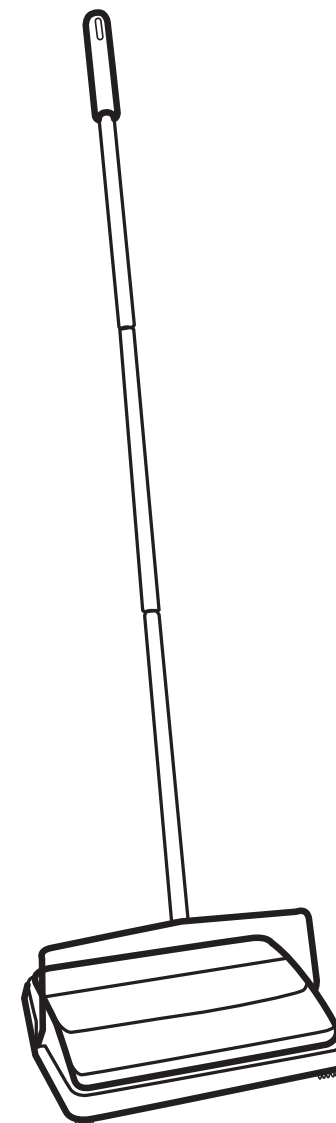

- Please read these instructions carefully before using your product.
- Let us help you put your product together, order parts and accessories or answer any questions.
- Please Do Not Return This Product To The Store.

 **WARNING:** Product assembly may include small parts. Small parts can present a choking hazard.

VX9

Performance is everything.™

# IMPORTANT SAFETY INSTRUCTIONS

**IMPORTANT: READ CAREFULLY BEFORE ASSEMBLY AND USE.**  
**THIS PRODUCT IS INTENDED FOR HOUSEHOLD USE ONLY. IF USED COMMERCIALY WARRANTY IS VOID.**  
**IMPORTANT SAFETY INSTRUCTIONS**  
**READ ALL INSTRUCTIONS BEFORE USING THE APPLIANCE.**  
**ALWAYS FOLLOW THESE SAFETY INSTRUCTIONS.**

- Fully assemble before operating.
- Do not use outdoors or on wet surfaces.
- Do not allow to be used as a toy. Not intended for use by children age 12 and under. Close supervision is necessary when used near children. To avoid injury or damage, keep children away from product, and do not allow children to place fingers or other objects into any openings.
- Use only as described in this manual. Use only manufacturer's recommended attachments and products.
- Keep hair, loose clothing, fingers, and all parts of body away from openings and moving parts.
- Use extra care when cleaning on stairs. Do not place cleaner on stairs or furniture, as it may result in injury or damage.
- Do not use to pick up flammable or combustible liquids, such as petrol, or fine wood sandings or use in areas where they may be present.
- Do not pick up anything that is burning or smoking, such as cigarettes, matches, or hot ashes.
- Do not use without vinyl rotor in place.

**CAUTION: TO REDUCE THE RISK OF DAMAGE:**

- Avoid picking up hard, sharp objects with this product, as they may cause damage.
- Store appropriately indoors in a dry place. Do not expose machine to freezing temperatures.

**SAVE THESE INSTRUCTIONS**

# FEATURES

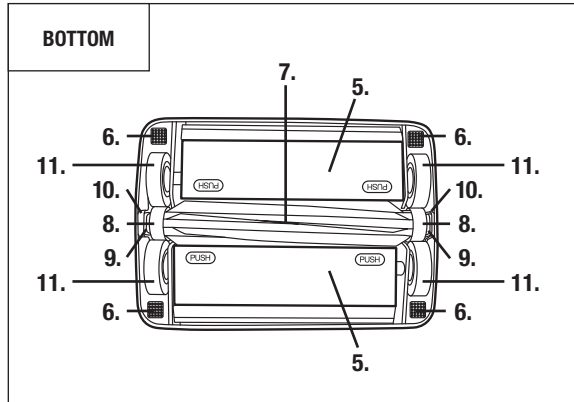
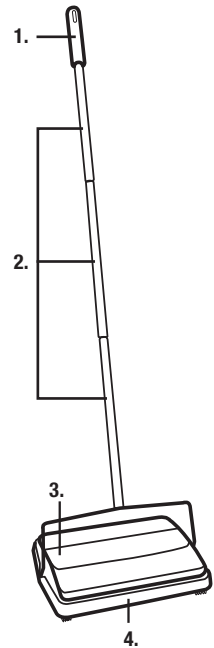

- |                              |   |
|------------------------------|---|
| 1. Handle Grip               | 7. Vinyl Rotor                          |
| 2. Handle Sub-Sections       | 8. Rotor End Caps (2)                   |
| 3. Base                      | 9. Rotor End Cap Knobs (2)              |
| 4. Bumper                    | 10. Plastic Tabs With Metal Grommet (2) |
| 5. Dirt Trays (2)            | 11. Wheels (4)                          |
| 6. Edge Cleaning Brushes (4) |   |

# HOW TO ASSEMBLE

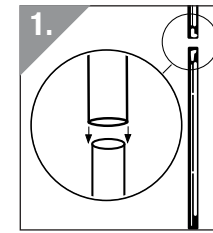

**HANDLE ASSEMBLY**  
 No tools needed.  
 Screw handle grip and three (3) sub-sections together to form the handle. Connect base and handle by screwing handle onto pivot (2).

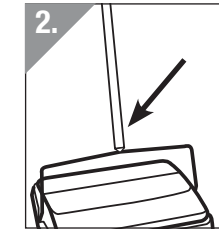

# HOW TO OPERATE

Hold the sweeper with a firm grip.  
 Push sweeper in forward and backward motion to remove dirt on many floor surfaces. NOTE: Empty dirt trays when surface dirt becomes difficult to remove.

# DIRT REMOVAL

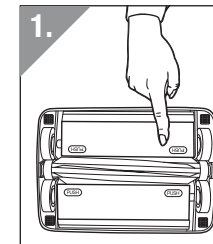

1. Turn sweeper upside down. Press (push inwards) on both trays to open (Fig. 1).
2. Empty each dirt tray over rubbish bin (Fig. 2).

# STORAGE

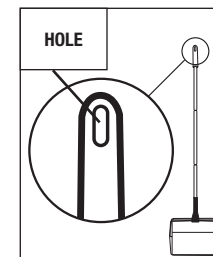

The sweeper folds flat against the wall when hung from the hole in the handle grip.