



Performance is everything.™

# Grime Pro

## User Guide



Vax Careline: (AU) 1300 361 505  
(NZ) 0800 800 900



# Machine Overview

- 1 Water tank
- 2 Steam nozzle
- 3 Detergent/ Solution control dial
- 4 Safety pressure indicator
- 5 Water tank lid
- 6 Steam trigger
- 7 Carry handle
- 8 Detergent tank
- 9 Power button
- 10 Power indicator light (water heating)  
(blue LED)
- 11 Steam ready indicator light (green LED)
- 12 Measuring jug
- 13 Window/upholstery tool
- 14 Upholstery tool cloth
- 15 Concentration nozzle
- 16 Small plastic brush
- 17 Large plastic brush
- 18 Scraper tool
- 19 Bending nozzle
- 20 Gap brush with bristles/ Grout brush
- 21 Accessory Adapter
- 22 Hose
- 23 1 x 4 Finger fork
- 24 1 x 4 Finger fork cloth
- 25 1 x 2 Finger fork
- 26 1 x 2 Finger fork cloth
- 27 Vax Steam detergent
- 28 Accessory bag

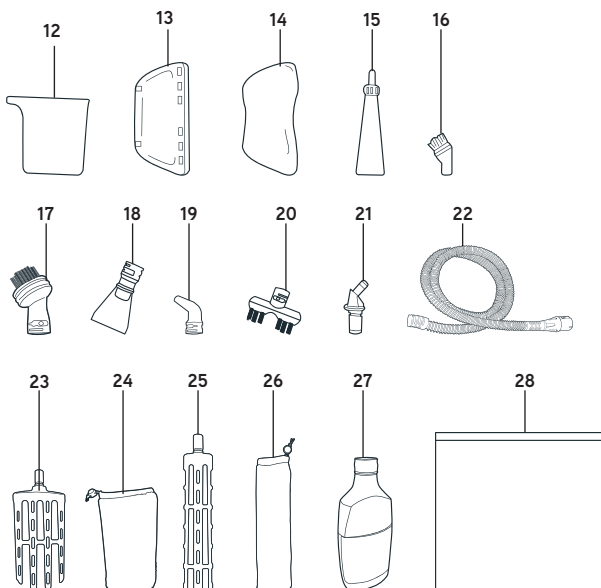

# General Safety Information

## FOR HOUSEHOLD USE ONLY.

When using the steam cleaner, basic safety precautions should always be observed, including the following:

**IMPORTANT:** Please refer to floor manufacturer's care recommendations before use and test the steam cleaner on a discrete area of flooring to begin with.

When using the steam cleaner, basic safety precautions should always be observed, including the following:

**WARNING:** The stick steam cleaner head gets very hot during operation.

**WARNING:**  Danger of scalding

1. Do not leave the steam cleaner unattended when plugged in. Unplug the product from the socket when not in use.
2. Only use the steam cleaner indoors. Keep the steam cleaner away from rain and moisture.
3. Turn off the on/off switch on the steam cleaner controls before disconnecting or connecting from the mains supply.
4. Always unplug the steam cleaner and allow it to cool before connecting or disconnecting the hose or accessories.
5. Children should be supervised to ensure that they do not play with the appliance.
6. This appliance is not intended for use by children and persons with reduced physical, sensory or mental capabilities or lack of experience and knowledge, unless they have been given supervision or instruction concerning use of the appliance by a person responsible for their safety.
7. The appliance should only be used as described in this User Guide.
8. Only Vax recommended attachments should be used with this appliance.
9. Do not use this steam cleaner if it has been dropped, damaged, left outdoors or dropped into water. Do not use this steam cleaner with a damaged cord or plug. If the supply cord is damaged return the steam cleaner to a Vax authorised Service Agent.
10. Do not pull or carry this appliance by the cord. Do not use the cord as a handle, close a door on the cord or pull the cord around sharp edges or corners. Do not run the steam cleaner over the cord. Keep the cord away from heated surfaces.
11. Do not unplug the product by pulling on the cord.
12. Do not handle the plug or the steam cleaner with wet hands.
13. Do not use without the tank cap in place. Ensure that the water tank cap has been screwed down fully before use.
14. Do not touch any hot areas on the steam cleaner. It is normal for the steam cleaner to heat up during operation.
15. Accessories will become hot during use – allow them to cool down before handling.
16. Do not use the steam cleaner to treat any items of clothing that are still being worn on the body.
17. The force and heat of the steam may have an adverse effect on some materials. Always check whether a surface is suitable for treatment with the steam by carrying out a test before hand on a concealed area.
18. The steam cleaner must be kept level during operation.
19. Never immerse the steam cleaner in water or in other liquids.
20. Do not operate the steam cleaner without water in the tank. Always top up with water in good time.
21. Always remove the mains plug from the socket and allow the steam cleaner to cool down completely before topping up with water.
22. Never aim the steam cleaner at people, animals or plants (there is a risk of scalding). Never touch the steam jet from a short distance with your hands. Do not aim the steam cleaner at electrical items or wires.
23. Keep hair, loose clothing, fingers and all parts of the body away from openings.
24. Never fill the water tank with anything other than water. Never put additives (such as perfume, stain remover or products containing alcohol) in the water as they may damage the steam cleaner or make it dangerous to use.
25. Only carry the steam cleaner by the carry handle.
26. Store the steam cleaner in a cool, dry area.
27. Do not use an extension cord with this product.
28. Using improper voltage may result in damage to the steam cleaner and possible injury to the user. The correct voltage is listed on the rating label.
29. Do not use your steam cleaner if it is damaged or faulty. Please make sure that the product is unplugged from the mains and call the Vax Careline on AU 1300 361 505 / NZ 0800 800 900.
30. Do not use the unit on leather, wax polished furniture or floors, synthetic fabrics, velvet or other delicate steam or water sensitive materials.
31. Do not use on acrylic surfaces.
32. In wet rooms, e.g. bathrooms, connect the appliance to sockets with an RCD adaptor connected in series.
33. The device should not be used to clean electrical appliances such as ovens, microwaves, televisions and electrical heating systems etc.

# General Safety Information

34. Be very careful when cleaning tiled walls with sockets.
35. Keep the unit on the floor.
36. Empty the water tank when the steam cleaner is not in use.
37. Do not overfill the tank. Do not exceed the maximum prescribed filling level. Please use the measuring jug and funnel included.
38. Always show these instructions to a third party if you are passing the steam cleaner on to them.
39. Please ensure all parts are correctly fitted before using the product.
40. Do not attempt to remove blockages with sharp objects as they may cause damage.
41. Do not use without the hard water filter in place.
42. Take extra care when cleaning on the stairs.
43. Keep cleaning area well lit.
44. Please refer to the manufacturers care recommendations before use and test the steam cleaner on a discrete area of flooring to begin with.

 **WARNING:** The water tank lid must not be opened during use.

 **WARNING:** Always switch off and unplug the steam cleaner from the electrical outlet before assembling, maintenance, opening or emptying the water tank, or before connecting/disconnecting the attachments.

 **IMPORTANT:** The liquid or steam must not be directed towards equipment containing electrical components, such as the interior of ovens.

 **IMPORTANT:** The steam cleaner is equipped with a thermostat and a thermal cut-out. If for any reason the unit should overheat, the thermostat will automatically turn the unit off. Should this occur, unplug the steam cleaner from the electrical outlet and turn off the switch. Let the unit cool, remove and empty the water tank. To re-start the machine, plug it into an electrical outlet and switch it back on.

 **IMPORTANT:** We recommend the use of a Residual Current Device with a Residual Current rating of 30mA or less.

 **WARNING:** Never leave the steam cleaner in one spot on any surface for an extended period of time as this may damage the floor surface.

 **IMPORTANT:** This steam cleaner may not be suitable for all floating floorboards or sealed floors – please check with your floorboard manufacturer first prior to use.

**This machine is intended for household use only, and NOT for commercial or industrial use.**

**PLEASE KEEP THESE INSTRUCTIONS FOR FURTHER USE.**

# Getting Started

## Operating your steam cleaner

**NOTE:** Whilst in use do not recline unit more than 45 degrees.

**CAUTION:** Do not use hot or boiling water to fill water compartment. Do not open the water tank lid when using the steamer. Your steamer is pressurised, do not completely remove the lid when tank is hot. Fill tank only when cool. Do not overfill the water or detergent tank compartments.

**IMPORTANT:** After use, switch off the machine, compress the trigger to release all remaining steam. Allow machine to cool for a minimum of 10 minutes before refilling or storing.

## Filling the water tank

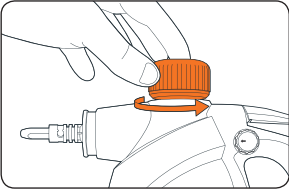

Place steamer on a level surface and ensure steamer is switched off and is cool. To remove lid push down and twist anti clockwise.

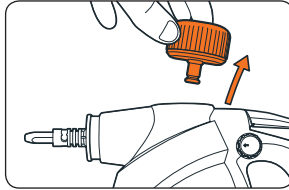

Fill measuring jug with maximum 300ml.

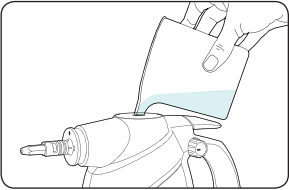

Slowly pour water into water tank. Do not overfill the water tank. Allow space to be left at the top.

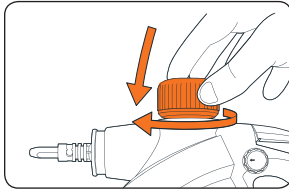

Ensure the lid is securely fastened by turning in a clockwise direction.

## Filling the detergent tank

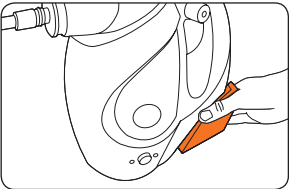

Squeeze tabs on side of detergent tank to slide tank out of steamer.

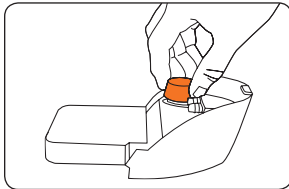

Remove cap from detergent tank and fill with maximum 120ml of Vax detergent. Replace cap firmly and slide solution tank back into steamer  
**NOTE:** For best results, fill with 120ml of detergent. Alternatively dilute the mixture with 50ml detergent and 70ml water

# How To Use

## Operating your steamer

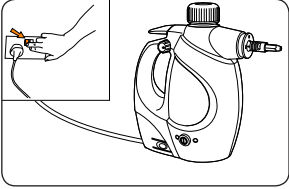

Plug in steamer and switch on at the mains.

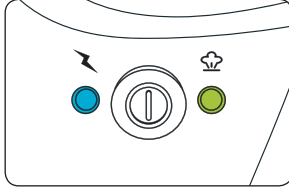

After you plug in and switch on your machine you will see a blue LED which indicates water is being heated. After 5 minutes a green LED will indicate that your steamer is ready to use.

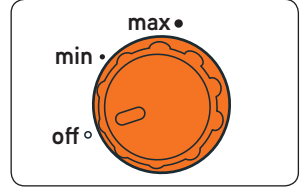

If you wish to clean with steam alone (no solution), simply turn the Detergent Control Dial to OFF.

If you wish to clean using Vax Solution, simply turn the Detergent Control Dial to the desired setting. When pressing the Steam Trigger, the steam cleaner will release the amount of solution that is indicated on the Detergent Control Dial as well as steam.

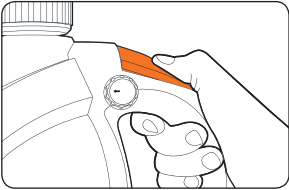

Depress the trigger to release steam/steam+detergent from the nozzle.

# How To Use

## Accessories

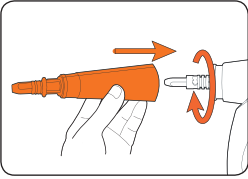

### Attaching small tools

Small tools can be attached via connector when required. Twist to connect.

### Attaching larger tools

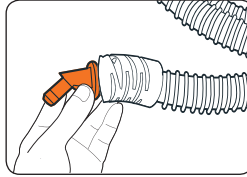
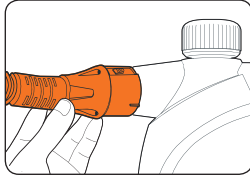
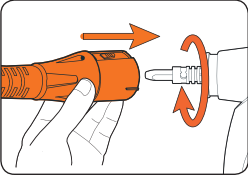

Attach accessory adapter to the hose so that small tools can be used with the hose.

Larger accessories can be attached using the hose. The hose should be rotated clockwise until locked into position and secure. To remove hose, turn anti-clockwise.

### Using the tools

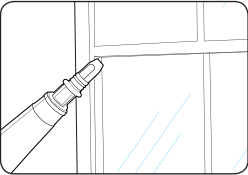

#### Concentration nozzle

Use to remove soap scum in baths and shower enclosures and to clean heavily soiled areas in kitchens.

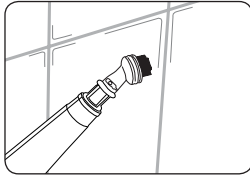

#### Brush

Ideal for any surface from tiles, sinks, toilets and oven tops.

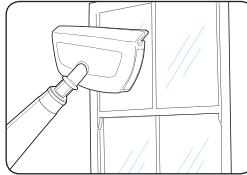

#### Squeegee tool

Great for leaving your windows, tiles and mirrors gleaming.

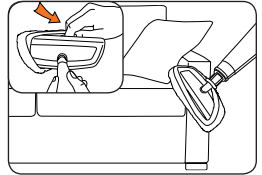

#### Upholstery/clothes tool

Attach the cloth to the squeegee tool for use on upholstery and cloths.

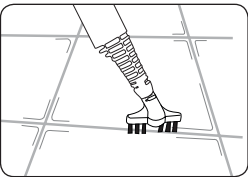

#### Grout brush

Lifts embedded dirt from inbetween tiles.

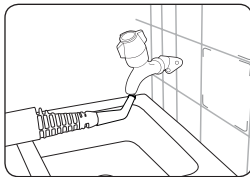

#### Bending nozzle

For hard to reach areas e.g. around taps.

**IMPORTANT:** Test for colour fastness in a small hidden area of upholstery/fabric to check for colour removal before use.

**IMPORTANT:** Taps should be turned off when steaming around them. Do not steam clean ovens, oven surfaces or grills when hot. Allow to cool to room temperature



# Looking After Your Machine

## Refilling and Storing

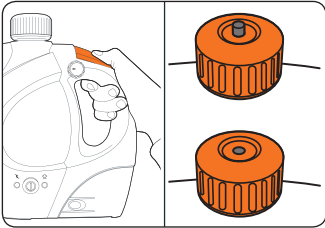

After using your steamer, press the Power Button to turn power "OFF" and then unplug the power cord from the mains. Release excess pressure by depressing the trigger and releasing steam before opening the water cap. This can be ensured when the pressure indicator is completely depressed in the cap.

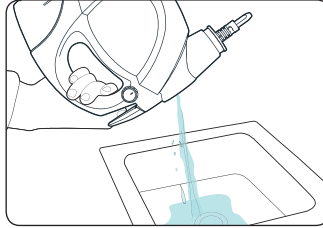

After allowing steamer to cool for a minimum of 10 minutes, slowly start to unscrew the lid anti-clockwise while gently pushing on the trigger. **DO NOT FULLY UNSCREW THE WATER FILL SAFETY CAP.** Allow steam cleaner to cool an additional 5 minutes. After you have ensured the steam cleaner has cooled and pressure has been released, the lid should turn freely for removal. Unscrew the lid completely. Empty the residual water in the tank and allow to dry. Clean the external surface with a dry cloth.

## Cleaning cloths

**IMPORTANT:** Never use bleach or fabric softener when washing the cloths.

- 1 Wash by hand or machine washable at 'warm' temperature. Always use a mild detergent.
- 2 Allow cloths to completely dry before next use.

## Cleaning your steamer

**IMPORTANT:** Always ensure before cleaning or maintaining the steam cleaner that it is switched off, unplugged from the mains and cooled down to room temperature. Only clean the steam cleaner by wiping over the housing with a slightly moistened cloth. Do not use any cleaning agents, abrasives or alcohol since they may damage the housing. Vax recommend that the tank be rinsed out after 5 filling operations at the latest if water hardness is above 1.8 mmol/l (100d/H). Information regarding local water hardness may be obtained from the water or utility company. Vax recommend filling the water tank with water and giving it a good shake to clean it. This will loosen any limescale that has been deposited on the bottom of the steam cleaner. Pour out the water and allow the tank to dry out completely before closing it. The water tank should be treated with limescale remover approx. every 6 months to prolong the steam cleaner's life. Place one (or at most two) limescale removal sticks in 0.3 litre of warm water (50oC) and fill the water tank with it. Allow the solution to work for approx. 30 minutes then pour away the water with the dissolved solids. Repeat this process if necessary then rinse out the tank with water.

**WARNING:** to reduce the risk of personal injury, unplug the steamer and ensure unit has fully cooled down before performing maintenance/troubleshooting checks.

## Is there an accessory missing?

- Check the parts overview page in this guide to make sure the part is definitely included with your machine.
- If the part is missing, we're here to help. Simply call us on: **AU: 1300 361 505 / NZ: 0800 800 900**

## What do I do if the machine/an accessory has become damaged or broken?

- Visit [vax.com.au](http://vax.com.au) for spares and parts.
- Please call our Careline to purchase new spares or order a replacement.

## What to do if the steam cleaner has no power?

- The unit may not be plugged into an electrical outlet; ensure the plug is pushed in securely.
- Check the mains power is switched on.
- The electrical outlet may not be working; check the fuse or breaker and consult an electrician.
- The power cord may be damaged; if it is it must be replaced by the manufacturer.

## Why is the steam cleaner not producing steam?

- Check the mains power is switched on.
- There may be no water in the tank; please refer to the operation section.
- Check that the safety latch has been unlocked on the steam handle.
- Check that the unit has not been overfilled as there must be space in the tank for the water to heat. If overfilled the unit will deliver little steam or water droplets.
- The water may not yet be at temperature; the green and red steam ready indicator light will both be illuminated when the water is at temperature and is ready to use.
- If the unit is producing a very small amount of steam, check the variable steam power dial and adjust to max.
- If none of the points above are of assistance, we're here to help. Simply call us on: **AU: 1300 361 505 / NZ: 0800 800 900**
- When the unit has been switched off and fully cooled remove the water tank lid. If limescale build up can be

seen inside the tank the unit will need to be descaled.

## What do I do if the steam cleaner takes a long time to heat up?

- When the unit has been switched off and fully cooled remove the water tank lid. If limescale build up can be seen inside the tank the unit will need to be descaled.
- Otherwise, we're here to help. Simply call us on: **AU: 1300 361 505 / NZ: 0800 800 900**

## we're here to help

For troubleshooting please call or visit our website:

**AU: 1300 361 505**  
**vax.com.au**

**NZ: 0800 800 900**  
**vax.co.nz**

This does not affect your statutory rights

# Other Information

## Service & Help

Vax Careline:

(AU) 1300 361 505

(NZ) 0800 800 900

Monday-Friday 8.30am to 5.00pm

Any queries or concerns about using your Vax, call the Vax Careline. Calls are charged at the standard local rate. Please make a note of the serial number and model number of the steam cleaner before calling. For the nearest Service Agent, please call the Vax Careline or visit [vax.com.au](http://vax.com.au)

## Technical Specification

Wattage:	1200W
Voltage:	220 - 240V - 50Hz
Water tank capacity:	300ml
Detergent tank capacity:	120ml
Weight:	2.5kg
Cord length:	5m

Subject to technical change without notice.



**Performance is everything.™**

Distributed by Techtronic Industries Australia Pty. Ltd.  
31 Gilby Road, Mt Waverley, VIC 3149 Australia  
[www.vax.com.au](http://www.vax.com.au) Careline AU: 1300 361 505  
[www.vax.co.nz](http://www.vax.co.nz) Careline NZ: 0800 800 900