



Air³ Agile

User Guide

Vax Air³ Motion Agile



Contents

Contents	1
Machine Overview	2
General Safety Information	3
Getting Started	5
How To Use	6
Looking After Your Machine – Emptying & cleaning dirt container	7
Looking After Your Machine – Filters	8
Looking After Your Machine – Removing Blockages	9
FAQs	10
Other Information	11

Machine Overview

- 1 Handle
- 2 Handle release button
- 3 Dirt container release button
- 4 Carry handle
- 5 Power on/off button
- 6 Brushbar on/off button
- 7 Inner cyclones
- 8 Dirt container
- 9 Post-motor filter cover
- 10 Brushbar blockage indicator
- 11 Brushbar access clips
- 12 Rotating brushbar
- 13 Quick release cord wrap
- 14 Wheels
- 15 Brushbar reset button
- 16 Stretch hose
- 17 Telescopic extension tube
- 18 3-in-1 crevice tool, dusting brush and upholstery tool
- 19 Post-motor filter
- 20 Pre-motor filter

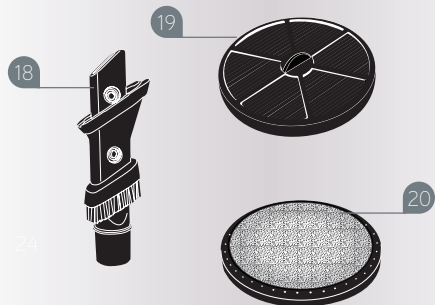
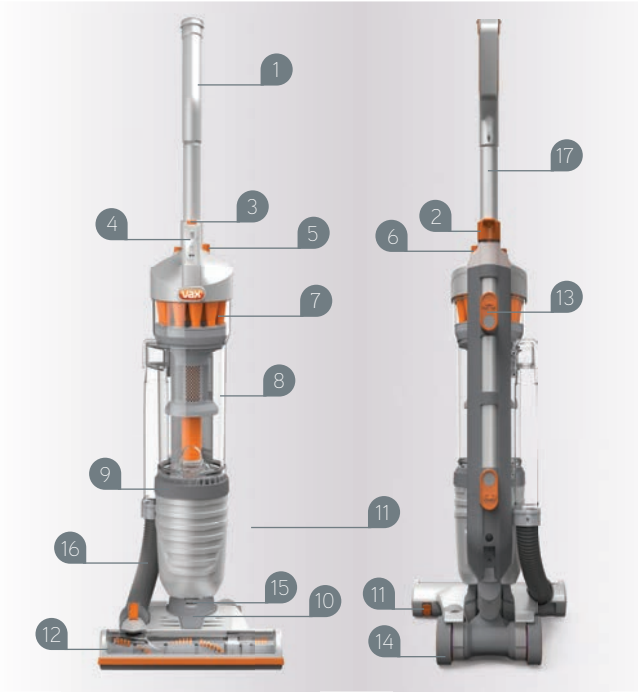

NOTE: Some parts may vary according to model. Please check inside flap of box for more details.

General Safety Information

This vacuum cleaner is intended for household use only and NOT for commercial or industrial use. Please keep instructions for further use.

When using the vacuum cleaner basic safety precautions should always be observed, including the following:

1. Only use the vacuum cleaner indoors on dry surfaces.
2. Turn off the on/off switch on the vacuum cleaner controls before disconnecting or connecting from the mains supply.
3. Always unplug the vacuum cleaner before connecting or disconnecting the vacuum hose and accessories.
4. Children should be supervised to ensure that they do not play with the appliance.
5. This appliance is not intended for use by children and persons with reduced physical, sensory or mental capabilities or lack of experience and knowledge, unless they have been given supervision or instruction concerning use of the appliance in a safe way and understands the hazards involved.
6. Cleaning and maintenance shall not be made by children.
7. The appliance should only be used as described in the quick start guide or in the full user guide.
8. Only Vax recommended attachments should be used with this appliance.
9. Do not use this vacuum cleaner if it has been dropped, damaged, left outdoors or dropped into water. Do not use this vacuum cleaner with a damaged cord or plug.
10. Do not pull or carry this appliance by the cord. Do not use the cord as a handle, close a door on the cord or pull the cord around sharp edges or corners. Do not run the vacuum cleaner over the cord. Keep the cord away from heated surfaces.
11. Do not handle the plug or the vacuum cleaner with wet hands.
12. Keep hair, loose clothing, fingers and all parts of the body away from openings and moving parts.
13. Do not pick up any hot coals, ash, cigarette butts, matches or any hot, smoking or burning objects.
14. Do not pick up any flammable or combustible materials (lighter fluid, petrol, kerosene etc.) or use in the presence of explosive liquids or vapours.
15. Do not vacuum harmful or toxic material (chlorine, bleach, ammonia, drain cleaner etc.).
16. Do not vacuum hard or sharp objects such as glass, nails, screws, coins etc.
17. Do not vacuum plaster dust, concrete dust or any other building or vitreous materials.
18. Do not vacuum baking soda or any other powder-based carpet refresher or deodoriser.
19. Store the vacuum cleaner in a cool, dry area.
20. Use only SAA approved 10amp extension cords. Non-approved cords may overheat. Care should be taken to arrange the cord so that the cord cannot be tripped over.
21. Do not put any objects into openings. Do not use with any openings blocked and do not restrict airflow. Keep all openings free of dust, lint, hair or anything that might reduce airflow.
22. Do not use the vacuum cleaner with blocked filters and without all of the filters in place.
23. Take extra care when positioning the vacuum cleaner on the stairs.
24. Please ensure that the brushbar is turned off when you are vacuuming on the stairs.
25. Keep vacuuming area well lit.

General Safety Information

- WARNING:** Always switch off and unplug the vacuum cleaner from the electrical socket before assembling, opening or emptying the dirt container, or before connecting/disconnecting the attachments.
- CAUTION:** The vacuum cleaner is a very powerful unit. Before plugging the cord into the electrical socket, make sure the switch is in the 'off' position.
- IMPORTANT:** If the inlet, hose or telescopic tube is blocked, switch off the vacuum cleaner and remove the blockage(s) before re-starting the vacuum cleaner.
- IMPORTANT:** Vax recommends the use of Residual Current Device Rating of 30mA or less.
- IMPORTANT:** It is very important that filters are kept clean to obtain maximum performance from your vacuum cleaner. Not cleaning and not replacing your filters regularly can reduce the suction power and cause overheating and permanent damage to the vacuum cleaner.
- NOTE:** If the supply cord is damaged it must be replaced by the manufacturer, or a similarly qualified person in order to avoid hazard, or invalidating the warranty.
- IMPORTANT:** The motor is equipped with a thermal cut-out. If for any reason the unit should overheat (eg. from blocked nozzles, a full dust container or unclean filters), the thermostat will automatically turn off the switch. Should this occur, unplug the vacuum cleaner from the electrical socket and turn off the switch. Remove dirt container and empty. Clean filters. Allow the unit to cool for approximately one (1) hour. To re-start, plug into an electrical socket and switch back on.

DAMAGE TO THE VACUUM CLEANER CAUSED AS A DIRECT RESULT OF NOT ADHERING TO THE GENERAL SAFETY INFORMATION AND THE INSTRUCTIONS IN THIS USER GUIDE INVALIDATES THE WARRANTY

This vacuum cleaner is intended for household use only and NOT for commercial or industrial use.

PLEASE KEEP THESE INSTRUCTIONS FOR FUTURE REFERENCE

Getting Started

PLEASE READ SAFETY INFORMATION BEFORE USE (p3)

Before plugging the cord into the electrical outlet, make sure the switch is in the 'off' position. Hold the vacuum cleaner firmly when starting and in use.

Assembling your upright

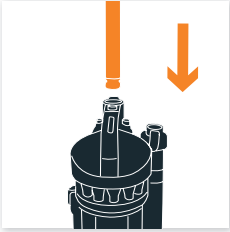

1. Remove all packaging
2. Insert the handle

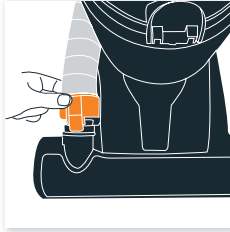

Attach the hose end to the floorhead ensuring it clicks into place.
(All accessories can be used by either attaching them to the handle or the hose).

How to use



Twist the cord holder to release the cord.

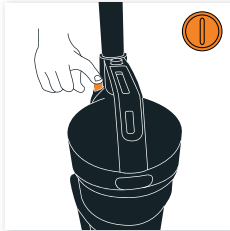

Plug in your machine and turn it on.

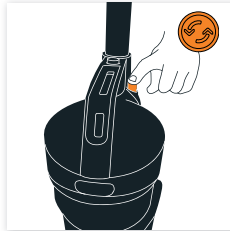

For brushbar position, press the brushbar on/off button at the top of the unit.
Brushbar on — carpets.
Brushbar off — hard floors.

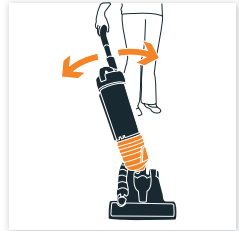

Recline the unit and twist the handle to manoeuvre under and around furniture.

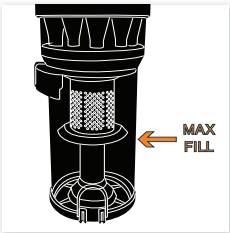

To avoid clogging your filters, do not fill the dirt container beyond the "Max Fill" mark.

Using accessories

NOTE: The 3-in-1 tool, TurboTool and other tools can be attached to the telescopic tube or directly to the hose.

NOTE: Switch off the brushbar before using any accessories/hose/telescopic extension tube.

Hose

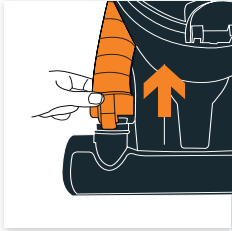

Remove hose.

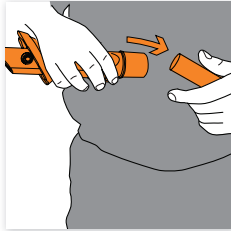

Attach tool to the hose

Telescopic extension tube

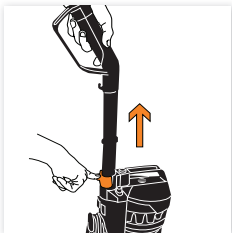

Remove telescopic extension tube.

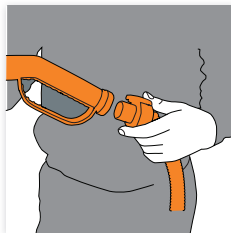

Attach hose to telescopic extension tube.

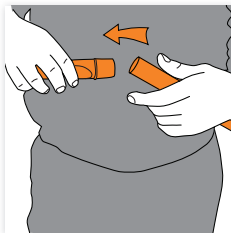

Attach accessory to telescopic extension tube.



IMPORTANT: Hold unit when using hose or telescopic extension tube for above floor cleaning.

Looking After Your Machine – Emptying & Cleaning Dirt Container

WARNING: Always switch off and unplug the vacuum cleaner from the electrical socket before assembling, opening or emptying the dirt container, or before connecting/disconnecting the attachments.

IMPORTANT: Filters need to be cleaned **every time you empty the dirt container for best cleaning results.** Do not use your vacuum cleaner without all of the filters in place.

IMPORTANT: The motor is equipped with a thermal cut-out. If for any reason the unit should overheat, the thermostat will automatically turn the unit off. Allow the unit to cool for approximately 1 hour to cool before switching it back on.

Emptying and cleaning the dirt container

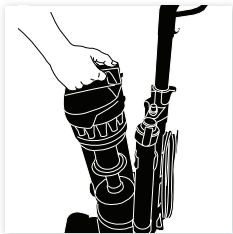

Press dirt container release button to remove the dirt container.



Hold dirt container over a bin and press dirt release button to open, allowing dirt to fall out.

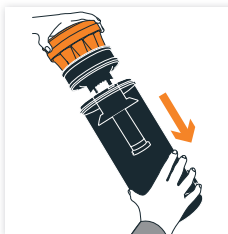

Looking After Your Machine – Filters

IMPORTANT: Even with regular cleaning, filters have a limited lifespan and will eventually need to be replaced during the lifetime of the vacuum cleaner. If the performance of your vacuum cleaner is compromised and/or the filters are severely discoloured, the filters may need to be replaced. As a general guide, Vax recommends filters are replaced every 3-6 months depending on the level of use to ensure optimum performance of your vacuum cleaner.

Cleaning the pre-motor filter

IMPORTANT: Water temperature should not exceed 40°C when washing pre-motor filter.

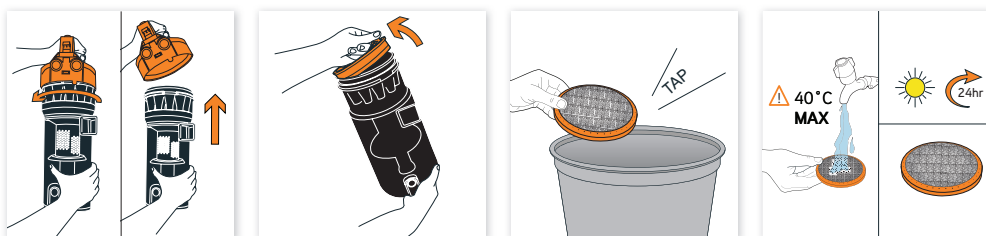

Turn the dirt container lid anti-clockwise to remove.

Cleaning the HEPA post-motor filter

WARNING: Do not wash the post motor filter.

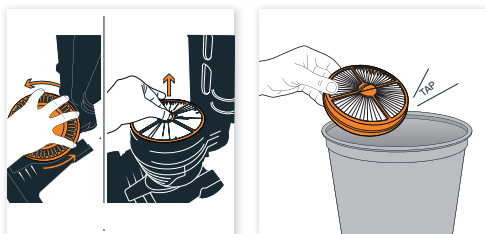

Remove the post-motor filter from the body of the vacuum cleaner.

Looking After Your Machine – Removing Blockages

IMPORTANT: If the air inlet, hose or telescopic tube is blocked, switch off the vacuum cleaner and remove the blockage(s) before re-starting the vacuum cleaner.

Re-setting the brushbar

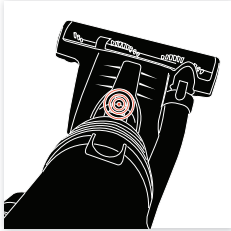

A **RED** flashing light will indicate a jammed brushbar.

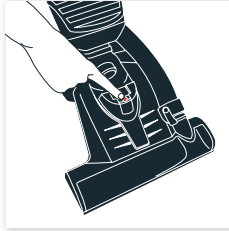

To reset press the **RED** button in the middle of the floorhead.

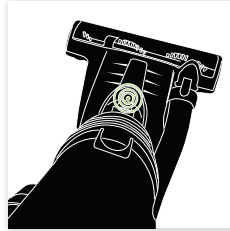

A **GREEN** flashing light indicates no blockages in the brushbar.

Removing debris from the brushbar

NOTE: Brushbar and belt are not removable

If the light continues to flash red after resetting, the brushbar may still be blocked. Using a pair of scissors, cut through any threads or hairs caught around the brushbar. To access brushbar:

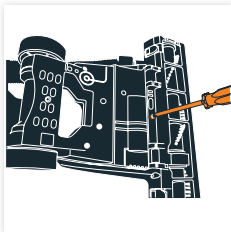

Place the vacuum cleaner on the floor upside down and remove the screw on the back of the brushbar cover.

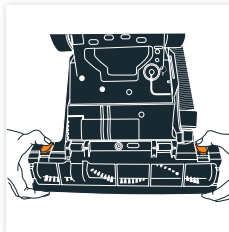

Unclip both clips on the brushbar cover.

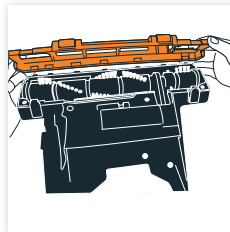

Remove the brushbar cover and remove any debris, hair and dirt from the brushbar and belt.



Press the brushbar reset button again to ensure the blockage is fully cleared.

Warning: To reduce the risk of personal injury, unplug the vacuum cleaner before performing maintenance/troubleshooting checks.

Is there an accessory missing?

- Check the 'Getting Started' page in this guide or the box that the machine came in to make sure that the part is definitely included in your unit.
- If it is missing, we're here to help. Simply call us on **AU: 1300 361 505 / NZ: 0800 800 900**

Why won't the vacuum cleaner pick up?

- The filters may need cleaning or replacing, please refer to the 'Looking After Your Machine – Filters' page of this user guide (p8)
- The separator may be clogged, please refer to the 'Looking After Your Machine – Filters' page of this user guide (p8)
- There may be a blockage in the hose, please check the hose and remove the blockage
- The dirt container may be full or blocked, please refer to the 'Looking After Your Machine – Emptying and Cleaning Dirt Container' page of this user guide (p7)
- The dirt container may be incorrectly installed, please ensure the dirt container is locked in place
- The brushbar may not be turning, please refer to the 'Looking After Your Machine – Removing Blockages' page in this user guide (p9)

Why won't the accessories pick up properly?

- The TurboTool may be blocked, please refer to the 'Looking After Your Machine – Removing Blockages' page in this user guide (p9)
- The accessory may be broken

What do I do if an accessory/the unit becomes damaged or broken?

- Please check if the damage is with the accessory or the unit. To do this, firstly remove the accessory from the unit and check if there is suction from the hose. If there is suction from the hose this confirms that the damage is with the accessory.
Please visit vax.com.au
- If having done the above checks, checked the hose for blockages and cleaned or replaced the filters there is still no suction/limited suction from the hose, please call our Vax Careline **AU: 1300 361 505 / NZ: 0800 800 900**

Why is dust escaping from the vacuum?

- The filters may not be installed correctly, please refer to the 'Looking After Your Machine – Filters' page of the user guide (p8)
- The dirt container may be full or blocked, please refer to the 'Looking After Your Machine – Emptying and cleaning dirt container' page of this user guide (p7)
- The filters may need cleaning or replacing, please refer to the 'Looking After Your Machine – Filters' page of this user guide (p8)
- There may be a blockage in the hose, please check the hose and remove the blockage

Why does my vacuum cleaner have no power?

- It may not be plugged into the electrical socket correctly. Ensure that the plug is pushed into the electrical socket securely
- The electrical socket may not be working. Check the fuse or breaker and consult an electrician
- The motor thermostat may have tripped. Switch off and unplug the vacuum cleaner. Check the unit for blockages, clean or replace the filters – please refer to the 'Looking After Your Machine – Filters' page of this user guide (p8) and clean the separator (please refer to the 'Looking After Your Machine – Emptying and cleaning dirt container' page of this user guide (p7). Leave the vacuum cleaner for 24 hours before switching the vacuum cleaner back on

Why isn't my brushbar rotating?

- The brushbar may not be turned on. Please refer to the 'Getting Started' page of this user guide (p5)
- The unit may not be reclined. Please refer to the 'Getting Started' page of this user guide (p5)
- The brushbar may be jammed. Please refer to the 'Looking After Your Machine – Removing Blockages' page of this user guide and remove any blockages (p9)
- The brushbar may need re-setting. Please refer to the 'Looking After Your Machine – Removing Blockages' page of this user guide (p9)

Why is there a red light on my floorhead?

- The brushbar may be jammed. Please refer to the 'Looking After Your Machine – Removing Blockages' page of this user guide (p9)
- If the brushbar has been checked for blockages and the light still on, we're here to help. Call us on **AU: 1300 361 505 / NZ: 0800 800 900**

Why does the vacuum cleaner cut out?

- The motor is equipped with a thermal cut-out. If for any reason the unit should overheat (eg. from blocked nozzles, a full dust container or unclean filters), the thermostat will automatically turn the unit off. Should this occur, unplug the vacuum cleaner from the electrical socket and turn off the switch. Remove and empty the dirt container. Check the hose for blockages. Clean the filters. Allow the unit to cool for approximately 1 hour (if you have cleaned the filters you will need to wait 24 hours for the filters to dry before putting them back in the machine)

What do I do if the unit becomes damaged or broken?

- We're here to help. Simply call **AU: 1300 361 505 / NZ: 0800 800 900**

Other Information

Service & Help

Any queries or concerns about using your Vax, simply visit; vax.com.au or call the Vax Careline. Calls are charged at the standard local rate. Please make a note of the serial number and model number of the vacuum cleaner before calling.

Vax Careline:

AU: 1300 361 505

NZ: 0800 800 900

Monday-Friday 8.30am to 5.00pm

Technical Specification

Wattage: 1200W

Voltage: 220-240V ~50Hz

Filters: Pre-motor filter (washable)

Post-motor filter: H12 HEPA (anti-bacterial) (non-washable, tap to clean)

Cord Length: 6m

Hose Length: 1.3m

Dust Capacity: 1.5L

Product Weight: 4.5kg

Subject to technical change without notice.



Double
Insulated



N197



Indoor
Use



Read
Instructions



Distributed by Techtronic Industries Pty. Ltd.
Level 1, 660 Doncaster Road, Doncaster, Australia 3108.
www.vax.com.au Service Line: AU: 1300 361 505 / NZ: 0800 800 900