



Performance is everything.™

# User Guide

Vax Careline: AU: 1300 361 505  
NZ: 0800 800 900

## Multifunction SpinScrub



# Get Cleaning...

What's your Vax's model number?

V S S 7 1 5 1 ■ ■ ■

What's your serial number? (Located on the base of the machine)

■ - ■ ■ ■ ■ ■ ■ - ■ ■ ■ - ■ ■ ■ - ■

Note these down in case you need them in future. Please keep instructions for further use.

Vax Service line  
AU: 1300 361 505 / NZ: 0800 800 900

# Machine Overview

- 1 Filter housing
- 2 Clean water tank
- 3 Dirty water tank/dirt container
- 4 Carry handle
- 5 On/off button
- 6 Solution pump on/off button
- 7 Power cord
- 8 Lid
- 9 Telescopic extension tube
- 10 Crevice tool
- 11 Dusting brush
- 12 Upholstery tool
- 13 Hose and handle
- 14 Solution delivery tube
- 15 Combination floor head
- 16 SpinScrub wash head
- 17 Upholstery wash tool
- 18 2 x paper dust bags
- 19 1 x cloth dust bag
- 20 Vax carpet cleaning solution
- 21 Variable power dial
- 22 Turbo tool
- 23 Turbo brush
- 24 Hard floor wash tool

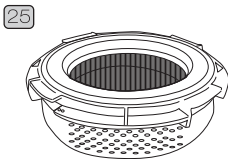
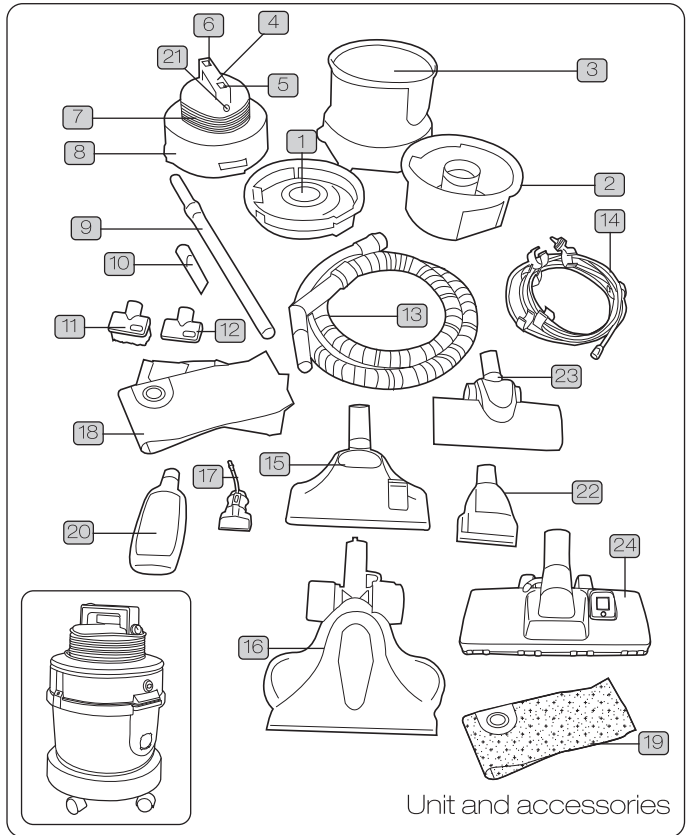

Filters

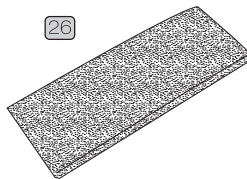

26 Foam post-motor filter

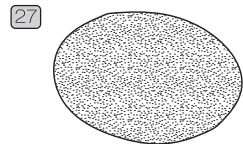

27 Foam pre-motor filter

# General Safety Information

## FOR HOUSEHOLD USE ONLY.

When using the vacuum cleaner, basic safety precautions should always be observed, including the following:

1. Do not leave the multifunction machine unattended when plugged in. Unplug it from the socket when not in use.
2. To prevent electric shock do not use outdoors.
3. Not to be used as a toy.
4. Children should be supervised to ensure that they do not play with the appliance.
5. This appliance is not intended for use by persons (including children) with reduced physical, sensory or mental capabilities, or lack of experience and knowledge, unless they have been given supervision or instruction concerning the use of the appliance by a person responsible for their safety.
6. Use only as described in this manual. Use only Vax recommended attachments.
7. Do not use the vacuum cleaner if it has been dropped, damaged, left outdoors or dropped into water. Do not use the vacuum cleaner with a damaged cord or plug. If the supply cord is damaged, it must be replaced by the manufacturer or a recommended service agent to avoid a hazard..
8. Do not handle the plug or multifunction machine with wet hands. Do not use outdoors.
9. Do not pull or carry by cord. Do not use cord as a handle, close a door on the cord or pull cord around sharp edges or corners. Do not run the multifunction machine over the cord. Keep the cord away from heated surfaces.
10. Do not put any objects into openings or operate with openings blocked. Keep them free of anything that might reduce airflow.
11. Keep hair, loose clothing, fingers and all parts of body away from openings and moving parts.
12. Do not pick up hot coals, cigarette butts, matches or any hot, smoking or burning objects.
13. Do not use the carpet washing function without the solution tank and dirty water tank in place.
14. Do not use the vacuum without the dust bag in place.
15. Turn off all controls before unplugging.
16. Do not vacuum up harmful or toxic material (chlorine, bleach, ammonia, drain cleaner etc.).
17. Do not vacuum up hard or sharp objects such as glass, nails, screws, coins, etc.

18. Use only SAA 10 amp extension cords. Non approved cords may over heat. Care should be taken to arrange the cord so that the cord cannot be tripped over.
19. Store the multifunction machine in a cool, dry area.
20. To prevent dirty water from running into motor, do not hold the appliance upside-down or lay on its side. Use appliance in normal vacuuming/carpet washing position.
21. Take extra care when cleaning on stairs.
22. Turn off the on/off switch before unplugging the multifunction machine.
23. Do not carry appliance while motor is running.
24. We recommend the use of a residual current device with a residual current rating of 30mA or less.



**WARNING:** Always switch off and unplug the multifunction machine from the electrical outlet before assembling, opening, emptying the dirt container, before connecting/disconnecting the attachments, or carrying out maintenance or troubleshooting checks.



**NOTE:** Carpets should be dry vacuumed thoroughly before washing.



**IMPORTANT:** If the hose or tools are blocked, switch off the multifunction cleaner and remove the blockage(s) before re-starting your machine. See maintenance.



**IMPORTANT:** Cleaning filters maintains vacuum performance. Vax recommends that your filters should be checked and cleaned periodically. If your filters are washable make sure they are completely dry before inserting back into the multifunction machine.



**IMPORTANT:** The motor is equipped with a thermal cut-out. If for any reason the unit should overheat, the thermostat will automatically turn the unit off. Should this occur, unplug the vacuum cleaner from the electrical outlet and turn off the switch. Remove dirt container and empty. Clean filters. Allow the unit to cool for approximately one (1) hour. To re-start, plug into an electrical outlet and switch back on.

**This machine is intended for household use only, and NOT for commercial or industrial use.**

**PLEASE KEEP THESE INSTRUCTIONS FOR FURTHER USE.**

# Operation

## Vacuuming

### Assembling your multifunction cleaner (dry vacuuming)

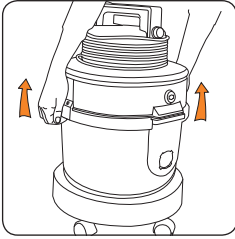

Remove lid.

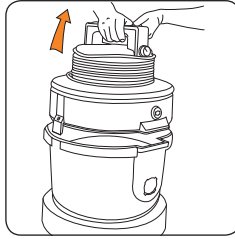

Remove clean water tank.

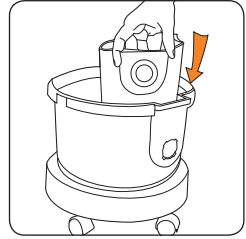

Insert dust bag.



Insert the filter housing.

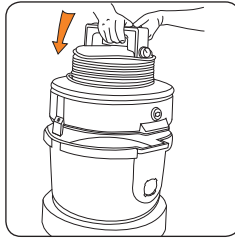

Press down on clips to secure.

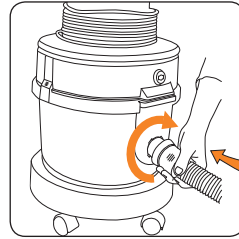

Insert hose and twist clockwise.

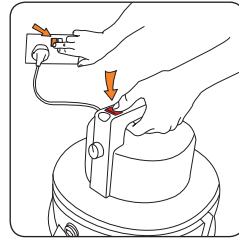
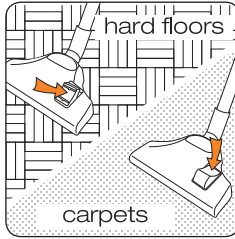
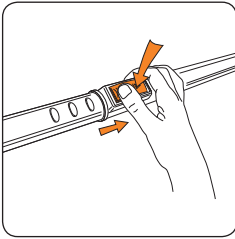
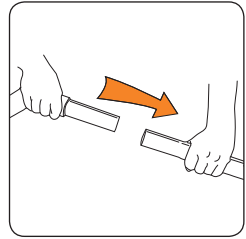

Press on/off button.

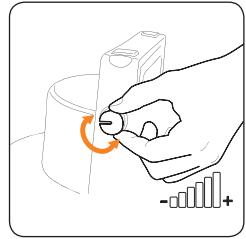

Vary power accordingly

**NOTE:** The Turbo tool, Turbo brush, crevice tool, dusting brush and upholstery tool, can all be attached to the telescopic tube/handle.

**NOTE:** Fully unwind power cord.

**⚠ WARNING:** Do not use the multifunction cleaner as a carpet washer when set up in dry vacuuming mode.

## Carpet washing

 **WARNING: Do not use the multifunction cleaner as a dry vacuum when set up in carpet washing mode.**

### Before you begin carpet washing:

1. Dry vacuum your carpet thoroughly.
2. Test for colourfastness – wet a white absorbent cloth with the solution. In a small, hidden area gently rub the surface with the dampened cloth. Wait ten minutes and check for colour removal or bleed with white paper towel or cloth. If surface has more than one colour, check all colours.

**NOTE:** When cleaning entire floor, move furniture out of area to be cleaned. For furniture too heavy to move, place aluminium foil or wax paper under legs. This will prevent wood finishes from staining carpet. Pin up furniture skirts or curtains.

### Helpful hints for cleaning carpet:

1. Only use Vax recommended cleaning solution with this machine.
2. Do not over saturate carpet with cleaning solution while using the machine.
3. For heavy soiled areas, additional applications may be necessary.
4. Allow plenty of time for carpet to dry thoroughly.
5. Try not to walk on carpet until it is completely dry.
6. After carpet is thoroughly dry, vacuum the carpet using your multifunction cleaner in dry mode.
7. Before cleaning, determine where to start and end, making sure not to walk over previously cleaned areas.
8. Thoroughly clean the dirty water tank and clean water tank after use with warm water (max 40°C).

# Operation

## Assembling your multifunction cleaner (carpet washing)

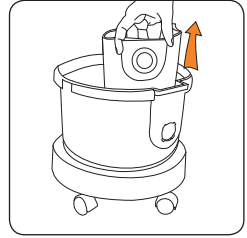
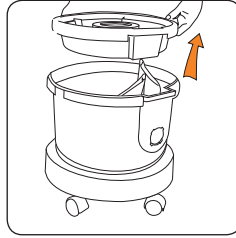
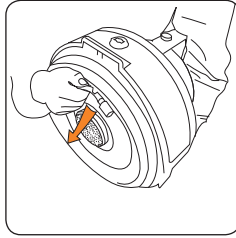
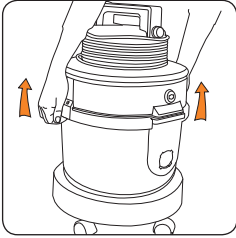

Remove solution tube from under side of motor housing.

Remove filter housing.

Remove dust bag.

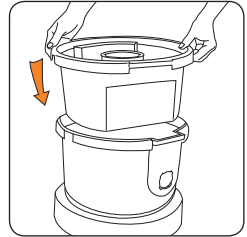
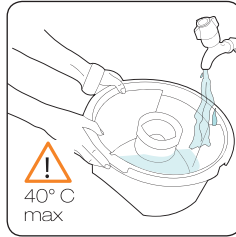
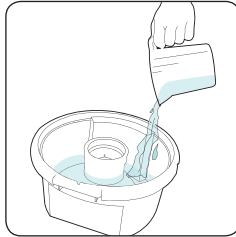
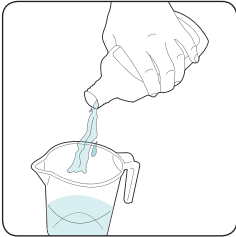

Add 40ml of Vax solution per 1 litre of water, unless otherwise stated on the bottle.

Fill clean water tank with warm water (max 40° C).

Insert clean water tank.

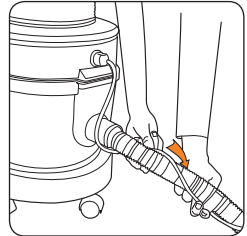
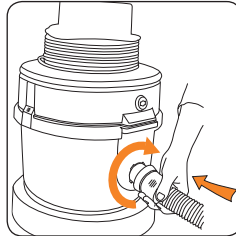
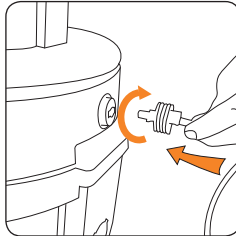
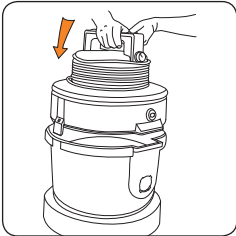

Press down on clips to secure.

Attach solution tube and twist into position.

Insert hose and twist clockwise.

Ensure the solution tube is wrapped loosely around the hose and extension tube. Secure in place with the clips provided.

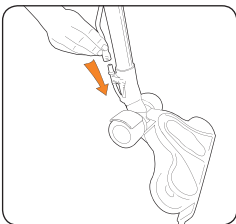

Attach the solution tube to the wash head at the connection point.

# Operation

## Operating the appliance (carpet washing mode)

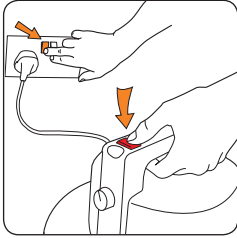

Press red button  
– power.

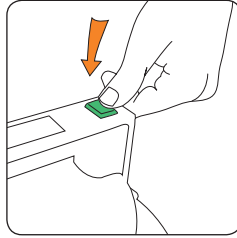

Press green button  
to activate pump.

## Washing carpets

**NOTE:** For best results apply solution on the forward stroke and recover solution on the backward stroke.

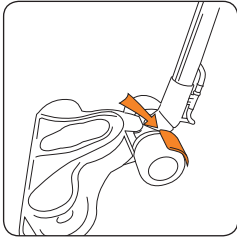

To put down water  
and solution and turn  
the brushes on,  
push rocker switch  
towards the back of  
the floor head.

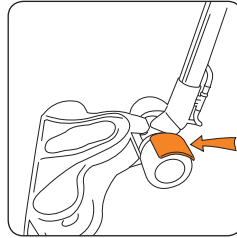

To suck up excess  
water push the rocker  
switch to the front.

## Washing hard floors

**NOTE:** Rinse out your carpet cleaning solution and fill the clean water tank with clean water before washing your hard floors.

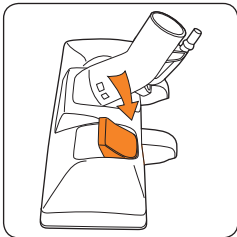

To put down water,  
push the rocker  
switch towards the  
back of the hard floor  
wash head.

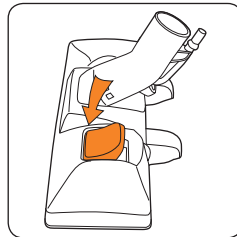

To suck up excess  
water, push the rocker  
switch to the front.



# Operation

## Washing upholstery

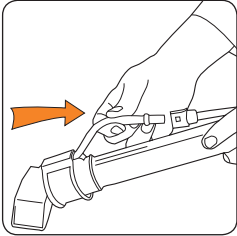

Attach the upholstery wash tool directly onto the handle of the hose and wrap the excess solution tube around as necessary.

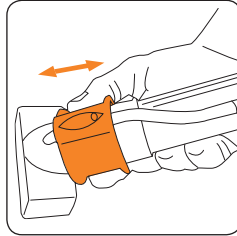

To start water and solution flow, push the collar on the wash tool forwards.

To recover excess water and solution, pull the collar backwards.

# Maintenance (Keep your Vax as good as new)

**⚠ WARNING:** Unplug your multifunction cleaner before performing maintenance/ troubleshooting checks.

## Emptying and replacing the dust bag

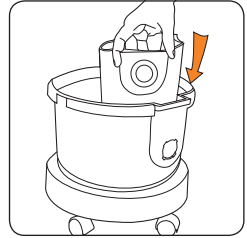
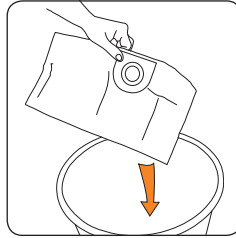
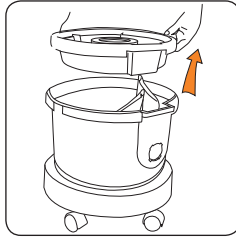
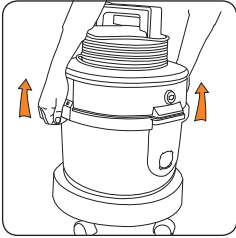

Insert new bag.

**⚠ IMPORTANT:** The condition of the filters affects the performance of your machine. Please check, wash/change filters periodically (depending on level of use). Do not use your machine without all of the filters in place.

## Cleaning the HEPA filter

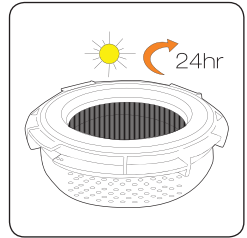
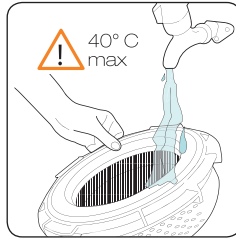
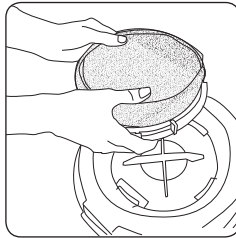
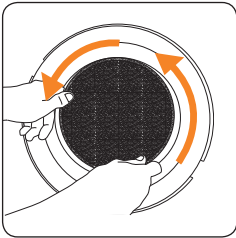

Wash under tap.

Allow to dry completely before replacing in machine.

## Cleaning the post motor filter

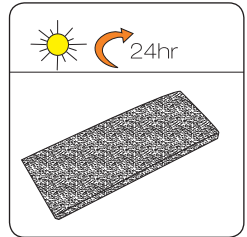
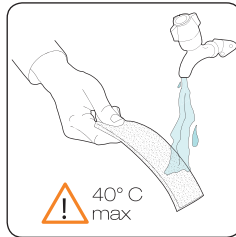
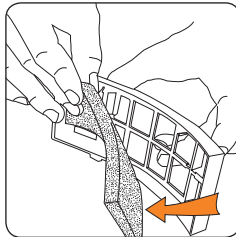
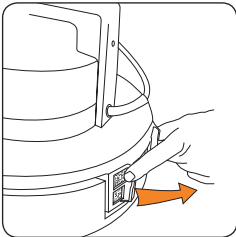

# Maintenance (Keep your Vax as good as new)

## Cleaning the pre-motor filter

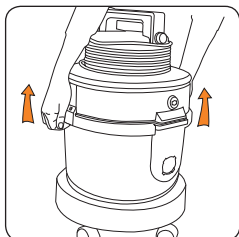

Remove motor housing.

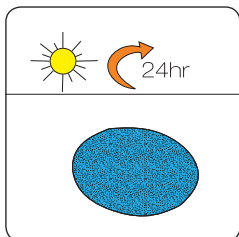
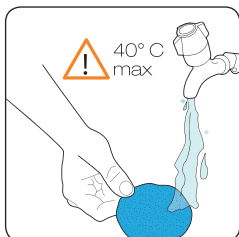
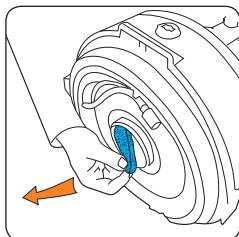

## Emptying and cleaning the clean and dirty water tanks



Empty and rinse both tanks out with clean water after use.

# Maintenance (Keep your Vax as good as new)

## Clearing blockages

 **WARNING:** To reduce the risk of personal injury, unplug your multifunction cleaner before performing maintenance/troubleshooting checks.

### Hose blockages

Disconnect the hose from your machine.  
Carefully remove any blockages found and reconnect the hose securely.

### Accessory blockages

Remove accessory from the hose or tube.  
Carefully remove the blockage and return to the cleaner.

 **WARNING:** The brushbar on the Turbo tool / Turbo brush will stop rotating if it is blocked or if anything is wrapped around it.

## Clearing debris from the Turbo tool

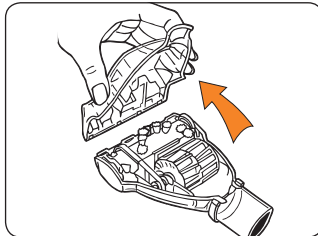
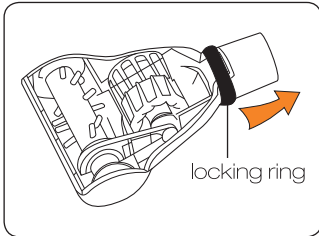

Remove wrapped threads.

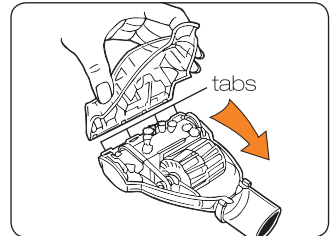

## Removing debris from the Turbo brush

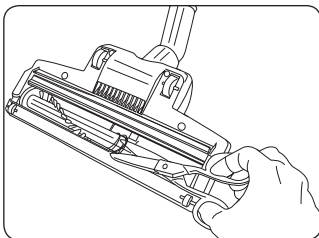

Remove wrapped threads.

# Maintenance (Keep your Vax as good as new)

## Removing debris from the SpinScrub brushes

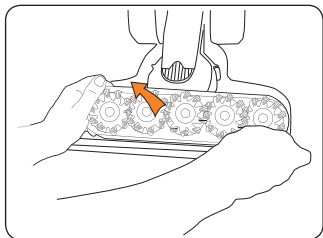

Pull SpinScrub brush out.

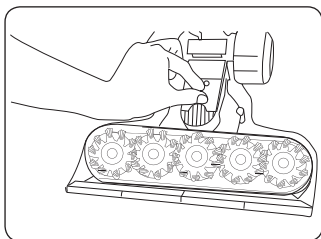
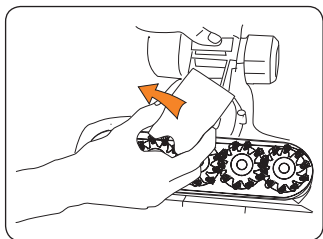
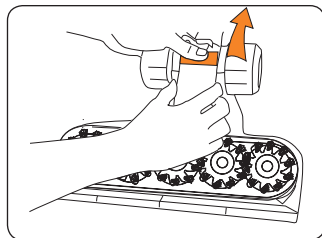
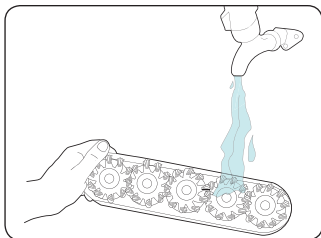

If blockages occur, they may be removed.

# FAQ's



**WARNING:** To reduce the risk of personal injury, unplug the vacuum cleaner before performing maintenance/troubleshooting checks.

Problem	Solution
Is there an accessory missing?	Check the "Machine Overview" page to make sure the attachment is supplied with your unit.
Why won't my multifunction cleaner put down water/solution mix?	Check there is water/solution mix in the clean water tank.
	Ensure the solution tube on the underside of the motor housing has been released and is in the clean water tank.
	Check that the pump button on the carry handle has been switched on.
	Ensure the foot pedal on the floor head is positioned to the back of the floor head.
	Ensure the collar on the wash tool is pushed forward.
Why won't my multifunction cleaner recover water?	The dirty water tank may be full.
	The floor head/wash tool nozzle might have an obstruction.
Why won't the brushes rotate on my Turbo tool/Turbo brush/SpinScrub wash head?	Ensure there are no obstructions in the floor head.
	Carpet threads may be trapped around the bristles which may need to be removed.
What do I do if an accessory/the unit has become damaged or broken?	Please call our careline to purchase new spares or order a replacement
Why won't the multifunction cleaner pick up in dry mode?	A filter may be clogged; refer to maintenance section for cleaning instructions.
	The dust bag may be incorrectly fitted, check "Assembling your multifunction cleaner (dry vacuuming)."
	The dust bag may be full, check and replace with a new dust bag.
	Check for blockages in the hose/floor heads/accessories.
Why is dust escaping from my multifunction cleaner in dry mode?	The filters may be incorrectly installed, refer to the "Maintenance Section"
	The dust bag may be incorrectly fitted, refer to "Assembling your multifunction cleaner (dry vacuuming)."
	The dust bag may be full, or blocked; refer to the "Maintenance Section"

## we're here to help

Instead of taking me back to the shop, simply call:

**AU: 1300 361 505**  
**NZ: 0800 800 900**

[vax.com.au](http://vax.com.au)

This does not affect your statutory rights

# Other Information

## Vax Service & Help

### Vax Careline:

Australia 1300 361 505

New Zealand 0800 800 900

Monday-Friday 8.30am to 5.00pm

If you have queries or concerns about using your Vax, call the Vax Careline. Calls are charged at the standard local rate. Please make a note of the serial number and model number of the vacuum cleaner before calling.

For the nearest Service Agent, please call the Vax Customer Careline or visit [www.vax.com.au](http://www.vax.com.au)

## Technical Specification

### On Vacuum

Voltage: 220-240V ~50Hz

Wattage: 1500W

Capacity: Dust Bag 10 Litres  
Clean Water Tank 4 Litres  
Dirty Water Tank 8 Litres

Cord length: 10m

Weight: 8.7kg

Subject to technical change without notice.



Double Insulated



N197



Indoor Use



Read Instructions



Waste electrical products should not be disposed of with household waste. Please recycle where facilities exist. Check with your Local Authority or retailer for recycling advice.



**Performance is everything.™**

Distributed by Techtronic Industries Pty. Ltd.  
Level 1, 660 Doncaster Road, Doncaster, Australia 3108.  
[www.vax.com.au](http://www.vax.com.au) Service Line: AU: 1300 361 505 / NZ: 0800 800 900