



AirPet

User Guide

VCAP1500



**3 year
warranty**

Contents

Contents	1
Machine Overview	2
General Safety Information	3
Getting Started	5
Maintenance	6
Looking After Your Machine – Filters	7
Looking After Your Machine – Advanced cleaning	9
Looking After Your Machine – Removing blockages	10
FAQs	12
Other Information	13

Machine Overview

1. Hose connector
2. Dirt container
3. Cyclone separator and shroud
4. Carry handle
5. Dirt container release button
6. Cord rewind button (hidden)
7. Floor head parking slot
8. On/off button
9. Post-motor filter cover
10. Primary separator
11. Antibacterial HEPA media post-motor filter
(Note: Post-motor filter is housed in the left wheel)
12. Pre-motor filter
13. Turbo brush
14. Combination floor head
15. Telescopic extension tube
16. Dusting brush
17. Crevice tool
18. Flexible hose and handle
19. Mini turbo tool
20. Upholstery tool
21. Connector for Mini turbo tool



General Safety Information

This vacuum cleaner is intended for household use only and NOT for commercial or industrial use.

When using the vacuum cleaner basic safety precautions should always be observed, including the following:

1. Only use the vacuum cleaner indoors on dry surfaces.
2. Turn off the on/off switch on the vacuum cleaner controls before disconnecting or connecting from the mains supply.
3. Always unplug the vacuum cleaner before connecting or disconnecting the vacuum hose and accessories.
4. Children should be supervised to ensure that they do not play with the appliance.
5. This appliance is not intended for use by children and persons with reduced physical, sensory or mental capabilities or lack of experience and knowledge, unless they have been given supervision or instruction concerning use of the appliance in a safe way and understands the hazards involved.
6. Cleaning and maintenance shall not be made by children.
7. The appliance should only be used as described in the quick start guide and in the full user guide.
8. Only Vax recommended attachments should be used with this appliance.
9. Do not use this vacuum cleaner if it has been dropped, damaged, left outdoors or dropped into water. Do not use this vacuum cleaner with a damaged cord or plug.
10. Do not pull or carry this appliance by the cord. Do not use the cord as a handle, close a door on the cord or pull the cord around sharp edges or corners. Do not run the vacuum cleaner over the cord. Keep the cord away from heated surfaces.
11. Do not handle the plug or the vacuum cleaner with wet hands.
12. Keep hair, loose clothing, fingers and all parts of the body away from openings and moving parts.
13. Do not pick up any hot coals, ash, cigarette butts, matches or any hot, smoking or burning objects.
14. Do not pick up any flammable or combustible materials (lighter fluid, petrol, kerosene etc.) or use in the presence of explosive liquids or vapours.
15. Do not vacuum harmful or toxic material (chlorine, bleach, ammonia, drain cleaner etc.).
16. Do not vacuum hard or sharp objects such as glass, nails, screws, coins etc.
17. Do not vacuum plaster dust, concrete dust or any other building or vitreous materials.
18. Do not vacuum baking soda or any other powder-based carpet refresher or deodoriser.
19. Store the vacuum cleaner in a cool, dry area.
20. Use only SAA approved 10amp extension cords. Non-approved cords may overheat. Care should be taken to arrange the cord so that the cord cannot be tripped over.
21. Do not put any objects into openings. Do not use with any openings blocked and do not restrict airflow. Keep all openings free of dust, lint, hair or anything that might reduce airflow.
22. Do not use the vacuum cleaner with blocked filters and without all of the filters in place.
23. Take extra care when positioning the vacuum cleaner on the stairs.
24. Keep vacuuming area well lit.

General Safety Information

- WARNING:** Always switch off and unplug the vacuum cleaner from the electrical socket before assembling, opening or emptying the dirt container, or before connecting/disconnecting the attachments.
- CAUTION:** The vacuum cleaner is a very powerful unit. Before plugging the cord into the electrical socket, make sure the switch is in the 'off' position.
- IMPORTANT:** If the inlet, hose or telescopic tube is blocked, switch off the vacuum cleaner and remove the blockage(s) before re-starting the vacuum cleaner.
- IMPORTANT:** Vax recommends the use of Residual Current Device Rating of 30mA or less.
- IMPORTANT:** It is very important that filters are kept clean to obtain maximum performance from your vacuum cleaner. Not cleaning and not replacing your filters regularly can reduce the suction power and cause overheating and permanent damage to the vacuum cleaner.
- NOTE:** If the supply cord is damaged it must be replaced by the manufacturer, or a similarly qualified person in order to avoid hazard, or invalidating the warranty.
- IMPORTANT:** The motor is equipped with a thermal cut-out. If for any reason the unit should overheat (eg. from blocked nozzles, a full dust container or unclean filters), the thermostat will automatically turn off the switch. Should this occur, unplug the vacuum cleaner from the electrical socket and turn off the switch. Remove dirt container and empty. Clean filters. Allow the unit to cool for approximately one (1) hour. To re-start, plug into an electrical socket and switch back on.

DAMAGE TO THE VACUUM CLEANER CAUSED AS A DIRECT RESULT OF NOT ADHERING TO THE GENERAL SAFETY INFORMATION AND THE INSTRUCTIONS IN THIS USER GUIDE INVALIDATES THE WARRANTY

PLEASE KEEP THESE INSTRUCTIONS FOR FUTURE REFERENCE

Getting Started

Assembling your vacuum cleaner

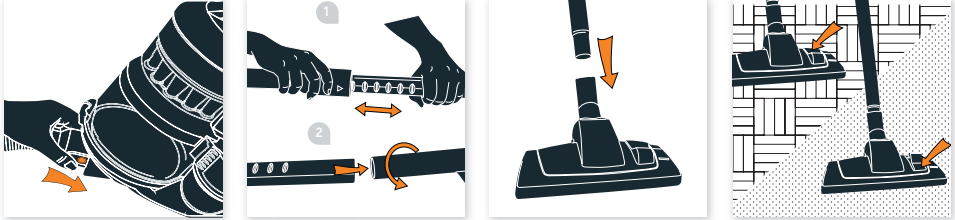

CAUTION: The vacuum cleaner is a very powerful unit. Before plugging the cord into the electrical socket, make sure the switch is in the 'off' position. Hold the vacuum cleaner firmly when starting and in use.

NOTE: The Mini Turbo Tool (with Turbo Tool connector attached), Turbo brush, crevice tool, upholstery tool and dusting brush can all be attached to the telescopic tube or hose handle.

Operating the appliance and accessories

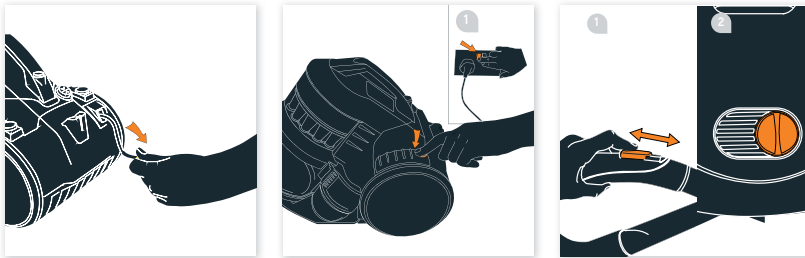

NOTE: Fully unwind the power cord. A yellow mark on the cord indicates the recommended cord length. Do not exceed the cord length beyond the yellow mark.

Packing away and storage

NOTE: For convenience there is a parking slot located at the rear of the vacuum cleaner where the floor head and tubes can be attached for storage and carrying.

Packing away and storage

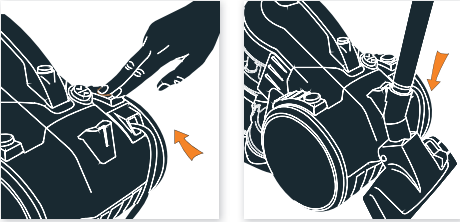

Emptying and cleaning the dirt container

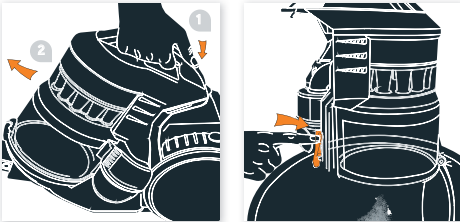

NOTE: For best cleaning results the dust bin should be emptied after each use and at the very least when the 'MAX' mark has been reached.

Looking After Your Machine - Filters

Cleaning the pre-motor filter

NOTE: Replace the filter when discoloured or damaged (frequency will depend on level of use).

WARNING: Water temperature should not exceed 40°C when washing the pre-motor filter.

WARNING: Ensure filter is completely dry before inserting back into the vacuum cleaner.

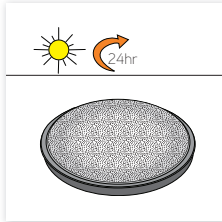
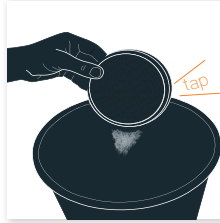
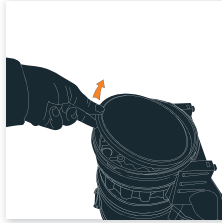
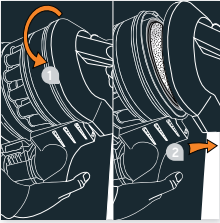

Looking After Your Machine - Filters

Cleaning the Antibacterial HEPA media post-motor filter

NOTE: Replace the filter when discoloured or damaged (frequency will depend on level of use).

WARNING: Do not wash the post-motor filter. 

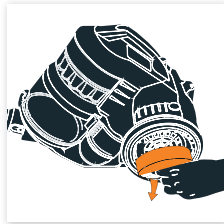
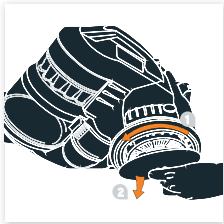

Follow the instructions to unlock the cover to remove the post-motor filter. Tap to clean the post-motor filter and put back in place.

Tap to clean.

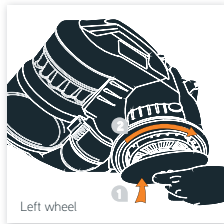
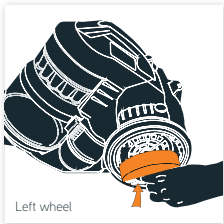

Insert the cover back with the symbols being horizontal. Follow the instruction to lock the cover until it clicks back in place.

Looking After Your Machine - Advanced Cleaning

Advanced cleaning - primary separator

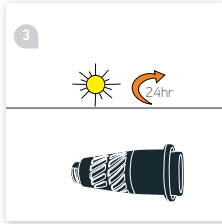
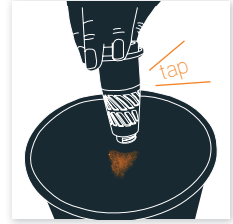
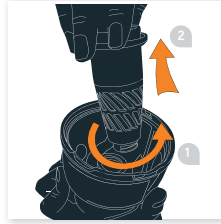
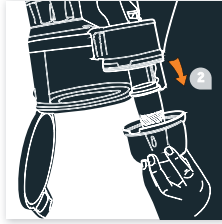
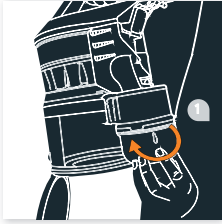

WARNING: Ensure separator is completely dry before inserting back into the vacuum cleaner.

Advanced cleaning - cyclone separator

NOTE: Replace the filter when discoloured or damaged (frequency will depend on level of use).

WARNING: Always switch off and unplug the vacuum cleaner from the electrical socket before assembling, opening or emptying the dirt container, or before connecting/disconnecting the attachments.

WARNING: For best cleaning results filters require cleaning at least every three months. Do not use your vacuum cleaner without all of the filters in place.

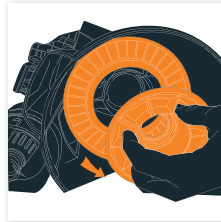
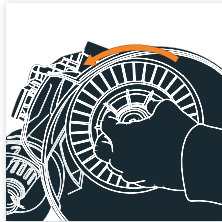
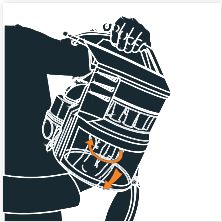

Looking After Your Machine - Removing Blockages

WARNING: To reduce the risk of electric shock, the power cord must be disconnected before performing maintenance/troubleshooting checks. Turn the vacuum cleaner off and unplug from the electrical socket.

IMPORTANT: If the air inlet, hose or telescopic tube is blocked, switch off the vacuum cleaner and remove the blockage(s) before re-starting the vacuum cleaner.

Hose blockages

The flexible hose may be disconnected from the vacuum cleaner. Carefully remove any blockages found and reconnect the hose securely.

Accessory blockages

Remove accessory from the hose/telescopic tube. Carefully remove the blockage and return to the cleaner.

Removing blockages from the Mini Turbo Tool

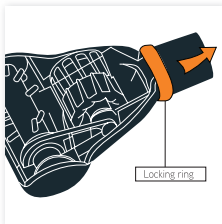

Turn the Mini Turbo Tool over and slide off the locking ring.

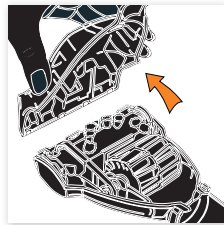

Detach lower housing and remove blockage.

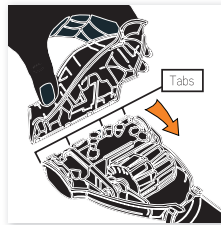

To re-assemble the Mini Turbo Tool, ensure that the tabs are engaged and pivot the lower housing closed. Slip the locking ring over the neck of the Mini Turbo Tool and into the groove to finish.

Looking After Your Machine

- Removing Blockages

Removing blockages from the Turbo brush



Lay the Turbo brush floor head on a flat surface and turn over to expose the brushbar. Using a pair of scissors, cut through any threads or hairs caught by the brushbar that have wrapped around the guides.

Warning: To reduce the risk of personal injury, unplug the vacuum cleaner before performing maintenance/troubleshooting checks.

Is there an accessory missing?

- Check the 'Machine Overview' page in this guide to make sure that the part is definitely included in your unit.
- If it is missing, we're here to help. Simply call us on **AU 1300 361 505 / NZ 0800 800 900**

Why won't the vacuum cleaner pick up?

- The dirt container may be incorrectly installed; remove the dirt container from the unit by pressing the dirt container release catch and then reattaching it to the unit, ensuring it is locked firmly back into place.
- The filter may be clogged; refer to 'Maintenance: Cleaning the filters' on pages 7-8 and 'Looking after your machine - Advanced cleaning' on page 9.
- The dirt container may be blocked; refer to 'Maintenance: Emptying and cleaning the dirt container' on page 6.
- There may be a blockage in the tube/hose. Disconnect from the vacuum cleaner, carefully remove any blockages found and reconnect securely.

Why is dust escaping from the vacuum?

- The filter may be clogged; refer to 'Maintenance: Cleaning the filters' on pages 7-8.
- The dirt container may be blocked; refer to 'Maintenance: Emptying and cleaning the dirt container' on page 6.
- The dirt container may be incorrectly installed; remove the dirt container from the unit by pressing the dirt container release catch and then reattaching it to the unit, ensuring it is locked firmly back into place.

What do I do if the unit/an accessory becomes damaged or broken?

- We're here to help. Simply call **AU 1300 361 505 / NZ 0800 800 900** or visit vax.com.au

Why won't the accessories pick up properly?

- **Hose blockages:** remove the hose from the unit. Carefully remove any blockages found and reconnect hose securely.
- **Accessory blockages:** remove accessory from handle/tube. Carefully remove blockage and re-attach to the vacuum cleaner.
- The accessory may be faulty. Simply call us on **AU 1300 361 505 / NZ 0800 800 900** for assistance.

Why will the vacuum cleaner not run?

- It may not be plugged into the electrical socket correctly; ensure that the plug is pushed in securely.
- The electrical socket may not be working properly; check the fuse or breaker, or consult an electrician.
- The motor thermostat may have tripped; switch off and unplug the vacuum cleaner, and leave for one hour before switching the cleaner back on.

Other Information

Vax Service & Help

Vax Careline:

Australia 1300 361 505
New Zealand 0800 800 900

Monday-Friday 8.30am to 5.00pm

If you have queries or concerns about using your Vax, call the Vax Careline. Calls are charged at the standard local rate. Please make a note of the serial number and model number of the vacuum cleaner before calling.

For the nearest Service Agent, please call the Vax Customer Careline or visit vax.com.au / vax.co.nz

Technical Specification

Wattage: 1500W

Air Wattage: 310W

Voltage: 220-240V ~50Hz

Capacity: 2.5L

Filters: Pre-motor filter – washable
Post-motor filter – Antibacterial HEPA filter (not washable)

Hose length: 2.5m

Cord length: 6m

Weight: 5.6 kg

Subject to technical change without notice.



Double Insulated



Indoor Use



Read Instructions



Distributed by Techtronic Industries Australia Pty. Ltd.
Level 1, 660 Doncaster Road, Doncaster, Australia 3108.
Service Line: AU: 1300 361 505 / NZ: 0800 800 900