

# VAXCARE

Please register your warranty. Send in your completed Warranty Card.

If you require any further assistance or advice about any

VAX please call VAXCARE on

**1300 36 4040** (Australia - cost of a local call)

and **0800 800 900** (NZ)



VAX Appliances (Australia) Pty Ltd  
A.C.N. 009099736

296 Victoria Road Malaga Western Australia 6090.

**EMAIL: vaxcare@vax.com.au**

**WEBSITE: www.vax.com.au**

## **vax** AUST. & NZ BRANCHES

### • NSW/ACT

Unit 2, 30 Heathcote Road,  
Moorebank, NSW 2170  
Telephone: (02) 9602 6800  
Facsimile: (02) 9602 6900

### • VICTORIA/TASMANIA

Unit 3, 46 Burgess Road,  
Bayswater North, VIC 3153  
Telephone: (03) 9761 7160  
Facsimile: (03) 9761 7175

### • SOUTH AUSTRALIA/ NORTHERN TERRITORY

Unit 3, 75-77 Grange Road,  
Welland, SA 5007  
Telephone: (08) 8340 2222  
Facsimile: (08) 8346 7933

### • QUEENSLAND

186 Kerry Road,  
Archerfield, QLD 4108  
Telephone: (07) 3216 7350  
Facsimile: (07) 3216 7375

### • WESTERN AUSTRALIA

296 Victoria Road,  
Malaga, WA 6090  
Telephone: (08) 9247 8100  
Facsimile: (08) 9247 8192

### • VAX APPLIANCES NEW ZEALAND

27 Clemow Drive  
Mt Wellington, Auckland  
Telephone: (09) 5736220  
Facsimile: (09) 5736224  
Email: vaxnz@vax.co.nz



[www.vax.com.au](http://www.vax.com.au)

**Vaxcare:**  
**AUST: 1300 36 4040**  
**NZ: 0800 800 900**

## Bagless cylinder

## absolute<sup>®</sup>

## VZ-702

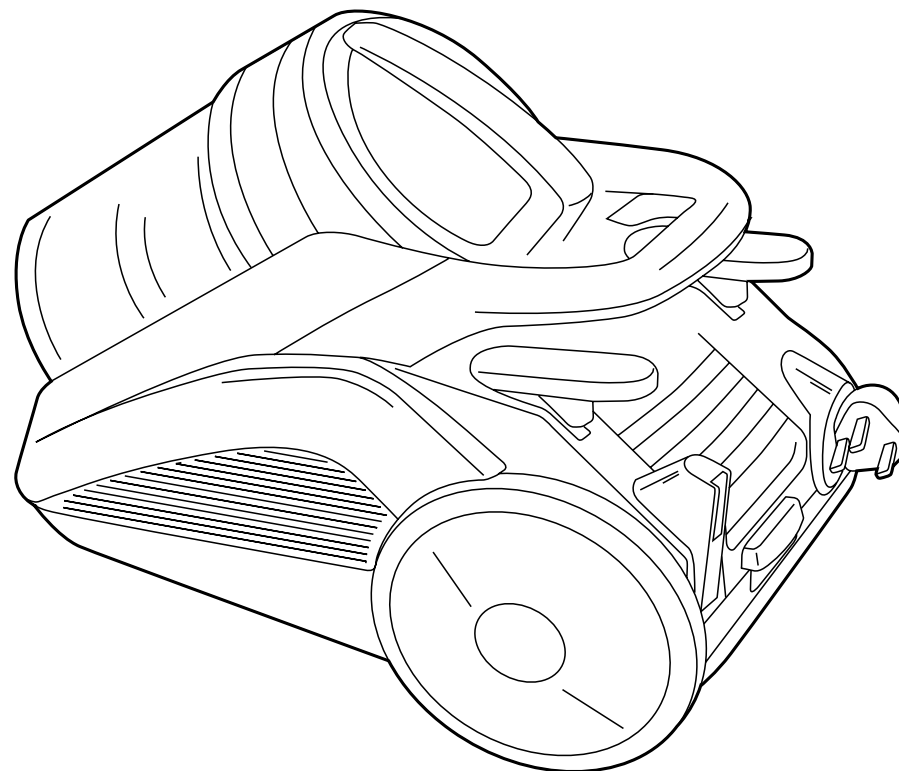

## Instruction Manual

Please read carefully before using this cleaner.  
Always fully extend the mains cable before use.  
Retain for future reference.

## 1. Safety Information

### FOR HOUSEHOLD USE ONLY

When using the vacuum cleaner, basic safety precautions should always be observed, including the following:

1. Only use the vacuum cleaner indoors on dry surfaces.
2. Turn off the vacuum cleaner controls before connecting or disconnecting from the mains supply.
3. Always unplug the vacuum cleaner before connecting or disconnecting the vacuum hose and accessories.
4. This appliance is not intended for use by young or infirm persons unless they have been adequately supervised by a responsible person to ensure that they can use the appliance safely.  
Young children should be supervised to ensure that they do not play with the appliance.
5. Use only as described in this manual.  
Use only the manufacturer's recommended attachments.
6. Do not use the vacuum cleaner if it has been dropped, damaged, left outdoors or dropped into water. Do not use the vacuum cleaner with a damaged cord or plug. If the supply cord or plug is damaged, return the vacuum cleaner to a Vax Authorised Service Agent for examination, repair or adjustment.
7. Do not pull or carry by the cord. Do not use the cord as a handle, close a door on the cord or pull the cord around sharp edges or corners. Do not run the vacuum cleaner over the cord. Keep the cord away from heated surfaces.
8. Do not handle the plug or vacuum cleaner with wet hands. Do not use outdoors or on wet surfaces.
9. Do not put any objects into openings. Do not use with any openings blocked and do not restrict air flow. Keep all openings free of dust, lint, hair or anything that may reduce airflow.
10. Keep hair, loose clothing, fingers and all parts of the body away from openings and moving parts.
11. Do not pick up hot coals, cigarette butts, matches or any hot, smoking or burning objects.

12. Do not pick up flammable or combustible materials (lighter fluid, petrol, kerosene, etc) or use in the presence of explosive liquids or vapours.
13. Do not vacuum up harmful or toxic material (chlorine bleach, ammonia, drain cleaner, etc).
14. Do not vacuum up hard or sharp objects such as glass, nails, screws, coins, etc.
15. Do not use without the filters in place.
16. Take extra care when vacuuming on stairs.
17. Keep vacuuming area well lit.
18. Store the vacuum cleaner indoors in a cool, dry area.
19. Turn off the on/off switch before unplugging the vacuum cleaner.

**WARNING:** Always switch off and unplug the vacuum cleaner from the electrical outlet before assembling, opening or emptying the dirt container, or before connecting/disconnecting the attachments.

**CAUTION:** The vacuum cleaner is a very powerful unit. Before plugging the cord into the electrical outlet, make sure the switch is in the 'off' position.

**IMPORTANT:** If the inlet, hose or telescopic tube is blocked, switch off the vacuum cleaner and remove the blockage(s) before re-starting.

**IMPORTANT:** Washing filters improves vacuum performance. Make sure all the filters are completely dry before inserting back into the vacuum cleaner.

This vacuum cleaner is intended for household use only and not for commercial or industrial use.

### Motor Thermostat

**IMPORTANT:** The motor is equipped with a thermal cut-out. If for any reason, the vacuum cleaner should over-heat, the thermostat will automatically turn the unit off. Should this occur, unplug the vacuum cleaner from the electrical outlet and turn off the switch. Remove the dirt container and empty. Clean or replace the filters. Allow the cleaner to cool for approximately one (1) hour before restarting.

## Troubleshooting

**WARNING:** To reduce the risk of injury, unplug vacuum cleaner before servicing.

### **PROBLEM: Vacuum cleaner won't run**

**Cause:** Not properly plugged into electrical outlet.

**Solution:** Plug in firmly.

**Cause:** No electricity in the electrical outlet.

**Solution:** Check fuse or breaker.

**Cause:** On/off switch not turned on.

**Solution:** Push on/off switch to on.

**Cause:** Motor thermostat tripped.

**Solution:** Switch off and unplug the vacuum cleaner. Leave for one (1) hour before switching the vacuum cleaner back on.

**Cause:** Blown fuse/tripped breaker.

**Solution:** Reset house circuit breaker or replace fuse.

### **PROBLEM: Cleaner won't pick up/loss of suction**

**Cause:** Dirt container not installed properly.

**Solution:** Review dirt container replacement.

**Cause:** Dirt container full or blocked.

**Solution:** Empty dirt container.

**Cause:** Clogged filters.

**Solution:** Remove, clean and replace filters.

### **PROBLEM: Accessories won't pick up**

**Cause:** Accessories not attached correctly.

**Solution:** Refer to section 5.

### **PROBLEM: Dust escaping from the vacuum cleaner**

**Cause:** Dirt container full.

**Solution:** Empty dirt container.

**Cause:** Dirt container not installed correctly.

**Solution:** Review dirt container replacement.

**Cause:** Filter not installed completely.

**Solution:** Remove, clean and replace filters.

## VAXCARE Service & Help: AUSTRALIA 1300 36 4040 NEW ZEALAND 0800 800 900

Any queries or concerns about using the Vax, call VAXCARE.

Please make a note of the serial number and model number of the appliance before calling.

(Aust only: Mon-Fri. 10.00am to 6.00pm. EST)  
Calls are charged at the local rate.

An answerphone is available out of these hours.

There are over 300 approved Vax Service Agents in Australia and New Zealand. For the nearest Service Agent, please refer to your Vax warranty or call VAXCARE or visit [www.vax.com.au](http://www.vax.com.au)

## Technical Specification

Voltage: 220-240V~50Hz

Wattage: 1600W

Capacity: 3 litres approx

Filters: Cyclone separator - wipe clean

Pre-motor filter - washable

Post-motor filter - washable

Cord length: 8m (approx)

Weight: 8.55kg (approx)

**Subject to technical change without notice.**

**IMPORTANT:** The cyclonic separator should not be submerged in water.

**NOTE:** Do NOT use any detergents or boiling water to wash the filters. Vax recommends washing the filter periodically.

4. Replace the dirt container as directed.

### Cleaning the pre-motor filter

**NOTE:** This is located underneath the dirt container bin.

1. Release the pre-motor filter cover by pulling on the tab.
2. Lift out the filter unit and separate the filter and case.
3. The pre-motor filter can be rinsed in warm water (max 40°C). **Allow to air dry for 24 hours before replacing.**

**NOTE:** Do not use any detergents or boiling water to wash the filter. Vax recommends this filter should be checked and cleaned periodically.

4. Return the pre-motor filter and case to the vacuum cleaner and replace the pre-motor filter cover before restarting the vacuum cleaner.

### Cleaning the Post-motor filter

**NOTE:** This is located on the rear of the vacuum cleaner.

1. Release the post-motor filter cover by lifting the tab and remove the filter by pressing in the two catches.
2. The post-motor filter can be rinsed in warm water (max 40°C). **Allow to air dry for 24 hours before replacing.**

**NOTE:** Do not use any detergents or boiling water to wash the filters. Vax recommends washing the filter every 9-12 months.

3. Replace the post-motor filter and cover before restarting the vacuum cleaner.

### Replacement Filters

If lost or damaged replacement filters are available from your stockist or Vax direct. Phone Vaxcare or visit [www.vax.com.au](http://www.vax.com.au) for stockist listing.

## 7. Cleaning Blockages

**WARNING:** To reduce the risk of injury, the power cord must be disconnected before performing maintenance / troubleshooting checks.

1. Turn the vacuum cleaner off and unplug from the electrical outlet.
2. The flexible hose can be disconnected from the vacuum cleaner by turning the hose to the left and pulling away from the machine. Remove any blockages found then reconnect the hose securely.

## 8. Storage

**IMPORTANT:** Always unplug the vacuum cleaner from the electrical outlet and rewind the power cord as directed before storing.

**NOTE:** Always store the vacuum cleaner base down.

## 2. Parts Overview

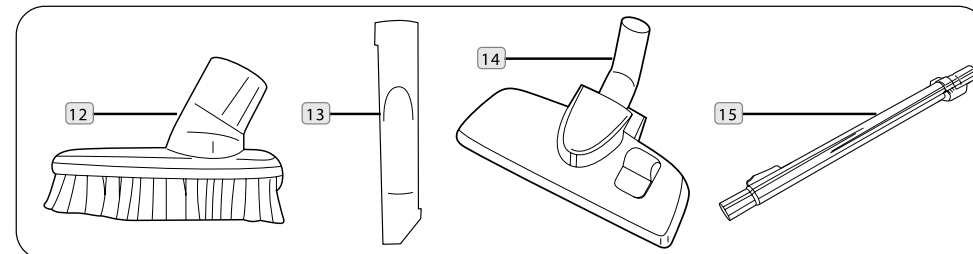
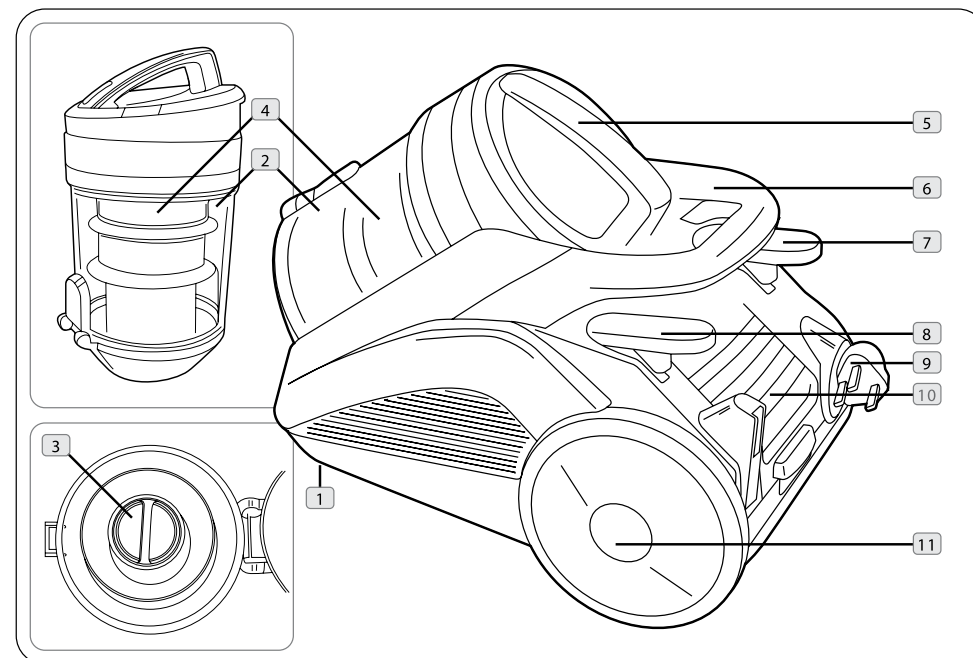
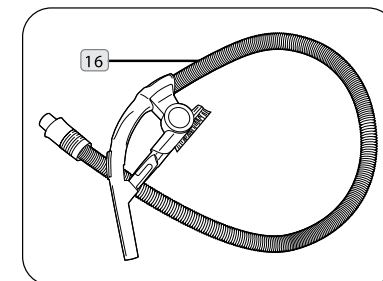

Fig.1/1

- |                         |                            |
|-------------------------|----------------------------|
| 1 Hose inlet            | 10 Post-motor filter cover |
| 2 Dirt container        | 11 Wheel                   |
| 3 Central dust chamber  | <b>Accessories:</b>        |
| 4 Cyclone separator     | 12 2-in-1 tool             |
| 5 Dirt container handle | 13 Crevice tool            |
| 6 Carry handle          | 14 Combination floor head  |
| 7 Auto cord rewind      | 15 Telescopic tube         |
| 8 On/off button         | 16 Hose                    |
| 9 Plug                  |                            |



### 3. How to Assemble

**IMPORTANT:** Always unplug the vacuum cleaner from the electrical outlet before assembling or removing the accessories.

1. Insert the flexible hose (Fig.3/1) into the inlet on the main body of the vacuum cleaner. Making sure the projected parts on the hose are aligned. Turn the hose to the right until it clicks into lock position.

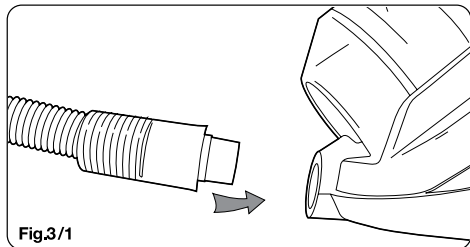

2. Push the telescopic extension tube on to the end of the handle (Fig.3/2).

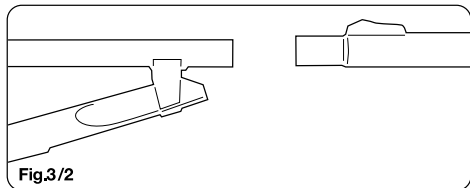

3. The telescopic tube can be lengthened or shortened by pushing the button in and sliding the tube apart or together as required (Fig.3/3).

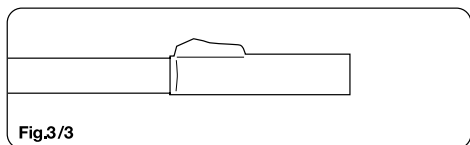

4. Fit the combination floor head by pushing onto the extension tube (Fig.3/4).

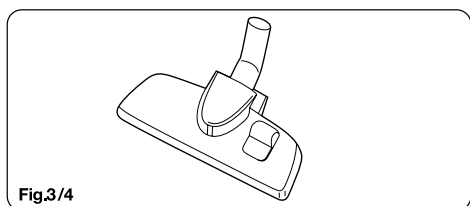

### 4. How to Operate

#### Cord Release

Fully unwind the power cord. A yellow mark on the power cord indicates the recommended cord length. Do not exceed the cord length beyond this mark.

#### On/off Button

1. Insert the plug into the electrical outlet.
2. Press the on/off switch located on the top of the vacuum cleaner, to switch on the vacuum cleaner and press the button again to turn the vacuum cleaner off.

#### Carpet Cleaning

For carpet and rug cleaning, press the rocker switch on the combination floor head to raise the brushes.

#### Hard Floor Cleaning

For hard floor cleaning, press the rocker switch on the combination floor head to lower the brushes.

#### Cord Rewind

To rewind the power cord, press the cord rewind button located on the top of the vacuum cleaner, and guide the power cord with one hand. Rewind 1-1½ metres of cord at a time. This will prevent the cord from whipping which could cause damage or injury.

#### Carry Handle

Use the carry handle located at the rear end of the vacuum cleaner to move from room to room.

#### Hose Storage

For convenience there is a parking slot located at the rear of the vacuum cleaner where the floor tool and hose can be parked for carrying and storage.

### 5. Accessories

1. The accessories can be attached directly to the handle by removing the telescopic tubes and pushing in the desired accessory.
2. The accessories can also be attached to the telescopic extension tube for extra reach. Remove the combination floor head and push on the desired accessory.

#### 2-in1 tool:

Dusting brush: for delicate surfaces  
Upholstery tool: for carpet, upholstery and stairs etc.

**Crevice tool:** for crevices, corners and cracks, etc.

### 6. Dirt Container & Filters: Removal & Replacement

**IMPORTANT:** Always unplug the vacuum cleaner from the electrical outlet before removing the dirt container.

**IMPORTANT:** Do NOT use the vacuum cleaner without ALL of the filters in place.

#### Emptying the dirt container

1. Press down the handle located on the dirt container. When the handle is pressed down to the bottom, the dust barrel can be lifted to remove.

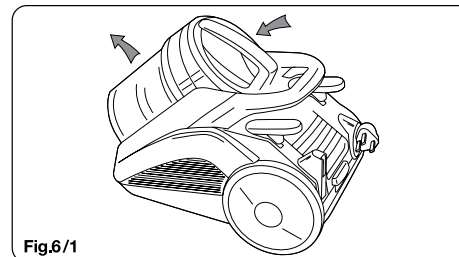

2. Hold the dirt container over a bin and press the quick release button to empty the container (Fig.6/2). When emptied, close the dirt container flap. A click will be heard when closed. Replace the dirt container.

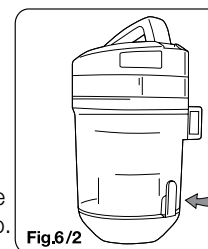

#### Emptying the central dust chamber

**NOTE:** The central chamber must be emptied every time the bin reaches the maximum fill mark.

1. Hold the dirt container over a bin and press the quick release button to empty the container. When empty, hold the bin securely and carefully remove the rubber bung from the centre of the cyclone chamber (Fig.6/3).

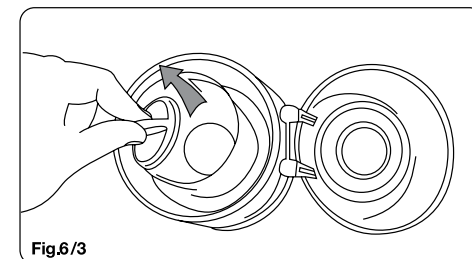

2. Carefully tip the dust out of this compartment into the dustbin (Fig.6/4).

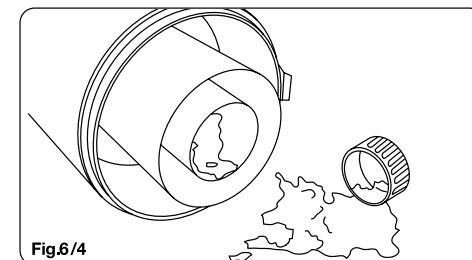

3. Tap and shake the bin to remove all the fine dust from this compartment.
4. Once all the fine dust is removed, carefully replace the rubber bung within the central chamber. Ensure it is fully secured to maintain peak operating performance.

#### Cleaning the cyclone separator

1. Twist and pull the dirt container bin off the cyclonic separator. The dirt container bin may be wiped to clean.
2. The separator should be cleaned with a soft brush and wiped with a damp cloth.
3. Leave the separator to dry completely before replacing.