

vax[®]

easy guide

FOR QUICK AND EASY USE OF YOUR **vax**

CANISTER

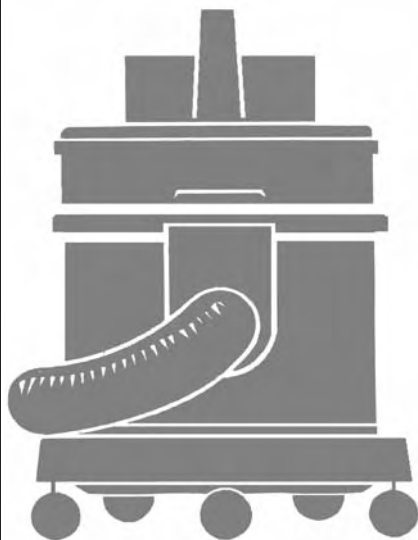

DRY VACUUMS • WASHES CARPETS & UPHOLSTERY • PICKS UP SPILLS • CLEANS HARDFLOORS

VHN

VACUUM CLEANERS

VAX VHN Specifications

VAX VHN SPECIFICATIONS

Weight Net 8.0Kg

Size Height 54cms x 34cms diameter

Motor 1200 watts max. / 450 watts min variable power. 2 stage, heavy duty, bypass motor completely insulated and sealed against water contamination.

Structure Moulded high-impact resistant ABS – a higher grade material than the average car bumper.

Dust Bags Supplied with machine.

Clean Water Reservoir 4 litres of clean water.

Hose 1.8m long, crush resistant hose with 360 (degree) swivels at each end for tangle free cleaning and maximum access.

Recovery Bucket 8 litre capacity.

Please register your warranty. Send in your completed Warranty Card.

If you require any further assistance or advice about your VAX please call VAXCARE on **1300 364040** (cost of a local call)



Vax Appliances (Australia) PTY LTD
A.C.N. 009099736

296 Victoria Road Malaga Western Australia 6090
Telephone: (08) 9247 8100 Fax: (08) 9247 8192
Email: vax@vax.com.au

Important safety Information

THIS 'EASY GUIDE' SHOULD BE READ COMPLETELY AND REFERRED TO AT ALL TIMES BEFORE USING YOUR VAX.

This 'easy guide' should be retained with your VAX for future reference.

If your VAX is sold or transferred to a new owner, this guide should be passed on so that the new owner can become acquainted with the machine and this information. The following information is provided in the interest of safety. Please read it before using your VAX.

DO'S

- Use only genuine Vax parts.
- Use of non Vax fluids, filters and accessories may damage your machine and void your warranty.
- Ensure the mains cable is fully unwound and straightened before use.
- Ensure the mains cable is kept well away from the revolving brushes (where fitted) of your VAX, when it is turned on and running.
- Keep the mains cable away from heat, oil, sharp edges and rough surfaces and avoid damage in any other way.
- Exercise extreme care when cleaning stair carpets. Ensure that your VAX is in a stable position at either the top or bottom of the stairs without over-stretching the hose or cable. When cleaning the stair treads, always keep a hand firmly on your VAX. You may prefer to remove the castors.
- Follow the instructions in this user guide when fitting accessories or tools.
- Remove the plug from the wall socket before carrying out any maintenance specified in this guide.
- Change dust bag and filters at regular intervals as specified on page 19 of this guide.
- Store your VAX in a dry place.
- Have your VAX serviced by an authorised VAX Service Agent only using genuine VAX spare parts.

DON'TS

- This appliance is not intended for use by young or infirm persons without supervision. Never allow children to tamper or play with your VAX.
- Never drag your VAX by the mains cable.
- Never tug at the mains cable to remove the plug from the wall socket.
- Never allow the complete coiled mains cable to drop on the floor as this may result in kinks or knots occurring in the cable, causing premature failure.
- Don't let anyone touch the rotating brush bar (where fitted) unless your VAX is disconnected from the mains.

- Never use your VAX in the presence of flammable gases.
- Avoid sucking up hot items, hazardous liquids or any other material which could damage your VAX.
- Never leave your VAX running unattended.
- Never use your VAX without a dust bag.
- If your VAX fails to operate, never attempt to repair it yourself as repairs carried out by an unauthorised or inexperienced person may cause injury to you or damage to your VAX.
- Never alter the specification or modify your VAX in any way.

EXTENSION CABLE

If using an extension cable always ensure that the insulation sheath is in good condition and is not damaged in any way.

Make sure that the plug and socket are fitted to the extension cable correctly, if in doubt have it checked by a qualified electrician.

Always use the extension cable in accordance with the manufacturer's instructions.

IMPORTANT: When carrying out any maintenance or cleaning operations on this product, it is essential that the plug is removed from the wall socket.

In the interests of product improvement, the Company reserves the right to introduce modifications or alterations without notice.

IMPORTANT

"Vaxing" is a term used to describe the washing of carpets using the unique Vax Cleaning system. Not many people realise just how dirty carpets can become, even when regular maintenance is carried out by owners or professional cleaners. No matter how powerful a vacuum cleaner, dry vacuuming of carpets will only remove surface dirt.

When Vaxing for the first time, many owners are astounded at the amount of dirt and grime this washing system releases from their carpets. Depending on many factors such as age of carpet, neighbourhood conditions (ie. dry, dusty, muddy, sandy) etc., in some instances the release of dirt particles can be so extensive that the carpet becomes discoloured. This is due to the efficiency of the Vax system and is not a malfunction of the unit. With subsequent Vaxing treatments, the discolouration will diminish. For heavily soiled carpets it may take a number of treatments.

Parts checklist

Before using your VAX, please read 'Important safety Information' on page 3.

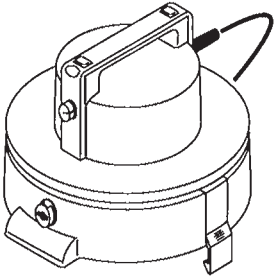

Motor unit

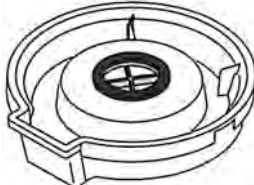

Hepa filter unit

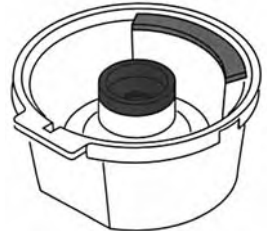

Water reservoir

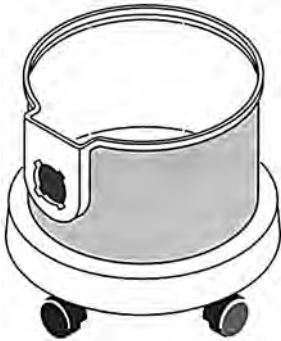

Recovery bucket



Crevice tool

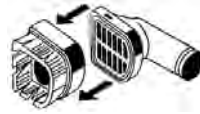

Dual purpose dusting brush & upholstery tool



Upholstery washing tool



Combination tool

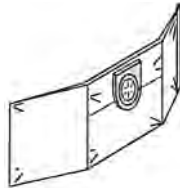

Dust bags



VAX Carpet cleaner



VAX defoamer



Flexible Suction Hose and Hand grip



Stainless Steel Extendable Wand

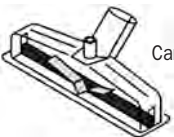

Carpet Washing Tool

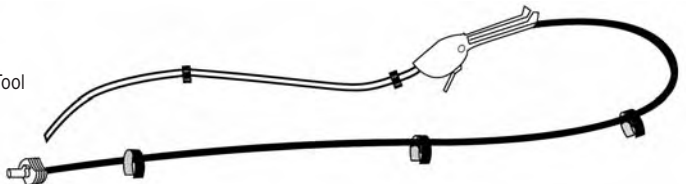

Liquid control Assembly

7 steps for easy vacuuming

1 Fit a dust bag by pushing it firmly into the recovery bucket before connecting hose

2 Push the connector on the end of the hose. Turn it clockwise to lock

3 Fit the filter unit and motor unit

Ensure the two retaining clips are secured. You may have to push down hard on the edges of the motor unit above the clips. They are a tight fit.

4 Fit the extendable wand to the hose hand grip

Adjust to suit by pressing button in direction of arrow which will allow an extension or reduction in wand length.

5 Choose suction power

Vacuum carpets on high power.
Vacuum fabrics and upholstery on low power.
Make sure that the cable is fully unwound.
Put the plug into a wall socket.

6 Choose the right tool for the job

The smaller tools can be fitted to the back of your VAX when not in use.

7 Switch ON



Push the button on the handle marked for on, push again for off.

Tip

- As your VAX is very powerful, you may find that the dust bag fills up quickly the first time you use it.
- Should a blockage occur in the suction hose/hand grip it can usually be "unblocked" by reversing the hose and running the machine for a few seconds or so. It may be necessary to bind the hand grip end of the hose with a cloth or rag to form a temporary seal between the hand grip and the connector socket on the recovery bucket.

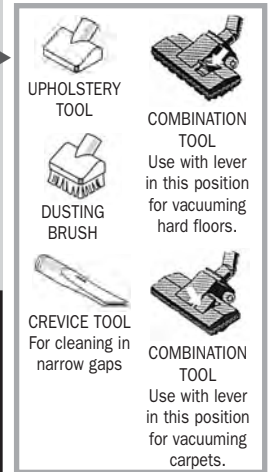
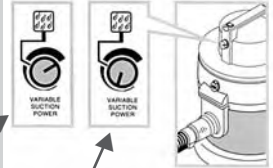
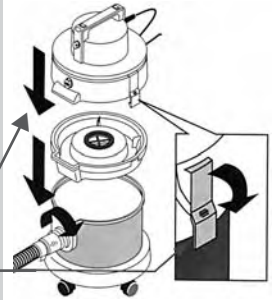

Getting ready to wash

1 Vacuum the area you intend to wash

2 Remove the motor unit, filter unit, hose, dust bag and vacuuming tool

Be careful with the dust bag so as not to spill the contents over your floor

3 When dustbag is removed, re-fit the hose. Push and turn clockwise

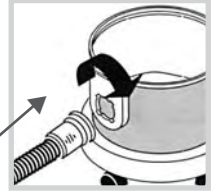

4 Fill the water reservoir with warm water (not hot), to the level marked on it. Fit the water reservoir into the recovery bucket



5 Add VAX Carpet cleaner to the clean water

Refer to the instructions on the carpet cleaner bottle.

Add VAX Defoamer if required

Refer to the Tip on the bottom of this page.

6 Slide the trigger onto the hose handle

- Adjust the extendable wand to suit
- Clip the solution tube to the extendable wand

7 Fit the washing tool and push the solution tube into it

8 Clip the remaining section of solution tube to the suction hose

9 Unclip the transparent tube on the bottom of the motor unit. Place it in the bottom of the washing solution

10 Fit the motor unit (make sure the transparent tube is not trapped when you do this)

Secure both side clips.

11 Locate the tube valve, push in firmly and turn clockwise

YOU ARE NOW READY TO START WASHING

Tip

- You should pour VAX Defoamer into the recovery bucket (through the central hole in the clean water reservoir) if your carpet has been previously washed with a high foaming shampoo.

VAX Defoamer is available through your VAX Stockist

How to wash carpets

1 Set up your VAX as described on page 6

2 Switch ON



3 Switch on the power washing button

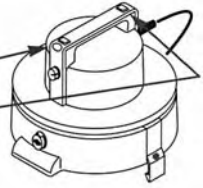

4 Turn the suction power to the wash setting or higher, depending on the carpet pile

2 Metres (6 feet)

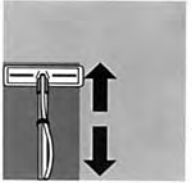

5 Pull the orange trigger to the ON position

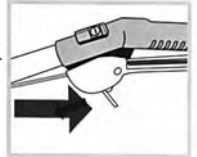

6 When you see water swirling in the washing tool you are ready to start washing

7 Keep the bottom of the washing tool flat against the carpet. Push it backwards and forwards. You are now washing the carpet



8 Cover an area of 2 x 2 metres (6 x 6ft)

9 Turn the pump washing button off and push the orange trigger to the OFF position and turn the suction power to maximum

Go back over the area you have just washed. You are now removing excess moisture from the carpet.

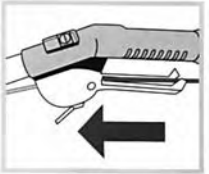

10 Move to the next area and repeat steps 3 to 9

11 When no more water reaches the wash tool the pump will make a 'sound' due to sucking air

Refill the water reservoir with water and VAX Carpet cleaner. Empty the recovery bucket when you refill the water reservoir. The 'sound' your VAX makes will change and the suction will drop if the recovery bucket is over-full. Time to empty it!



Tip

✦ **ALWAYS TEST FOR COLOUR FASTNESS, WITH SOME UNDILUTED CARPET CLEANER ON A HIDDEN AREA FIRST.**

✦ Start from the corner of a room and work backwards towards the door.

✦ If you are washing very dirty carpets, you may have to wash them several times over a period of time to bring all the dirt to the surface.

✦ When washing stairs, place your VAX above the area you are washing. **ALWAYS ENSURE YOUR VAX IS STABLE.** The castors on your VAX will pull off, giving it extra stability on stairs or slopes. **DO NOT PULL EXCESSIVELY ON THE BLACK WASHING HOSE.**

✦ Metal or wooden furniture legs may mark a wet carpet. Wait until the carpet is dry or place aluminium foil under the feet of furniture.

✦ When washing deep pile carpets, move the washing tool in the same direction as the pile lays.

✦ Don't allow children or animals onto the carpet until it is dry.



How to wash upholstery

1 Set up your VAX as described on page 6, BUT don't use the extendable metal wand

2 Connect the upholstery tool to the short metal wand and wind the solution tube around the metal portion of the hand grip and fit the tube into the upholstery washing tool

3 Switch power button ON 

4 Switch on the pump washing button 

5 Turn the suction power to the wash setting

6 Start the washing solution flowing

The solution flow is regulated by leaving the orange trigger in the OFF position and depressing the black manual lever to commence flow.

7 When you see water swirling in the washing tool you are ready to start washing

8 Pull the washing tool backwards

You are now washing the upholstery. Cover a small area at a time. Don't push the tool backwards and forwards as this may stretch the fabric.

9 Stop the washing solution flowing

To stop the flow release the black manual lever. Go back over the area you have just washed. You are now removing excess moisture from the upholstery.

10 Move to next area and repeat steps 6 to 9

11 When no more water reaches the wash tool the pump will make a 'sound' due to sucking air

Refill the water reservoir with water and VAX Carpet cleaner. Empty the recovery bucket when you refill the water reservoir. The 'sound' your VAX makes will change and the suction will drop if the recovery bucket is full. Time to empty it!

Tip

- ✦ Use the upholstery tool for spot cleaning small dirt patches on either carpet or upholstery.

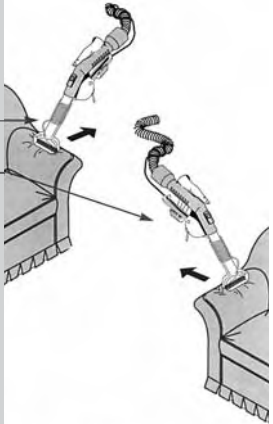
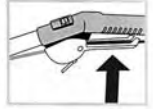
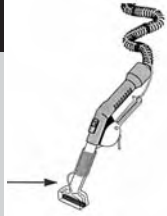
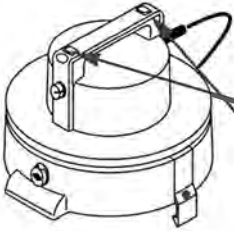

How to: Suck up spills

If your washing machine floods or the deep freeze has been defrosted, leaving pools of water about, your VAX can help

- 1 Set up for washing, but don't connect the solution tube or put water or cleaning solution in the water reservoir**

If the spill is soapy, VAX Defoamer will be required in the recovery bucket. Refer to instructions on Defoamer bottle. You should pour VAX Defoamer in the central hole in the clean water reservoir.

- 2 Use the metal extension tube or extendable wand or connect the washing tool directly to the hand grip**

- 3 Turn the suction power to maximum and switch on**

- 4 Suck up the spill**

The 'sound' your VAX makes will change and the suction will drop when the recovery bucket is full. Time to empty it!



VARIABLE
SUCTION
POWER

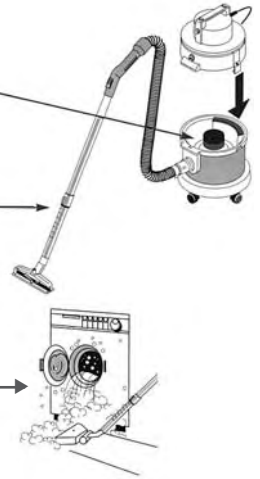

How to: Unblock sinks

- 1 Set up for washing, but don't connect the solution tube or put water or cleaning solution in the water reservoir**

If the water in your sink is soapy, VAX Defoamer will be required in the recovery bucket. Refer to instructions on Defoamer bottle. Pour Defoamer into recovery bucket through the central hole in the clean water reservoir.

- 2 Use the metal tube connected to the hand grip. Wrap a cloth around the tube to create a seal between the tube and the plug hole.**

- 3 Turn the suction power to maximum and switch on**

The 'sound' your VAX makes will change and the suction will drop when the recovery bucket is full. Time to empty it!



VARIABLE
SUCTION
POWER

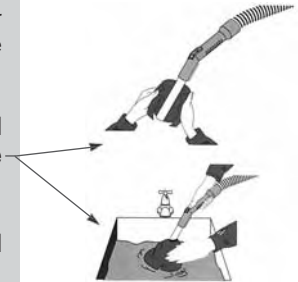

If you have washing difficulties

IF YOU HAVE WASHING DIFFICULTIES, CHECK...

- 1 The pump washing button is switched on
- 2 The tube valve is properly connected
- 3 The weight on the end of the solution tube is at the bottom of the water reservoir and not trapped between motor unit and water reservoir
- 4 The trigger is switched to on
- 5 The washing tool is flat on the surface being washed
- 6 Ensure the power control is correctly adjusted within the washing range. Turn higher than minimum wash setting for uneven or higher pile if required
- 7 There are no kinks in the solution tube
Remove kinks by rubbing the tube between finger & thumb
- 8 That the recovery bucket is not full, causing the automatic cut off valve to stop the suction

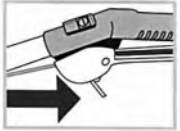

What to do after washing

AFTER WASHING – ALWAYS...

Clean your VAX thoroughly

Keep your VAX assembled. Clean the washing tool, stainless steel wands and hose, by sucking up some clean warm water. After sucking up the water, leave your VAX switched on. Air flowing through the hose will help dry it out.

AFTER WASHING – REGULARLY...

Clean out the carpet washing tool

Push down on the transparent tube connector, the clear plastic insert will drop out.

The black plastic strip can also be pushed out using a screwdriver or similar tool. Always insure that it is replaced the right way up as shown.

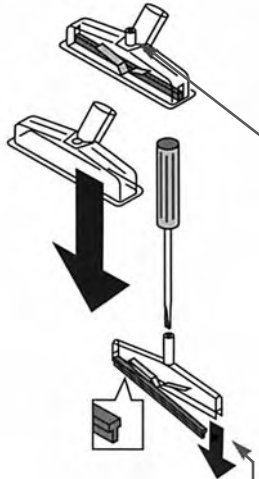

Looking after your VAX

Items below are available from your Vax Retailer or Vax direct.

Paper dust bag – Available in packs of 5

Cloth dust bag – For heavy duty use. These bags can be cleaned up to 5 times

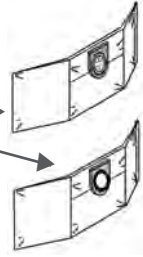

1 Cone filter – The bonus Cone Filter (supplied at no extra cost with the pack of 5 paper bags) is not necessary with the HEPA Filtration system. Fitting the Cone Filter underneath the HEPA Filter will compromise the integrity of the HEPA Filter seal and reduce filtration performance.

2 Dust bags – If you find your disposable paper bag becomes perforated as a result of overfilling, or sucking up a sharp or heavy object, dust may pass through the sock filter to the HEPA Filter. If this happens, both the sock and HEPA Filters should be cleaned as recommended (see below).

3 HEPA filter – HEPA is an abbreviation for “High Efficiency Particle Arrestor”. Your HEPA filter is manufactured from pleated glass paper, the efficiency for which is specified under International Standards.

To remove the HEPA Filter turn anticlockwise to disengage the four locating lugs. When replacing ensure all four lugs are secured in position.

While the pre-HEPA Sock Filter acts as a major barrier to dust penetration, over a period of time smaller particles will penetrate the sock and reduce the overall performance of the HEPA Filter.

With the sock removed, the HEPA Filter can be cleaned by gently tapping on a hard surface. The HEPA Filter should never be washed or exposed to water.

We would recommend that the HEPA Filter be replaced at 12 monthly intervals to maintain peak performance.

4 Pre-HEPA filter (sock filter) – The SMS (grey) Sock Filter acts as a pre-filter to the HEPA and protects it from the majority of dust.

To clean the Sock Filter gently peel it back from the HEPA Filter.

After shaking to remove the excess dirt, the Sock Filter can be safely hand washed at normal temperature and left to dry. Do not machine wash or tumble dry. Do not replace the sock when it is still damp or wet.

When replacing the Sock Filter on the HEPA ensure that the sock is pulled down completely all round.

The Sock Filter can be cleaned up to 5 times in this way and should then be replaced.

5 Clean the black exhaust filter – Available with a cone filter and Bondini (blue) filter in a 3 filter pack

Push upwards on the plastic grille, it will release. Pull it out.

Take out the filter and wash it in warm water.

Squeeze it dry and replace it. Replace the grille.

Your VAX will work more efficiently if the black exhaust filter is replaced with a new one occasionally.

Replacement filters are available from your VAX Stockist.

6 Clean the Bondini (blue) filter – Available with a cone filter and exhaust filter in a 3 filter pack

The Bondini filter is on the bottom of the motor unit.

Pull it out and wash in warm water.

Squeeze it dry and replace it.

Your VAX will work more efficiently if the Bondini filter is replaced with a new one occasionally.

Replacement filters are available from your VAX Stockist.

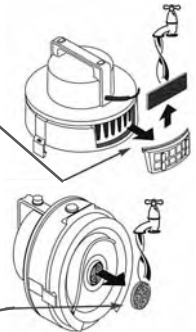
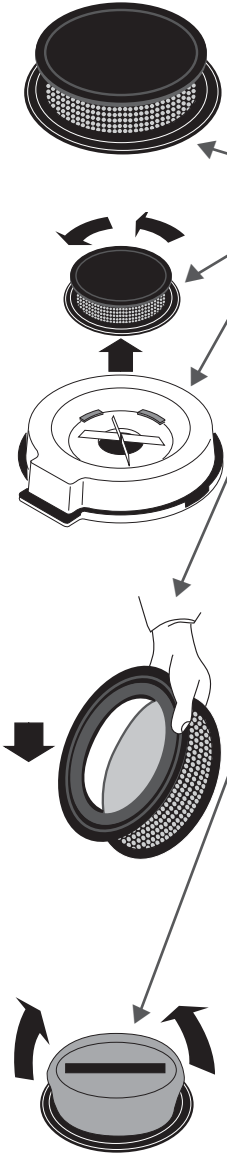

VAX fluids, accessories and filters

VAX Cleaning Solutions



Carpet Cleaner

- Tough on germs
- Kills odour causing bacteria
- Excellent disinfecting and stain removing properties
- Fabric Softener
- Deodoriser

Carpet Spot Cleaner

- Contains disinfecting and stain removing agents
- Fabric Softener
- Deodoriser



Defoamer

- Reduces excessive foaming
- For use in all 3 and 1 machines

Multi Surface Hardfloor Cleaner

- Biodegradable
- Deodorising cleaner
- Stain removing agents
- Suitable for tiles, vinyl and slate
- Suitable for VAX SAHARA and VAX Autmop



Hardfloor Wipe

- Biodegradable
- Deodorising cleaner
- Stain removing agents
- Streak free

Accessories below are not supplied with this model.



Turbo Brush

Attach the Turbo Brush vacuuming tool to the extension tubes of your VAX. Switch on and the brush bar inside will rotate at high speed dislodging trapped dust or hair from within the carpet pile. The automatic air adjustment feature allows air to drive the brush bar for effective cleaning on light or heavy pile carpets.

Ultra Rapide Washing Head

The Ultra Rapide Washing Head glides effortlessly over carpet with its flat full-swivel design, and reaches under furniture with absolute ease.



Automop

Attach the Automop to the extension tubes of your VAX. The Automop cleaning head, washes and dries hard floors. Suitable for vinyl, ceramics, terrazzos, quarry tiles and most other sealed hard floor surfaces.

Hardfloor Brush

Optional tool that thoroughly cleans all hardfloor surfaces including vinyl, tiles and ceramics. The stiff bristles ensure dirt and dust is sought out in every crevice, leaving floors clean and dust free.



VAX Filter Packs Available from your VAX Stockist.

Disposable Paper Bags Pack of 5



P/N 90600

Replacement Cloth Bag Pack



P/N 90620

Moulded Cone Filter Pack of 2



P/N 20310

Replacement 3 Filter Pack



P/N 90630