



we  clean

User Guide

Vax Service line AU: 1300 361 505

NZ: 0800 800 900

Steam Mop



we  clean

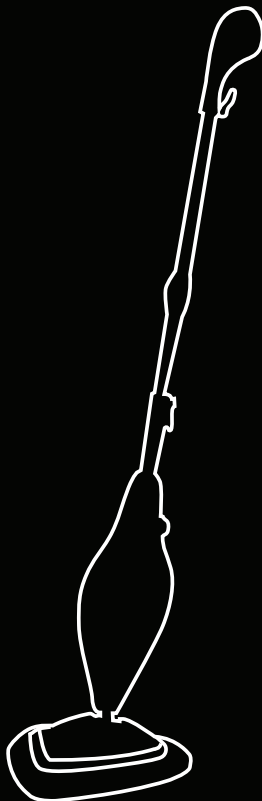

Get Cleaning...

What's your Vax's model number?

V M S M 1 5 0 0

What's your serial number? (Located on the base of the machine)

■ - ■ ■ ■ ■ ■ - ■ ■ - ■ ■ - ■ ■ - ■ ■ ■ ■ ■ ■ ■ ■

Note these down in case you need them in future. Please keep instructions for further use.

www.vax.com.au

VMISM1500

Machine Overview

- 1 Ergonomic Hand Grip
- 2 Quick-Release Upper Cord Wrap
- 3 Telescopic Handle
- 4 Telescopic Handle Lock
- 5 Locking Metal Pin
- 6 Lower Cord Wrap
- 7 Pin Set Hole
- 8 Lower Body
- 9 Water Tank Cap (roped)
- 10 Steam Pump Switch
- 11 Water Tank Viewing Window
- 12 Green/Red Indicator Light
- 13 Water Tank
- 14 Mop Head
- 15 Power Cord
- 16 2 Microfiber Cleaning Pads

Accessories

- 17 Funnel
- 18 Water Fill Cup
- 19 Carpet Glider
- 20 Resting Pad
- 21 Dusting Pad

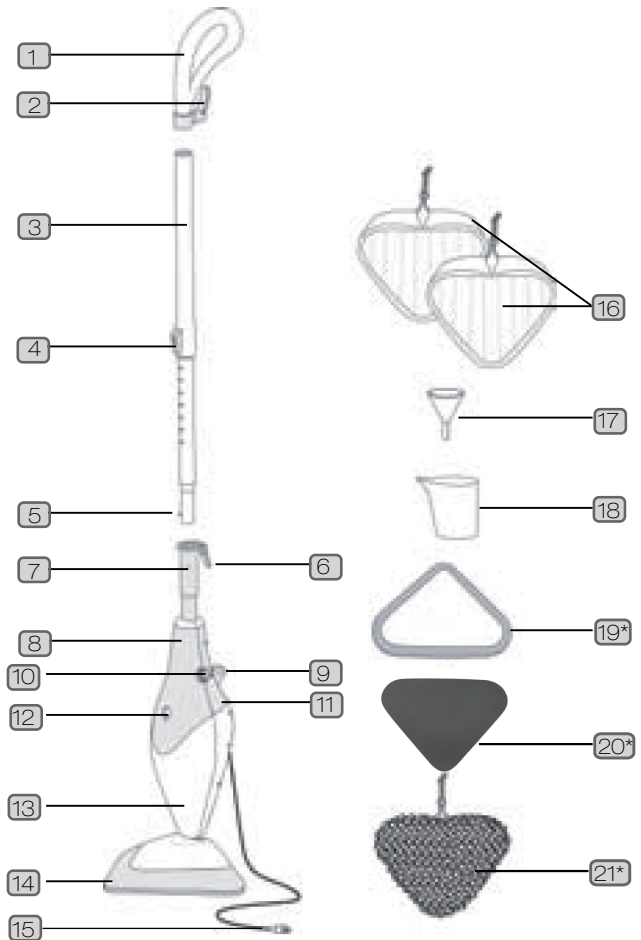

General Safety Information

FOR HOUSEHOLD USE ONLY.

When using the steam mop, basic safety precautions should always be observed, including the following:

1. Turn off the steam mop controls before disconnecting or connecting from the mains supply.
2. Always unplug the steam mop before connecting or disconnecting the vacuum hose and accessories.
3. Children should be supervised to ensure that they do not play with the appliance.
4. This appliance is not intended for use by persons (including children) with reduced physical, sensory or mental capabilities, or lack of experience and knowledge, unless they have been given supervision or instruction concerning use of the appliance by a person responsible for their safety.
5. Use only as described in this manual. Use only Vax recommended attachments.
6. Do not use the steam mop if it has been dropped, damaged, left outdoors or dropped into water. Do not use the steam mop with a damaged cord or plug. If the supply cord is damaged, it must be replaced by the manufacturer, its service agent or similarly qualified persons in order to avoid a hazard.
7. Do not pull or carry by cord. Do not use the cord as a handle, close a door on the cord or pull cord around sharp edges or corners. Do not run the steam mop over the cord. Keep the cord away from heated surfaces.
8. Do not handle the plug or steam mop with wet hands. Do not use outdoors or on wet surfaces.
9. Do not put any objects into openings. Do not use with any openings blocked and do not restrict airflow. Keep all openings free of dust, lint, hair or anything that might reduce airflow.
10. Keep hair, loose clothing, fingers and all parts of the body away from openings and moving parts.
11. Do not steam clean harmful or toxic material (chlorine, bleach, ammonia, drain cleaner etc.).
12. Keep cleaning area well lit.
13. Store the steam mop in a cool, dry area.
14. Turn off the on/off switch before unplugging the steam mop.
15. Symbol IEC 60417-5597 (2002-10)  is used on the unit to indicate the following:

 **WARNING:** Danger of Scalding

 **WARNING:** Always switch off and unplug the steam cleaner from the electrical outlet before assembling, opening or emptying the water container, or before connecting/disconnecting the attachments.

 **CAUTION:** The steam cleaner is a very powerful unit. Before plugging the cord into the electrical outlet, make sure the switch is in the 'off' position. Hold the steam cleaner firmly when starting and in use.

 **IMPORTANT:** We recommend the use of a Residual Current Device with a Residual Current rating of 30mA or less.

 **WARNING:** Never leave the steam mop in one spot on any surface for an extended period of time as this may damage the floor surface. Always return the mop back to the resting pad when not in use or when not continuously moving across the floor.

 **IMPORTANT:** This steam mop may not be suitable for all floating floorboards - please check with your floorboard manufacturer first prior to use.

This steam cleaner is intended for household use only and NOT for commercial or industrial use.

PLEASE KEEP INSTRUCTIONS FOR FURTHER USE.

Operation

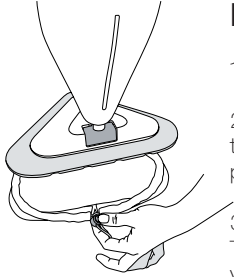

Before using for the first time

1. Carefully unpack the Steam Mop.
2. Remove all parts from the carton and familiarize yourself with all of the components listed. Make sure all components and accessories are present before discarding packing materials.
3. Attach the cleaning pad by fitting the mop head into the cleaning pad. Tighten the cleaning pad by pressing the circular lock in one hand, while pulling the black drawstring with the other. When a tight fit is achieved, release the lock to secure in place.

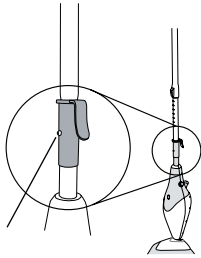

Assembly

1. The Steam Mop comes in 2 pieces: telescopic upper handle and the lower body.
2. To assemble the Steam Mop for first time use, locate and line up the locking metal pin on the bottom of the telescopic handle with the pin set hole on the top of the lower body.
3. Depress the metal pin to insert the telescopic handle into the lower body. Push firmly until the locking pin pops up through the hole and locks into place.

NOTE: The fit will be tight.

Operation

How to use

NOTE: In hard water areas, or to prevent calcium and mineral deposits from accumulating on the heating element and mop head, you may use distilled or demineralized water in place of tap water.

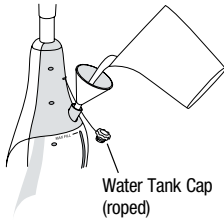

1. Always make sure the Steam Mop is unplugged.
2. Make sure the microfiber cleaning pad is properly attached to the mop head. And install following the procedure described in the (Before Using for the First Time) section of this Instruction Manual.

WARNING: NEVER USE THE STEAM MOP WITHOUT THE MICROFIBER CLEANING PAD PROPERLY ATTACHED.

3. Turn the water tank cap counter-clockwise to open. Lift roped cap up and off the tank.
4. Using the water fill cup and funnel, pour one full cup into the water tank (cold tap water is sufficient).
CAUTION: Check the water tank viewing window to make sure water level does not exceed the MAX fill line. DO NOT OVERFILL.
5. Replace the water tank cap. Turn clockwise to tighten until tight.
6. Once you have filled the water tank to the MAX fill line, place the steam mop onto the carpet glider and resting mat provided.
This helps to protect the flooring surface whilst the mop is heating up to the required temperature and also when the mop is not in use. Never leave the steam mop in one spot on any surface for an extended period of time as this may damage the floor surface.



Place steam mop onto resting pad inside the carpet glider attachment

How to use on floors

IMPORTANT: Never use the Steam Mop without the microfiber cleaning pad properly attached to the mop head.

IMPORTANT: Check the water tank viewing window to ensure there is adequate water in the water tank.

IMPORTANT: Do not put solutions or detergents into the water tank. This machine operates with water & steam only.

IMPORTANT: This steam mop product may not be suitable for cleaning floating floorboards due to the moisture released when in use. Please check with your floating floor board manufacturer first before using this product to avoid any damage or warranty issues with your flooring.

Operation

1. For best results, thoroughly sweep or vacuum floor(s) prior to cleaning with the Steam Mop.
2. Twist the quick-release upper cord wrap to either side and unwrap the power cord completely.
3. Lengthen the telescoping handle by pushing the lock forward and then pulling the handle out to extend to the desired length.
4. Plug the unit into a 240V AC electric outlet. The indicator light will illuminate green.
5. Press the steam pump switch to the ON (I) position. After 30 seconds, an audible hissing noise can be heard as the unit heats and steam production begins. Steam will wet microfiber cleaning pad.
6. Tilt the ergonomic handle to a 45-degree angle and clean the floor area slowly. For best results: The cleaning pad should be changed when it gets too wet or if it is noticeably dirty.
7. Pay attention to the water tank's viewing window to monitor remaining water/steam. As the water tank empties, a special water sensor will cause the unit to work intermittently and eventually stop running in order to protect the pump inside the unit. A vibrating sound may be heard, and the green/red indicator light will turn red. The pump will turn OFF.

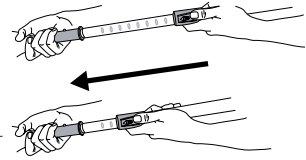

WARNING:

Never leave the Steam Mop in one spot on any surface for an extended period of time as this may damage the floor surface. Always return the mop back to the resting pad when not in use or when not continuously moving across the floor.

8. Press the steam pump switch to the OFF (O) position. Unplug the Steam Mop.
9. Refill the water tank using the water fill cup and funnel as previously described. (How To Use).
Return mop back to resting pad whilst refilling the water. The indicator light will change to green.
Continue steam cleaning.
10. When cleaning with the Steam Mop is completed, press the steam pump switch to OFF (O).
Unplug the unit from the electrical outlet.
11. Carefully remove the microfiber cleaning pad from the Steam Mop head.

CAUTION:

Cleaning pad and mop head may be hot.

IMPORTANT:

Do not store unit with a damp or wet microfiber cleaning pad attached.

Operation

How to use on carpets?

Your Steam Mop is designed to clean carpets or rugs that will withstand high heat. Be sure to check the Use and Care Instructions from the carpet manufacturer before steam cleaning.

WARNING:

The carpet glider accessory is for use on carpeting and rugs only. Use of the carpet glider on other floor will cause streaking and possible scratching of the floor's surface.

IMPORTANT:

Never use the Steam Mop without the microfiber cleaning pad properly attached to the mop head.

IMPORTANT:

Check the water tank viewing window to be sure there is adequate water in the water tank.

For best results, thoroughly vacuum the carpets or rugs prior to steam cleaning.

1. Place the mop head (with microfiber cleaning pad in place) on top of the carpet glider.
2. Do not attempt to use the Steam Mop on carpet/rug surfaces without the carpet glider in place!

CAUTION:

Never use the carpet glider on surfaces that are prone to scratching.

CAUTION:

The Steam Mop emits steam and creates moisture.

If the Steam Mop operates too long in one place, water marks can result.

Steam clean carpets or rugs using the detailed instructions outlined in the (How To Use On Carpets) section.

Maintenance (Keep your Vax as good as new)

General maintenance

This appliance requires little maintenance. It contains no user serviceable parts. Do not try to repair it yourself. Any servicing that requires disassembly other than cleaning must be performed by a qualified appliance repair technician.

Microfiber cleaning pads care & cleaning

To ensure long life and continued cleaning ability, proper care of your microfiber cleaning pad is required. Read and follow cleaning instructions.

1. Microfiber cleaning pads can be machine washed in warm water with a mild detergent after each use or when dirty.

CAUTION:

Never use bleach or fabric softener.

IMPORTANT:

Only use liquid detergent or soap.

2. Air dry pads for 24 hours.

NOTE: Cleaning pads may be machine tumble dried on low heat.

3. To avoid passing or picking up lint from the cleaning pads, wash the microfiber cleaning pads separately or place them in a garment bag.

IMPORTANT:

Wash microfiber cleaning pads regularly. As with any fabric, dirt particles can cause the fibers to break down. Therefore regular cleaning will help preserve the cleaning efficiency of the microfiber cleaning pads.

4. As the microfiber cleaning pad is used, sometimes a thread will loosen or pull out. This is normal. Never pull loose threads as this can cause the weave to come undone. Simply trim any loose threads with a pair of sharp scissors.

5. Dusting Pad can be cared for and cleaned in same manner as microfiber pads.

Care & cleaning

1. Always unplug and allow the Steam Mop to cool completely before cleaning or moving.
2. Press the round black lock and pull it downwards to loosen the microfiber cleaning pad's drawstring.

3. CAUTION:

Carefully remove the cleaning pad from the mop head, as mop pad and lower assembly may be hot.

4. Any water remaining in the water tank should be emptied before storing the Steam Mop.
5. Wipe all exterior surfaces of Steam Mop with a damp or dry, soft cloth.

Storage

1. Never store the Steam Mop while it is still plugged in. Remove the plug from the electrical outlet.
2. Empty water from the water tank before storing.
3. Twist the quick-release upper cord wrap to face upwards. Wrap cord for storage.
4. Store upright in a protected, dry area. Keep water fill cup and funnel handy for future use.

FAQs



WARNING: to reduce the risk of personal injury, unplug the steam mop before performing maintenance/troubleshooting checks.

PROBLEM	POSSIBLE REASON	POSSIBLE SOLUTION
Reduced steam or no steam	1. Water tank is empty	1. Fill water tank 2. AU: 1300 361 505 / NZ: 0800 800 900
	2. Steam pump not on	2. Turn on
Steam Mop worked intermittently and then stopped	1. Not enough water in the tank	1. Fill water tank
The indicator light is red	1. Water tank is empty	1. Fill water tank
Cleaning pad is very wet and no longer picking up dirt from the floor or carpet	1. Cleaning pad is saturated	1. Change pad
Steam mop left white spot on floor	1. Steam mop left in one spot too long 2. Hard Water	1. Never leave the steam mop on the floor with a damp or wet cleaning pad still attached when not in use. 2. Use distilled water.



we  to help

Don't take your machine back to the shop, simply contact us

www.vax.com.au AU: 1300 361 505
NZ: 0800 800 900

Other Information

Vax Service & Help

Vax Customer Careline AU: 1300 361 505 / NZ: 0800 800 900

Monday-Friday 8.30am to 5.30pm

Any queries or concerns about using the Vax, call the Vax Careline. Calls are charged at the Standard national rate.

Please make a note of the serial number and model number of the carpet cleaner before calling. For the nearest Service Agent, please call the Vax Customer Careline or visit www.vax.com.au

Technical Specification

Voltage: 220-240V ~50Hz

Wattage: 1500w

Water

Capacity: 250ml

Variable

Steam: 25g/min

Cord length: 5.2m

Heating time: 30 seconds

Weight: 2.06kg

1 YEAR LIMITED WARRANTY



N197



Notes

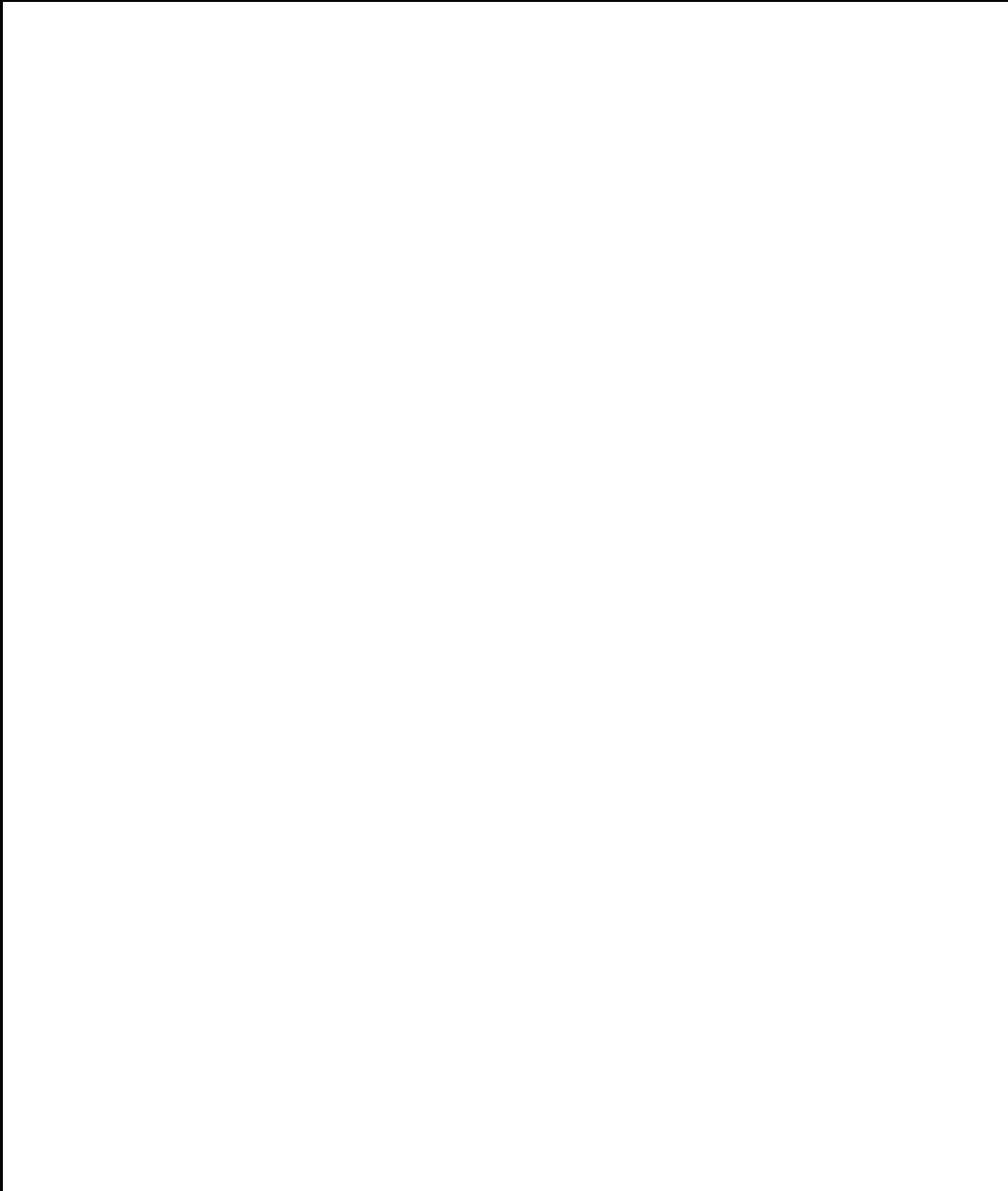



we  clean

Distributed by Techtronic Industries Pty. Ltd.
Level 1, 666 Doncaster Rd, Doncaster, Australia 3108.
www.vax.com.au. Service Line: AU: 1300 361 505 / NZ: 0800 800 900