

VAXCARE

Please register your warranty. Send in your completed Warranty Card.

If you require any further assistance or advice about any

VAX please call VAXCARE on

1300 36 4040 (Australia - cost of a local call)

and **0800 800 900** (NZ)



VAX Appliances (Australia) Pty Ltd
A.C.N. 009099736

296 Victoria Road Malaga Western Australia 6090.

EMAIL: vaxcare@vax.com.au

WEBSITE: www.vax.com.au

vax AUST. & NZ BRANCHES

• NSW/ACT

Unit 2, 239 Beaconsfield St,
Milperra, NSW 2214
Telephone: (02) 9792 8900
Facsimile: (02) 9792 8911

• VICTORIA/TASMANIA

Unit 3, 46 Burgess Road,
Bayswater North, VIC 3153
Telephone: (03) 9761 7160
Facsimile: (03) 9761 7175

• SOUTH AUSTRALIA/ NORTHERN TERRITORY

Unit 3, 75-77 Grange Road,
Welland, SA 5007
Telephone: (08) 8340 2222
Facsimile: (08) 8346 7933

• QUEENSLAND

186 Kerry Road,
Archerfield, QLD 4108
Telephone: (07) 3216 7350
Facsimile: (07) 3216 7375

• WESTERN AUSTRALIA

296 Victoria Road,
Malaga, WA 6090
Telephone: (08) 9247 8100
Facsimile: (08) 9247 8192

• VAX APPLIANCES NEW ZEALAND

27 Clemow Drive
Mt Wellington, Auckland
Telephone: (09) 5736220
Facsimile: (09) 5736224
Email: vaxnz@vax.co.nz



www.vax.com.au

vax pro
dry vac

V-100 BAGGED CANISTER
VACUUM CLEANER WITH
HEPA FILTRATION

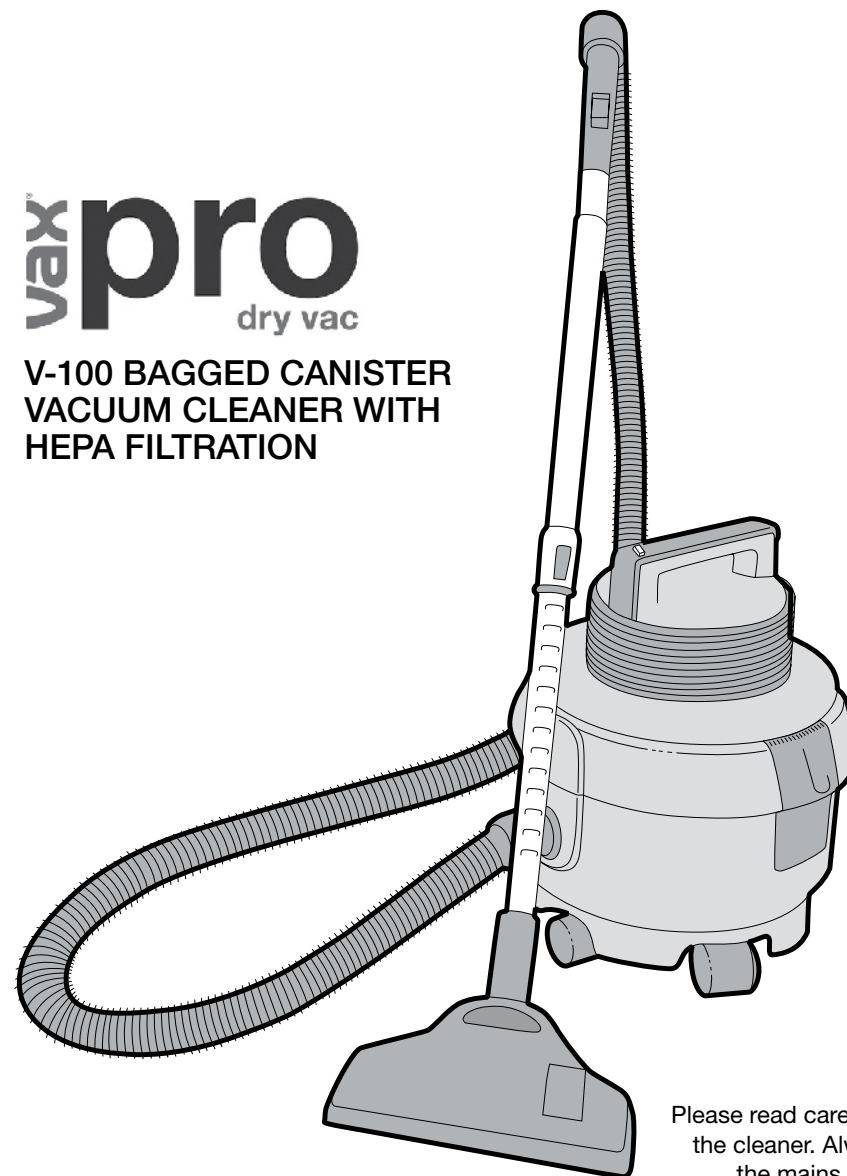

Please read carefully before using
the cleaner. Always fully unwind
the mains cable before use.

Instruction Manual

1. Components Diagram

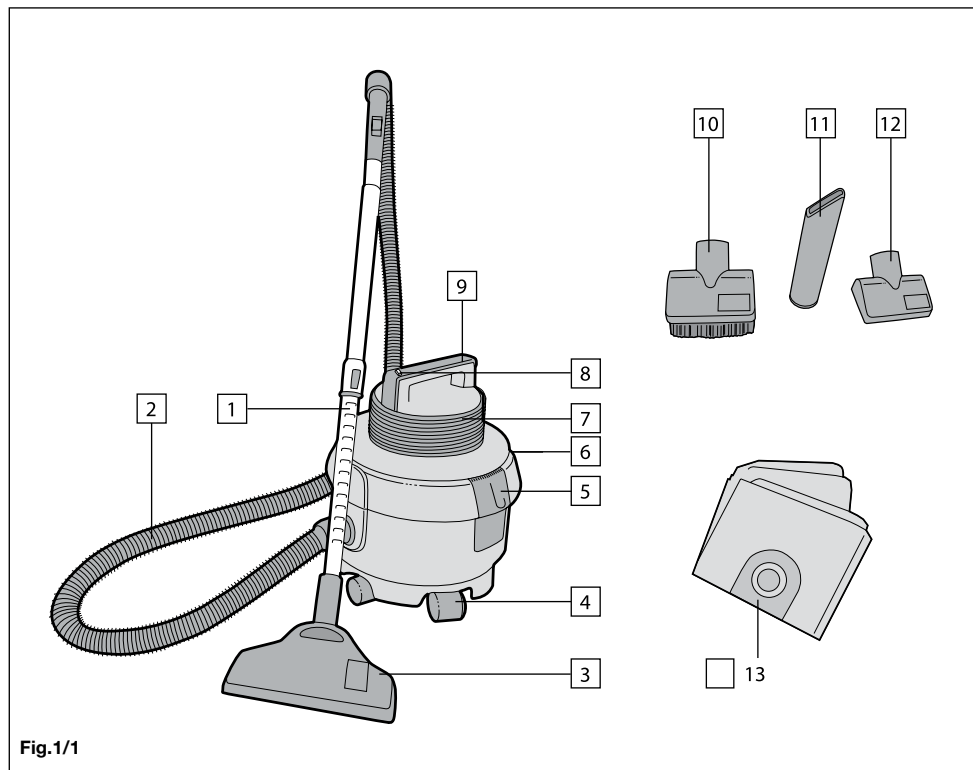

Fig.1/1

- 1 Telescopic extension tube
- 2 Flexible hose
- 3 Combination floor tool
- 4 Castor wheels
- 5 Top cover retainer clips
- 6 Post-motor filter (at rear)
- 7 Power cord
- 8 On/off button
- 9 Carry handle
- 10 Dusting brush
- 11 Crevice tool
- 12 Upholstery tool
- 13 Dust bags (x5)

Technical Specification

Voltage:	220-240V~50Hz
Wattage:	1200W
Capacity:	10 litre paper bags
Filters:	Pleated paper HEPA pre-motor filter Pleated paper HEPA post-motor filter
Cord length:	9 metres
Weight:	6.77 kg
Part No:	31000

Subject to technical change without notice.

IMPORTANT: The accessories are stored in the dust bag compartment and need to be removed before operating the vacuum cleaner.

3. Remove the post-motor filter (Fig.7/8).

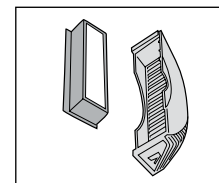

Fig.7/8

4. The post-motor filter should be replaced every 9-12 months.

8. Clearing Blockages

1. Switch the vacuum cleaner off and disconnect the power plug from the electrical outlet.
2. The flexible hose can be disconnected from the vacuum cleaner by rotating anti-clockwise and pulling away from the machine (Fig.8/1). Remove any blockages found then reconnect the hose securely.

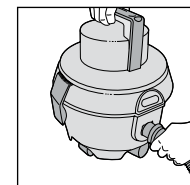

Fig.8/1

9. VAXCARE Service & Help AUSTRALIA 1300 36 4040 NEW ZEALAND 0800 800 900

Any queries or concerns about using the Vax, call VAXCARE.

Please make a note of the serial number and model number of the appliance before calling. (Aust only: Mon-Fri. 10.00am to 6.00pm. EST) Calls are charged at the local rate. An answerphone is available out of these hours.

There are over 300 approved Vax Service Agents in Australia and New Zealand. For the nearest Service Agent, please refer to your Vax warranty or call VAXCARE or visit www.vax.com.au

10. Replacement Bags & Filters

Replacement dust bags and filters are available from your Vax stockist or Vax direct. Phone Vaxcare or visit: www.vax.com.au

11. Troubleshooting

WARNING: TO REDUCE RISK OF PERSONAL INJURY, UNPLUG VACUUM CLEANER BEFORE SERVICING

PROBLEM: Cleaner won't run

Cause: Not properly plugged into electrical outlet.

Solution: Plug in firmly.

Cause: On/off switch not turned on.

Solution: Push on/off switch to on.

Cause: Motor thermostat has tripped.

Solution: Switch off and unplug cleaner. Leave for one (1) hour before switching the cleaner back on.

PROBLEM: Vacuum cleaner won't pick up/loss of suction

Cause: Dust bag not installed correctly.

Solution: Review dust bag removal and replacement.

Cause: Dust bag full or blocked.

Solution: Replace dust bag.

Cause: Clogged filter.

Solution: Remove filter and clean.

Cause: Blockage in hose.

Solution: Disconnect hose, remove obstruction then re-fit.

PROBLEM: Accessories won't pick up

Cause: Accessories not attached correctly.

Solution: Refer to page 5 for fitting information.

Cause: Accessories clogged.

Solution: Remove blockage.

PROBLEM: Dust escaping from the vacuum cleaner

Cause: Dust bag full.

Solution: Dispose of dust bag and replace with a new one.

Cause: Dust bag not installed correctly.

Solution: Review dust bag removal and replacement.

Cause: Hose not installed correctly.

Solution: Review hose installation.

Cause: Filter not installed completely.

Solution: Review filter removal and replacement.

7. Dust Bag & Filters: Removal & Replacement

IMPORTANT: Always unplug the vacuum cleaner from the electrical outlet before removing the dust bag.

IMPORTANT: DO NOT use the vacuum cleaner without ALL of the filters in place.

1. Turn off the vacuum cleaner and unplug it from the mains. Remove the hose. Unclip the retainer clips on either side of the vacuum cleaner and lift off to gain access to the dust bag compartment (Fig.7/1).

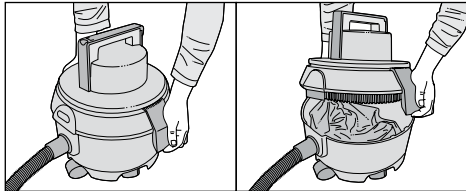

Fig.7/1

2. Lift out the full dust bag (Fig.7/2).

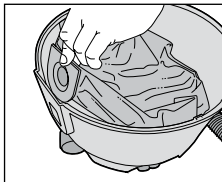

Fig.7/2

3. Dispose of the full dust bag and insert a new dust bag back into the vacuum cleaner aligning the front of the dust bag with the inlet slots (Fig.7/3).

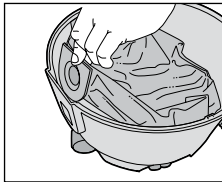

Fig.7/3

Pre-motor Filter

1. Turn off the vacuum cleaner and unplug it from the mains. Unclip the retainer clips on either side of the vacuum cleaner and lift off to gain access to the dust bag compartment (Fig.7/4).

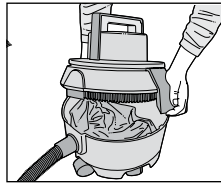

Fig.7/4

2. The pre-motor filter is found on the underside of the top cover. To release the filter turn the cover anti-clockwise and lift away (Fig.7/5).

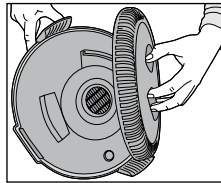

Fig.7/5

3. The pre-motor filter is protected by a foam filter sleeve. This can be washed using cold water, leaving it to fully air dry before replacing (Fig.7/6).

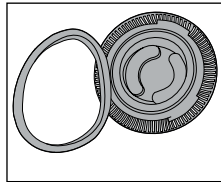

Fig.7/6

4. The pre-motor filter should be replaced every 9-12 months.

Post-motor Filter

1. Located at the rear of the vacuum cleaner is a post-motor filter which can also be removed and replaced.

2. Push in on the latches on both sides of the filter cover to release post-motor filter (Fig.7/7).

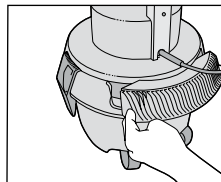

Fig.7/7

2. Safety Information

FOR HOUSEHOLD USE ONLY

When using the vacuum cleaner, basic safety precautions should always be observed, including the following:

1. Only use the vacuum cleaner indoors on dry surfaces.
2. Turn off the vacuum cleaner controls before connecting to or disconnecting from the mains supply.
3. Always unplug the vacuum cleaner before connecting or disconnecting the vacuum hose.
4. This appliance is not intended for use by young or infirm persons unless they have been adequately supervised by a responsible person to ensure that they can use the appliance safely. Young children should be supervised to ensure that they do not play with the appliance.
5. Use only as described in this manual. Use only the manufacturer's recommended attachments.
6. Do not use the vacuum cleaner if it has been dropped, damaged, left outdoors or dropped into water. Do not use the vacuum cleaner with a damaged cord or plug. If the supply cord or plug is damaged, return the vacuum cleaner to a Vax Authorised Service Agent for examination, repair or adjustment.
7. Do not pull or carry by the cord. Do not use the cord as a handle, close a door on the cord or pull the cord around sharp edges or corners. Do not run the vacuum cleaner over the cord. Keep the cord away from heated surfaces.
8. Do not handle the plug or vacuum cleaner with wet hands. Do not use outdoors or on wet surfaces or to vacuum up fluids.
9. Do not put any objects into openings. Do not use with any openings blocked and do not restrict air flow. Keep all openings free of dust, lint, hair or anything that may reduce airflow.
10. Keep hair, loose clothing, fingers and all parts of the body away from openings and moving parts.
11. Do not pick up hot coals, cigarette butts, matches or any hot, smoking or burning objects.
12. Do not pick up flammable or combustible materials (lighter fluid, petrol, kerosene, etc) or use in the presence of explosive liquids or vapours.

13. Do not vacuum up harmful or toxic material (chlorine bleach, ammonia, drain cleaner, etc).

14. Do not vacuum up hard or sharp objects such as glass, nails, screws, coins, etc.

15. Do not use without the filters in place.

16. Take extra care when vacuuming on stairs.

17. Keep vacuuming area well lit.

18. Store the vacuum cleaner indoors in a cool, dry area.

19. Turn off the switch before unplugging.

20. Use only approved extension cords.

Non-approved extension cords may overheat. Care should be taken to arrange the cord so that the cord cannot be pulled or tripped over.

WARNING: Always switch off and unplug the vacuum cleaner from the electrical outlet before assembling, opening or replacing the dust bag, or before connecting/disconnecting the attachments.

CAUTION: The vacuum cleaner is a very powerful unit. Before plugging the cord into the electrical outlet make sure the switch is in the 'off' position.

IMPORTANT: If the inlet or hose is blocked, switch off the vacuum cleaner and remove the blockage(s) before re-starting the vacuum cleaner.

IMPORTANT: Replacing filters and changing the dust bag improves vacuum performance. Make sure the foam filter sleeve is completely dry before inserting back into the vacuum cleaner.

PLEASE KEEP THESE INSTRUCTIONS FOR FURTHER USE

Motor Thermostat

IMPORTANT: The motor is equipped with a thermal cut-out. If, for any reason, the vacuum cleaner should over-heat, the thermostat will automatically turn the unit off. Should this occur, unplug the vacuum cleaner from the wall outlet and turn off the switch. Open the unit and check the dust bag. If full, replace. Wash the foam filter sleeve. Allow the cleaner to cool for approximately one (1) hour.

To re-start, plug into a wall outlet and switch back on.

3. Initial Set Up

IMPORTANT: The accessories are stored in the dust bag compartment and need to be removed before operating the vacuum cleaner.

1. Unclip the retainer clips on either side of the vacuum cleaner and lift off to gain access to the dust bag compartment (Fig.3/1).

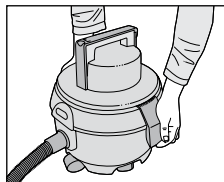

Fig.3/1

2. Remove the accessories (Fig.3/2).

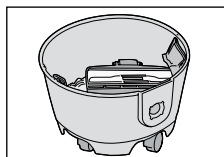

Fig.3/2

3. Fit the dust bag by aligning the front of the dust bag with the inlet slots (Fig.3/3).

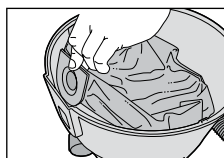

Fig.3/3

4. Position the dust bag to fill the inside of the bin (Fig 3/4).



Fig.3/4

5. Replace motor top.

4. Use and Function

IMPORTANT: Always remove the power plug from the wall outlet before assembling or before removing accessories.

1. Insert the flexible hose into the inlet on the main body of the vacuum cleaner. Push in and twist clockwise a quarter turn until tight (Fig.4/1).

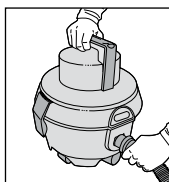

Fig.4/1

2. Push the telescopic extension tube onto the end of the handle (Fig.4/2).

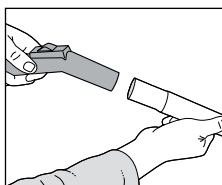

Fig.4/2

3. The telescopic extension tube can be lengthened or shortened by pushing the button in and sliding the tubes apart or together as required (Fig.4/3).

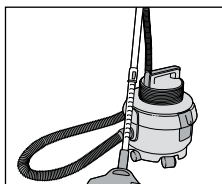

Fig.4/3

4. Fit the combination floor tool by pushing on to the extension tube (Fig 4/4).

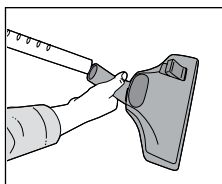

Fig.4/4

5. How to Operate

On/off Button:

Fully unwind the power cord and plug the cord into the electrical outlet. Turn the vacuum cleaner on by depressing the button located on the top of the carry handle (Fig.5/1). The vacuum cleaner can be turned off by pressing the on/off button again.

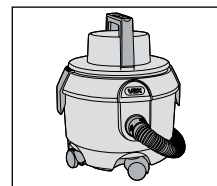

Fig.5/1

Carpet Cleaning

For carpet cleaning, press the rocker switch on the combination floor tool as shown to raise the brushes (Fig.5/2).

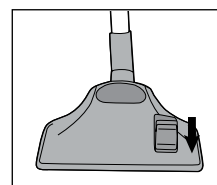

Fig.5/2

Hard Floor Cleaning

For hard floor cleaning, press the rocker switch on the combination floor tool as shown to lower the brushes (Fig.5/3).

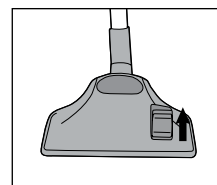

Fig.5/3

Cord Wrap

After use, turn the vacuum cleaner off and unplug from the electrical outlet. Wrap the cord around the top section of the vacuum cleaner and secure in place with the cord clip (Fig.5/4).

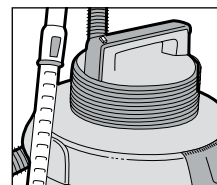

Fig.5/4

Carry Handle

Use the carry handle located on the top of the vacuum cleaner to move from room to room (Fig.5/5).

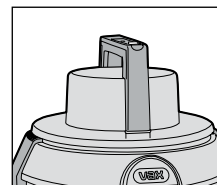

Fig.5/5

6. Accessories

IMPORTANT: Always remove the power plug from the wall outlet before assembling or before removing accessories.

1. The accessories can be attached directly to the handle by removing the telescopic tubes and pushing in the desired accessory (Fig.6/1).

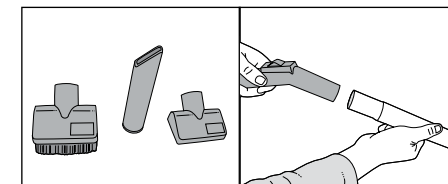

Fig.6/1

2. The accessories can also be attached to the telescopic extension tube for extra reach. Remove the combination floor tool and push on the desired accessory (Fig.6/2).

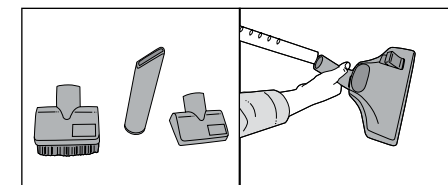

Fig.6/2

Crevice Tool: For crevices, corners, cracks etc.

Dusting Brush: For delicate surfaces.

Upholstery Tool: For carpet, upholstery, stairs etc.