

Machine Overview

- 1 Soft Touch™ Handle Grip
- 2 ON/OFF Switch
- 3 Hose
- 4 Dust Bin release button
- 5 Dust Bin assembly
- 6 Hose Handle
- 7 Cord reel window
- 8 Headlight
- 9 Nozzle control (Turn knob to correct setting for height of carpet being cleaned)
- 10 Furniture guard (Helps prevent cleaner from marking furniture)
- 11 Agitator brush roll shut-off indicator
- 12 Final filter access
- 13 Combination tool (Upholstery & dusting brush)
- 14 Turbo tool
- 15 Crevice tool
- 16 Hose/tool holder
- 17 Wands
- 18 Cord reel
- 19 Soft Touch™ wheels
- 20 Handle release pedal (step on lever to lower handle to operating positions.)
- 21 Cord rewind button (press button to rewind cord for storage. Hold plug until cord is rewound)

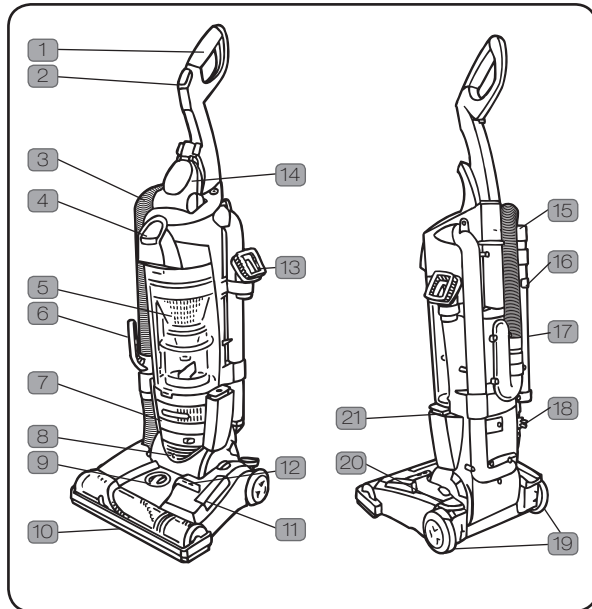

Operate cleaner only at voltage specified on rating plate on back of cleaner.

Accessories

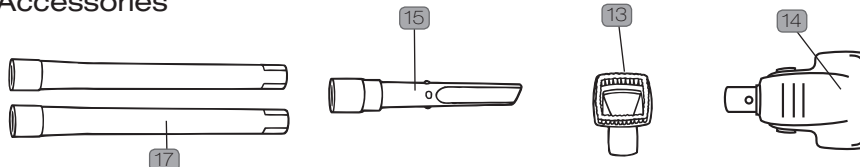

Lubrication

The motor is equipped with bearings that contain sufficient lubrication for the life of the motor. The addition of lubricant could cause damage. Therefore, do not add lubricant to motor bearings.

The agitator brush roll is equipped with two ball bearings that should be lubricated periodically by a Vax Authorised Service Agent.

General Safety Information

FOR HOUSEHOLD USE ONLY.

When using the vacuum cleaner, basic safety precautions should always be observed, including the following:

1. Only use the vacuum cleaner indoors on dry surfaces.
2. Turn off the vacuum cleaner controls before disconnecting or connecting from the mains supply.
3. Always unplug the vacuum cleaner before connecting or disconnecting the vacuum hose and accessories.
4. Children should be supervised to ensure that they do not play with the appliance.
5. This appliance is not intended for use by persons (including children) with reduced physical, sensory or mental capabilities, or lack of experience and knowledge, unless they have been given supervision or instruction concerning use of the appliance by a person responsible for their safety.
6. Use only as described in this manual. Use only Vax recommended attachments.
7. Do not use the vacuum cleaner if it has been dropped, damaged, left outdoors or dropped into water. Do not use the vacuum cleaner with a damaged cord or plug. If the supply cord is damaged, it must be replaced by the manufacturer, its service agent or similarly qualified persons in order to avoid a hazard.
8. Do not pull or carry by cord. Do not use the cord as a handle, close a door on the cord or pull cord around sharp edges or corners. Do not run the vacuum cleaner over the cord. Keep the cord away from heated surfaces.
9. Do not handle the plug or vacuum cleaner with wet hands. Do not use outdoors or on wet surfaces.
10. Do not put any objects into openings. Do not use with any openings blocked and do not restrict airflow. Keep all openings free of dust, lint, hair or anything that might reduce airflow.
11. Keep hair, loose clothing, fingers and all parts of the body away from openings and moving parts.
12. Do not pick up hot coals, cigarette butts, matches or any hot, smoking or burning objects.
13. Do not pick up flammable or combustible materials (lighter fluid, petrol, kerosene etc.) or use in the presence of explosive liquids or vapours.
14. Do not vacuum up harmful or toxic material (chlorine, bleach, ammonia, drain cleaner etc.).
15. Do not vacuum up hard or sharp objects such as glass, nails, screws, coins, etc.
16. Do not use without ALL of the filters in place.
17. Take extra care when vacuuming on stairs.
18. Keep vacuuming area well lit.

19. Store the vacuum cleaner in a cool, dry area.
20. Turn off the on/off switch before unplugging the vacuum cleaner
21. Use only SAA approved 10 amp extension cords. Non-approved cords may overheat. Care should be taken to arrange the cord so that the cord cannot be tripped over.
22. Damaged cord to be replaced by manufacturer or authorised Vax service agent.
23. We recommend the use of a residual current device with a residual current rating of 30mA or less.

 **WARNING:** Always switch off and unplug the vacuum cleaner from the electrical outlet before assembling, opening or emptying the dirt container, or before connecting/disconnecting the attachments.

 **CAUTION:** The vacuum cleaner is a very powerful unit. Before plugging the cord into the electrical outlet, make sure the switch is in the 'off' position. Hold the vacuum cleaner firmly when starting and in use.

 **IMPORTANT:** If the inlet, hose or telescopic tube is blocked, switch off the vacuum cleaner and remove the blockage(s) before re-starting the vacuum cleaner.

 **IMPORTANT:** Cleaning filters improves vacuum performance. Vax recommends that your filters should be checked and cleaned periodically. If your filters are washable make sure they are completely dry before inserting back into the vacuum cleaner.

 **IMPORTANT:** The motor is equipped with a thermal cut-out. If for any reason the unit should overheat, the thermostat will automatically turn the unit off. Should this occur, unplug the vacuum cleaner from the electrical outlet and turn off the switch. Remove dirt container and empty. Clean filters. Allow the unit to cool for approximately one hour. To re-start, plug into an electrical outlet and switch back on.

This vacuum cleaner is intended for household use only and NOT for commercial or industrial use.

PLEASE KEEP INSTRUCTIONS FOR FURTHER USE.

Operation

Carton Contents

- 1 Handle section
- 2 Cleaner base and upper housing assembly
- 3 Extension wands
- 4 Turbo tool
- 5 Crevice tool
- 6 Combination tool (Upholstery/ dusting brush)

Remove all parts from carton and identify each item shown.

Make sure all parts are located before disposing of packing materials.

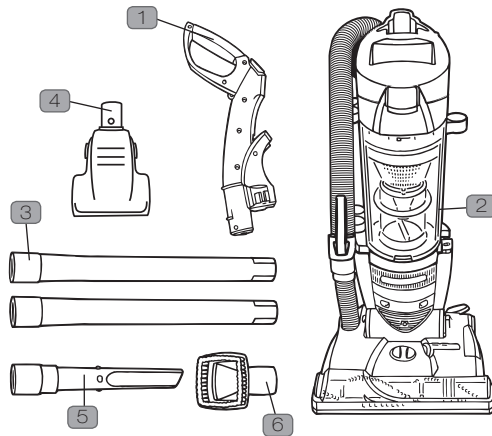

Attach handle

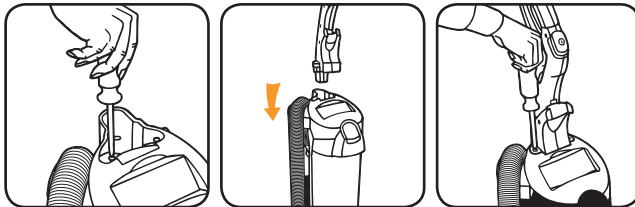

Using a Phillips screwdriver, remove screws from the top of the upper housing assembly. Insert handle section into upper housing assembly. Push down firmly until you hear a click. Fasten screws on either side of handle base.

Position tools

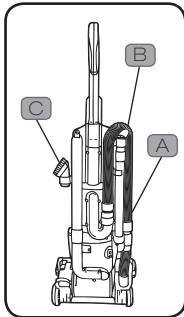

Place smaller diameter end of wand (A) into bottom of rack. Snap wand into clip at top.

Repeat with other wand. Crevice tool (B) fits into one of the extension wands.

Fit combination tool (C) into storage area on side of cleaner as shown.

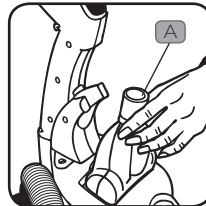

Fit turbo tool (A) into recessed area on front of cleaner. Pivot toward handle to snap in place.

Operation

ON-OFF Switch

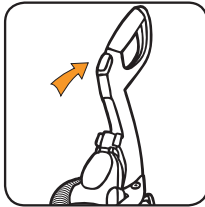

Plug cord into electrical outlet.
To turn cleaner ON, push ON/OFF switch once.
To turn cleaner OFF, push switch again.

Brush Roll Switch

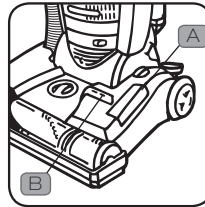

The cleaner is shipped with the agitator brush roll in the OFF position.
To turn the agitator brush roll ON, step on the pedal (A). The indicator (B) will show red in the "brush roll on" window.

Cord Rewind

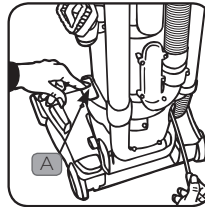

Grasp the end of the plug and pull to release cord from cord reel. After desired cord length is reached, the cord will lock into position. To return cord for storage, hold plug and press on button (A) at top of cord reel. To prevent cord from whipping, hold plug until cord is rewound.

Transporting Cleaner

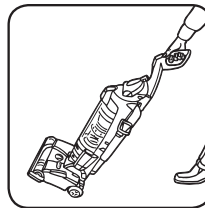

To move your cleaner from room to room, put handle in upright position, tilt cleaner back on rear wheels and push forward.

Handle Positions

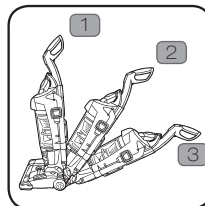

The handle of your cleaner has three positions; upright for storage and when using cleaning tools; operating position for general operation on carpet and floors; low for reaching under low furniture. Step on handle release lever to lower handle.

Operation

Carpet Height Adjustment

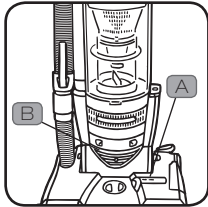

The cleaning of carpet and rugs takes place at the nozzle (A). When it is necessary to raise and lower the nozzle for various carpet pile heights, turn the nozzle control knob (B) to the desired setting.

Settings

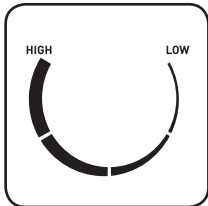

For maximum cleaning performance, the following carpet height settings are recommended:

- Lowest setting: for all types of carpet.

Note: If the cleaner is difficult to push, turn knob to the next higher setting.

- Higher settings: for very deep pile carpet, where easier pushing effort is desired, while maintaining good cleaning performance.

Agitator Brush Roll Shut-Off

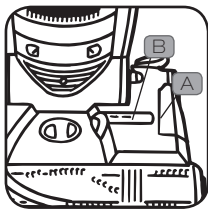

The agitator brush roll shuts off automatically for tool use, when the cleaner is in the upright position.

To manually shut off the agitator brush roll for cleaning hard floors, step on the pedal (A). The indicator (B) will show red in the "brush roll off" window. To turn the agitator brush roll on, step on the pedal again. The indicator will show red in the "brush roll on" window.

 **IMPORTANT:** Turn brush bar off when cleaning hard floors.

Cleaning Tools

Tools allow for cleaning surfaces above the floor and for reaching hard to clean areas.

The cleaner is ready for tool use when handle is in upright position.

The agitator brush roll will not rotate when the cleaner is in the upright position or the if the agitator brush roll shut off indicator is in the OFF position when the handle is lowered.

Operation

Removing Hose

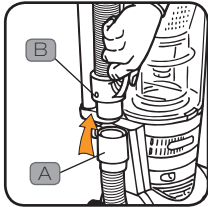

When using cleaning tools, place cleaner handle in the upright position. The agitator brush roll will not rotate when the cleaner is in the upright position. Also, turn cleaner OFF before disconnecting and connecting hose to hose tube (A).

To use hose, lift hose end (B) as shown. When you are finished cleaning with the tools, reposition hose end into tube.

Select Proper Tool

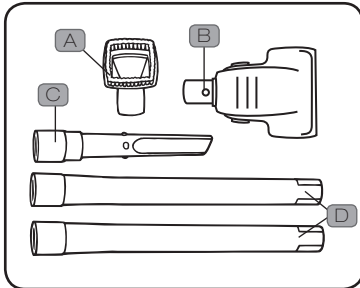

- A** Combination tool (Upholstery/ dust brush) use with brush for carved furniture, table tops, books, lamps, lighting fixtures, venetian blinds, baseboards, shutters, and registers. Remove brush to clean upholstered furniture, draperies, mattresses, clothing, and carpeted stairs.
- B** Turbo tool may be used for upholstered furniture, draperies, mattresses, clothing, automobile interiors, and carpeted stairs.
- C** Crevice tool may be used in tight spaces, corners and along edges in such places as dresser drawers, upholstered furniture, stairs and baseboards.
- D** Extension wands are used to give extra length to your hose. Use them with any of the above tools.

Attached Wand & Tools

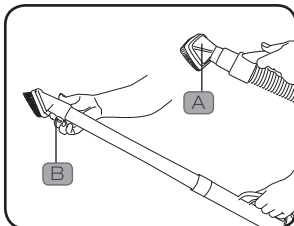

Attach tool or wand to the hose (A).

Attach tool to wand (B) by pushing it firmly onto the wand.

Twist wand or tool slightly to tighten or loosen the connection.

How to clean tools

To clean the hose and turbo tool, wipe off dirt with a cloth dampened in a mild detergent. Rinse with a damp cloth. DO NOT submerge powered hand tool in water.

Cleaning tools may be washed in warm water with a detergent. Rinse and air dry before using.

Combination Tool (Upholstery & Dust Brush)

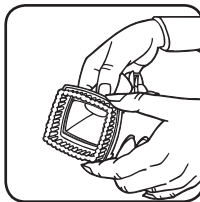
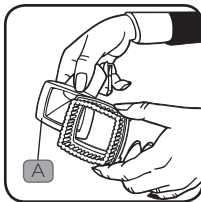

Slide brush to remove.

To replace brushes, align bottom of brush with grooves (A) on tool.

Slide brush into place.

Stair Cleaning

Use the hose and turbo tool for stair cleaning. Clean from bottom to top.

CAUTION: To avoid personal injury or unnecessary wear to carpet, and to prevent the cleaner from falling, always place it at bottom of stairs.

Maintenance

Familiarise yourself with these home maintenance tasks as proper use and care of your cleaner will ensure continued cleaning effectiveness.

Dust Bin

When to Empty

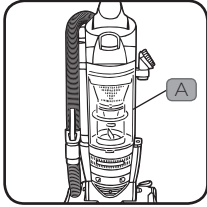

Empty the dust bin before the dirt reaches the fill line (A). Place the cleaner in the upright position before removing the dust bin.

Disconnect cleaner from electrical outlet. Do not use cleaner without dust bin or filters in place.



CAUTION: Very fine materials, such as face powder or cornstarch, may seal the filter and cause a reduction in performance. When using the cleaner for this type of dust, empty the bin and clean the filters often.

How to Empty

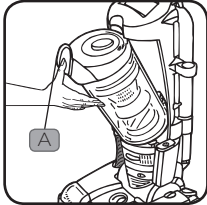

Press dust bin release button (A) and pivot bin out.

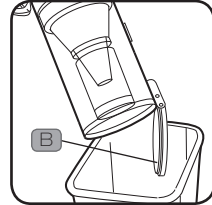
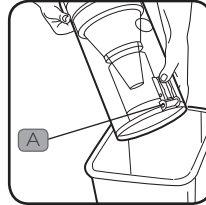
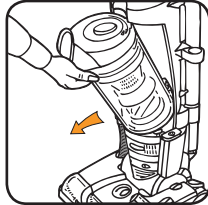

Holding dust bin over trash receptacle, press dust bin door release button (A) to open dust bin door (B).

Close door and press dust bin door release button to latch dust bin door closed.

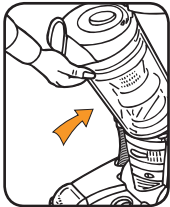

Place bottom of dust bin into cleaner body first.

Pivot cup into cleaner body.

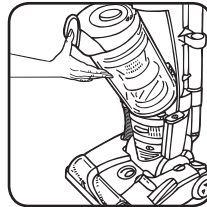

Press on dust bin release button while firmly pressing on dust bin.

Release button in order for it to return to proper position and lock the dust bin into place.

Maintenance

Filters

Cyclonic Filter Assembly: How to Clean

Disconnect cleaner from electrical outlet. Do not use cleaner without dust bin or filters in place.

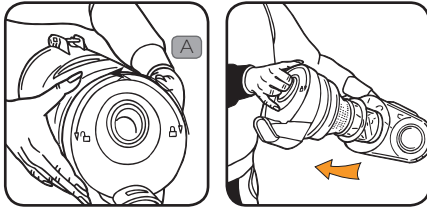

Twist filter assembly (A) counterclockwise.
Remove assembly from dust bin.

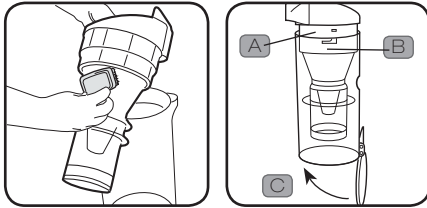

Dirt and debris can be cleaned from the filter assembly by brushing with the cleaner's combination tool.

Place the filter assembly on the dust bin, aligning (3) tabs (A) on filter with (3) slots on dust bin (B) and twist it clockwise to secure into position. Press dirt cup door release button (C) to latch dust bin door closed.

Replace dust bin.

Filters

Secondary Filter: How to Clean

Disconnect cleaner from electrical outlet. Do not use cleaner without dirt cup or filters in place.

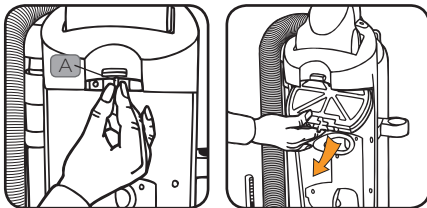

Remove dust bin.

With thumb and forefinger, slide latch (A) located at the top of the housing to the right and pull down to remove grey filter frame. Remove black foam filter. Rinse filter frame cartridge and foam filter under cold water.

Allow both filter frame and filter to air dry for 24 hours before replacing filter into filter frame. Reposition filter frame cartridge by inserting tabs into slots on back of housing. Rotate filter cartridge frame up toward top of housing and snap closed.

Maintenance

HEPA Final Filter: How to Clean

Disconnect cleaner from electrical outlet. Do not use cleaner without dust bin or filters in place.

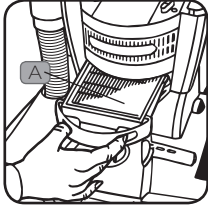

With fingers in slots, pull filter frame (A) straight out.

Dirt and debris can be cleaned from the filter cartridge by brushing with the cleaner's combination tool.

DO NOT RINSE OR WASH the HEPA filter cartridge.

Slide back into position on cleaner.

Clearing Blockages

Disconnect cleaner from electrical outlet.

Low suction or pick up may be due to a blockage in the system. Refer to the following steps to check for blockages continuing with each step until the blockage is found:

Fullness of Dust Bin



Check fullness of dust bin; empty if needed

Check Airflow Path

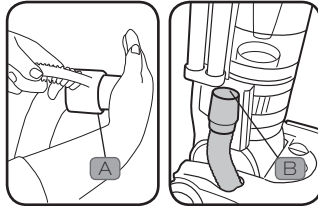

Plug cleaner in and turn ON. Check for suction at end of hose (A). If there is suction turn cleaner OFF and unplug. Check connection at hose tube (B); remove any blockage.

Check Secondary Filter

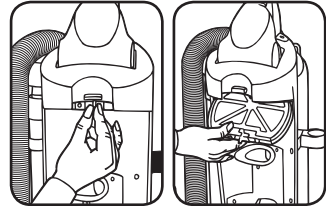

Remove and clean secondary filter. Replace filter.

Check Hose Inlet

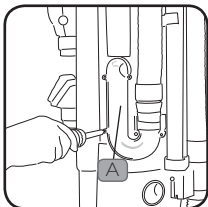

Turn cleaner OFF and unplug. If blockage can be seen in tube (A), remove 5 screws using a Phillips screwdriver.

Pull tube from cleaner, remove blockage.

Reposition tube on back of cleaner, replace 5 screws.

Checking Under Bottom Plate

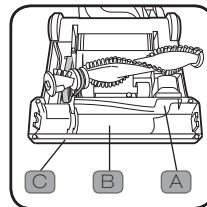

Turn cleaner OFF and unplug.

Remove bottom plate and agitator brush roll.

Look into opening (A), in channels (B) and round liner (C) and remove any accumulated debris.

Replace agitator brush roll and bottom plate.

Maintenance

Blockage in Turbo Tool

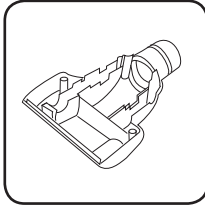

- Disconnect turbo tool from hose.
- Remove bottom plate, belt guard and turbine (see Pg 14-15)
- Remove any blockage from turbine channel.
- Replace belt turbine, brush roll, belt guard and bottom plate.

Headlight

Disconnect cleaner from electrical outlet.

Removing Lens

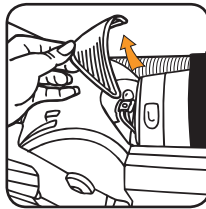
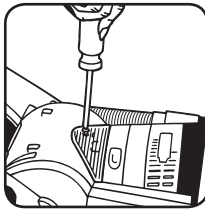

- Press handle release pedal and place handle in low position.
- Using a Phillips screwdriver, remove the the screw as shown and lift off lens.

Headlight: What to buy

The cleaner uses a 13 volt,
T-3 114 wedge base bulb

Installing Bulb

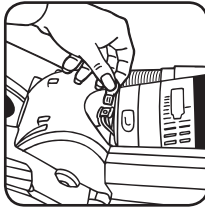

- Pull old bulb straight out of socket. Push new bulb straight into socket until locked in place.
- Excessive force is not required.**

Replacing Lens

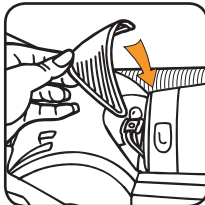

- Reposition lens and secure with the screw.

Maintenance

Belts

Disconnect cleaner from electrical outlet.

The belts are located under the bottom plate of the cleaner and should be checked from time to time to be sure they are in good condition.

 **WARNING:** Agitator brush roll can start suddenly. Unplug cleaner before turning it over.

Replacing Flat Belt

Replace belt if it is stretched, cut or broken. To check the flat belt, refer below.

Removing Bottom Plate

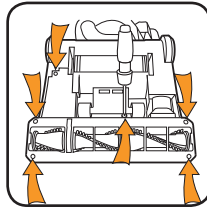

Place handle in low position and turn cleaner over so bottom side is facing up.

Remove the 6 screws as shown with a Phillips screwdriver.

Lift off bottom plate.

Removing Belt

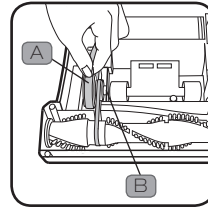

Remove used belt (A) from large pulley (B) and discard.

Positioning Belt

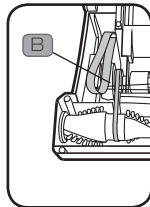
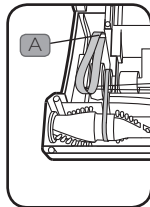

With lettering on outside of belt, slide new belt over motor shaft (A).

Place other end of belt over large pulley (B) while rolling the pulley in direction shown.

Turn agitator brush roll making sure belt turns freely and is not pinched between agitator brush roll and agitator shield.

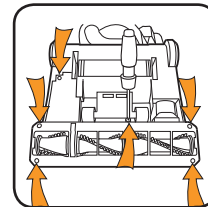

Reposition bottom plate and 6 Phillips head screws. Tighten screws securely.

V-Belt: What to buy

Use only genuine VAX belts with your cleaner

Maintenance

Inspecting V-Belt

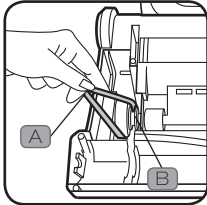

The V-belt is designed to last for a long time and is not normally replaced. However, if the V-belt is cracked, gouged or broken, it should be replaced.

Slide flat belt off large pulley as shown in *Removing Belt*.

To remove V-belt, slide back of belt over pulley (A). Then firmly pull on belt and "snap" it out.

Discard used belt.

To install new belt (with lettering on outside of belt), slide back of belt over pulley and pull front of belt toward groove (B) next to pulley. Belt will "pop" into place.

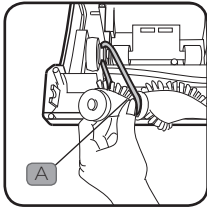

Insert agitator brush roll through belt and position belt in groove (A) on agitator brush roll.

V-Belt: What to buy

Use only genuine VAX belts with your cleaner

Maintenance

Agitator Brush Roll

Disconnect cleaner from electrical outlet.

 **WARNING:** Agitator brush roll can start suddenly. Unplug cleaner before turning it over.

Replacing Agitator Brush Roll

When Agitator brushes are worn, the brushroll should be replaced.

Inspecting Agitator Brush Roll

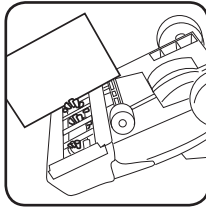

To check condition of brushes, move edge of a card across bottom plate while turning agitator brush roll. To maintain cleaning effectiveness, replace agitator brush roll if brushes do not touch card.

Removing Agitator Brush Roll

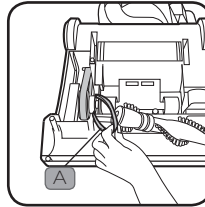

Turn carpet height adjustment knob to lowest setting. Turn cleaner over and remove bottom plate.

Lift up agitator brush roll and slide V-belt (A) off agitator brush roll.

Positioning V-Belt

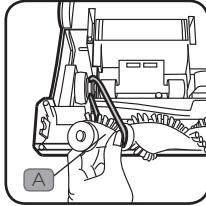

Insert agitator brush roll through belt and position belt in groove (A) on agitator brush roll.

Installing Agitator Brush Roll

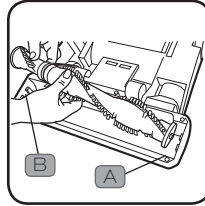

Grasp agitator brush roll firmly and fit it into position by first sliding end opposite the belt into the rectangular slot (A) on side of cleaner. Pull other side of agitator brush roll (B) into place. Belt may fit loosely when properly installed. Reposition flat belt and bottom plate

Turbo Tool

Replacing Agitator Brush Roll

When agitator brushes are worn, the brush roll should be replaced.

How To Replace

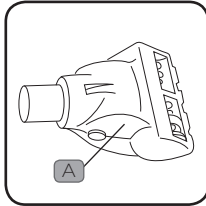

Turn tool so bottom faces up. Press the latches on either side of tool and remove bottom plate (A).

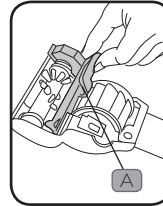
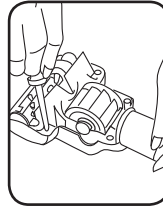

Unscrew the two Phillips screws and remove belt guard (A).

Maintenance

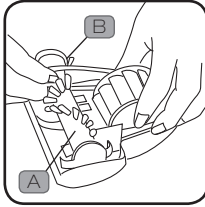

Remove agitator including end plates (A) and discard.

Inspect belt to ensure that it is in good condition. If belt is cracked, gouged or broken, replace it (see following section).

Insert brush roll through belt and position belt over gear teeth (B) on brush roll.

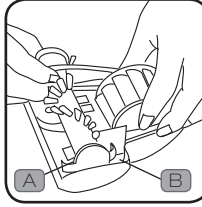

With curved ends down, slide end plates (A) of brush roll into slots (B) on tool.

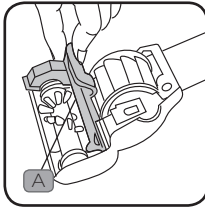

Replace belt guard (A) making sure not to pinch brush bristles in guard. Turn agitator, to make sure it rotates freely.

Replace and tighten screws.

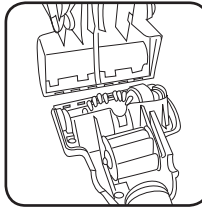

To replace bottom plate, insert the four tabs on edge of bottom plate into slots on front of tool.

Pivot bottom plate down and snap closed.

Belt Replacement

The powered hand tool belt is designed to last a long time and is not normally replaced. However, if the belt is cracked, gouged or broken, it should be replaced.

Inspecting the Belt

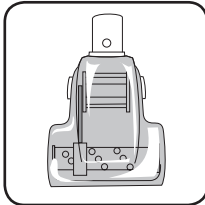

Replace belt guard (A) making sure not to pinch brush bristles in guard. Turn agitator, to make sure it rotates freely.

Replace and tighten screws.

Replacing the Belt

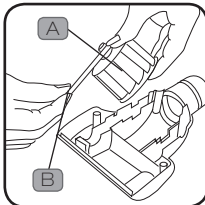

Replace belt guard (A) making sure not to pinch brush bristles in guard. Turn agitator, to make sure it rotates freely.

Replace and tighten screws.

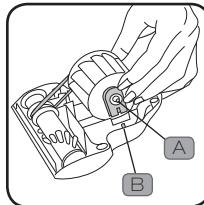

Replace belt guard (A) making sure not to pinch brush bristles in guard. Turn agitator, to make sure it rotates freely.

Replace and tighten screws.

FAQs



WARNING: To reduce the risk of personal injury, unplug the vacuum cleaner before performing maintenance/ troubleshooting checks.

Problem	Possible Reason	Possible Solution
Cleaner won't run	1. Power cord not firmly plugged into outlet.	1. Plug unit in firmly.
	2. Blown fuse or tripped breaker.	2. Check fuse or breaker in home. Replace fuse/reset breaker.
	3. Thermal Protector activated.	3. Unplug and allow cleaner to cool for 60 minutes. (This will reset the thermal protector)
Cleaner won't pick up or low suction	1. Blockage in air flow passages.	1. Clear blockage - Pg. 10.
	2. Dust bin full.	2. Empty dirt cup - Pg. 8.
	3. Agitator Brush Roll worn.	3. Replace Agitator Brush Roll - Pg. 14.
	4. Broken or worn belt.	4. Replace belt - Pg. 12-13.
	5. Clogged filter.	5. Remove filter and clean - Pg. 9-10.
	6. Nozzle/dirt passage hose clogged.	6. Remove lower hose; remove obstruction - Pg. 10.
	7. Carpet height setting is incorrect.	7. Set carpet height adjustment to appropriate setting for carpet being cleaned - Pg. 6.
	8. Agitator Brush Roll is OFF.	8. Step on pedal to turn Agitator Brush Roll on -Pg. 6.
Dust escaping from cleaner	1. Dust bin full.	1. Empty dust bin - Pg. 8.
	2. Dust bin not installed correctly.	2. Review dirt cup removal and replacement -Pg. 8-9
	3. Hose not installed correctly.	3. Review hose installation - Pg. 7.
	4. Filter not installed completely.	4. Review filter removal and replacement - Pg. 9-10.
Headlight not working	1. Bulb burnt out.	1. Replace bulb - Pg. 11.
	2. Loose electrical wires.	2. Do not use - disconnect from power and contact an Authorised VAX Service Agent.
Cleaner is difficult to push or won't move forward	1. Carpet height setting is incorrect.	1. Set carpet height adjust lever to appropriate setting for carpet being cleaned - Pg. 6.
Turbo Tool Brush Roll won't turn	1. Too much pressure being applied to tool.	1. Continue using tool applying light pressure.
	2. Blockage in turbine channel.	2. Remove blockage - Pg. 11.
	3. Broken or worn belt.	3. Replace belt - Pg. 12-13.
	4. Low cleaner suction.	4. Check items under "Cleaner won't pick or low suction."
Smoky/burning smell detected	1. Belt broken or stretched.	1. Replace agitator brush roll belt - Pg. 14.



we  to help

Don't take your machine back to the shop, simply contact us

www.vax.com.au

AU: 1300 361 505
NZ: 0800 800 900

Other Information

Vax Service & Help

Vax Customer Careline AU: 1300 361 505 / NZ: 0800 800 900

Monday - Friday 8.30am to 5.30pm

Any queries or concerns about using the Vax, call the Vax Careline. Calls are charged at the Standard national rate.

Please make a note of the serial number and model number of the carpet cleaner before calling. For the nearest Service Agent, please call the Vax Customer Careline or visit www.vax.com.au

Technical Specification

Voltage:	220-240V ~50Hz
Wattage:	1500W
Air Watts:	160AW
Capacity:	1.5L
Filters:	Pre-motor: Washable Sponge filter Central filter: Non-Washable, Multicyclonic Post-motor: Washable, Antibacterial HEPA filter
Cord Length:	8.5m
Weight:	10.5kg
Hose Length:	2.6m Stretch Hose

Subject to technical change without notice.



N197



Double Insulated



Indoor Use



Read Instructions



Waste electrical products should not be disposed of with household waste. Please recycle where facilities exist. Check with your Local Authority or retailer for recycling advice.

Notes

Notes



we  clean

Distributed by Techtronic Industries Ptd. Ltd.
Level 1. 666 Doncaster Rd, Doncaster, Australia 3108.
www.vax.com.au Service Line: AU: 1300 361 505 / NZ: 0800 800 900