



**'DON'T TAKE IT
BACK TO THE SHOP!'**

Congratulations on the purchase of this Vax product. In the unlikely event of experiencing a problem, call

VAXCARE



Australia **1300 36 4040**

(Monday - Friday 10am - 6pm EST)

Email: vaxcare@vax.com.au

New Zealand **0800 800 900**

Email: vaxcare@vax.com.au

www.vax.com.au



www.vax.com.au

Vaxcare:
AUST: 1300 36 4040
NZ: 0800 800 900

Bagless cylinder

vax
ZERO **Infinity**

VZ-704

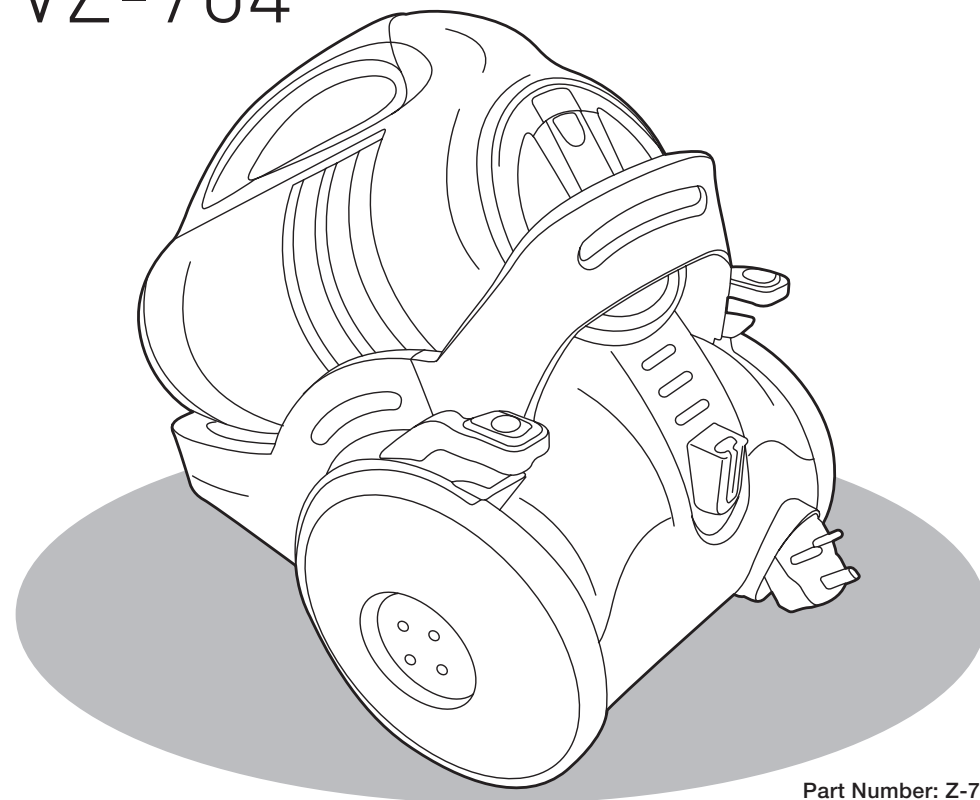

Part Number: Z-7000

Instruction Manual

Please read carefully before using this cleaner.
Always fully extend the mains cable before use.
Retain for future reference.

1. Safety Information

FOR HOUSEHOLD USE ONLY

When using the vacuum cleaner, basic safety precautions should always be observed, including the following:

1. Only use the vacuum cleaner indoors on dry surfaces.
2. Turn off the vacuum cleaner controls before connecting or disconnecting from the mains supply.
3. Always unplug the vacuum cleaner before connecting or disconnecting the vacuum hose and accessories.
4. This appliance is not intended for use by young or infirm persons unless they have been adequately supervised by a responsible person to ensure that they can use the appliance safely.
Young children should be supervised to ensure that they do not play with the appliance.
5. Use only as described in this manual.
Use only the manufacturer's recommended attachments.
6. Do not use the vacuum cleaner if it has been dropped, damaged, left outdoors or dropped into water. Do not use the vacuum cleaner with a damaged cord or plug. If the supply cord or plug is damaged, return the vacuum cleaner to a Vax Authorised Service Agent for examination, repair or replacement.
7. Do not pull or carry by the cord. Do not use the cord as a handle, close a door on the cord or pull the cord around sharp edges or corners. Do not run the vacuum cleaner over the cord. Keep the cord away from heated surfaces.
8. Do not handle the plug or vacuum cleaner with wet hands. Do not use outdoors or on wet surfaces.
9. Do not put any objects into openings. Do not use with any openings blocked and do not restrict air flow. Keep all openings free of dust, lint, hair or anything that may reduce airflow.
10. Keep hair, loose clothing, fingers and all parts of the body away from openings and moving parts.
11. Do not pick up hot coals, cigarette butts, matches or any hot, smoking or burning objects.

12. Do not pick up flammable or combustible materials (lighter fluid, petrol, kerosene, etc) or use in the presence of explosive liquids or vapours.
13. Do not vacuum up harmful or toxic material (chlorine bleach, ammonia, drain cleaner, etc).
14. Do not vacuum up hard or sharp objects such as glass, nails, screws, coins, etc.
15. Do not use without the filters in place.
16. Take extra care when vacuuming on stairs.
17. Keep vacuuming area well lit.
18. Store the vacuum cleaner indoors in a cool, dry area.
19. Turn off the on/off switch before unplugging the vacuum cleaner.

WARNING: Always switch off and unplug the vacuum cleaner from the electrical outlet before assembling, opening or emptying the dirt container, or before connecting/disconnecting the attachments.

IMPORTANT: If the inlet, hose or telescopic tube is blocked, switch off the vacuum cleaner and remove the blockage(s) before re-starting.

This vacuum cleaner is intended for household use only and not for commercial or industrial use.

Replacement Filters

If lost or damaged, replacement filters are available from your stockist or VAX direct. Phone VAXCARE or visit www.vax.com.au for stockist listing.

Motor Thermostat

IMPORTANT: The motor is equipped with a thermal cut-out. If for any reason, the vacuum cleaner should over-heat, the thermostat will automatically turn the unit off. Should this occur, unplug the vacuum cleaner from the electrical outlet and turn off the switch. Remove the dirt container and empty. Clean or replace the filters. Allow the cleaner to cool for approximately one (1) hour before restarting.

8. Storage

IMPORTANT: Always unplug the vacuum cleaner from the electrical outlet and rewind the power cord as directed before storing.

NOTE: Always store the vacuum cleaner base down.

9. Troubleshooting

WARNING: To reduce the risk of injury, unplug vacuum cleaner before servicing.

PROBLEM: Vacuum cleaner won't run

Cause: Not properly plugged into electrical outlet.

Solution: Plug in firmly.

Cause: No electricity in the electrical outlet.

Solution: Check fuse or breaker.

Cause: On/off switch not turned on.

Solution: Push on/off switch to on.

Cause: Motor thermostat tripped.

Solution: Switch off and unplug the vacuum cleaner. Leave for one (1) hour before switching the vacuum cleaner back on.

Cause: Blown fuse/tripped breaker.

Solution: Reset house circuit breaker or replace fuse.

PROBLEM: Cleaner won't pick up/loss of suction

Cause: Dirt container not installed properly.

Solution: Review dirt container replacement.

Cause: Dirt container full or blocked.

Solution: Empty dirt container.

Cause: Clogged filters.

Solution: Remove, clean and replace filters.

PROBLEM: Accessories won't pick up

Cause: Accessories not attached correctly.

Solution: Refer to section 5.

PROBLEM: Dust escaping from the vacuum cleaner

Cause: Dirt container full.

Solution: Empty dirt container.

Cause: Dirt container not installed correctly.

Solution: Review dirt container replacement.

Cause: Filter not installed completely.

Solution: Remove, clean and replace filters.

10. Technical Specification

Name:	Infinity
Model No:	VZ-704
Part No:	Z-7000
Voltage:	220-240V~50Hz
Wattage:	1600W
Capacity:	3 litres approx
Filters:	Cyclone separator - wipe clean Pre-motor filter - washable Post-motor filter - washable
Cord length:	8m (approx)
Weight:	8.55kg (approx)

Subject to technical change without notice.

11. VAXCARE Service & Help: AUSTRALIA 1300 36 4040 NEW ZEALAND 0800 800 900

If you have any queries or concerns about using your Vax, call VAXCARE. Please make a note of the part number or model number of the appliance before calling.
(Aust only: Mon-Fri. 10.00am to 6.00pm. EST)
Calls are charged at the local rate.
An answerphone is available out of these hours.

There are over 300 approved Vax Service Agents in Australia and New Zealand. For the nearest Service Agent, please refer to your Vax warranty or call VAXCARE or visit www.vax.com.au

Cleaning the Pre-motor filter

NOTE: This is located underneath the dirt container bin.

1. Release the pre-motor filter cover by rotating the lid counter-clockwise. Lift off the filter cover to gain access to the filter. Remove the filter by pulling the tab towards you (Fig.6/5).

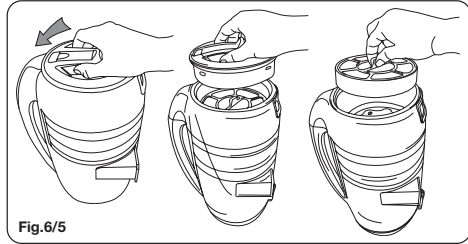

2. Separate the foam filter from the fabric cassette. Each filter can be tapped against the side of a dust bin to remove the excess dirt and dust (Fig.6/6).

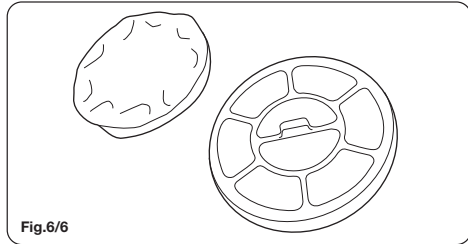

3. The pre-motor filters may be rinsed in warm water (max 40°C). Allow to thoroughly air dry before replacing.

NOTE: Do not use any detergents or boiling water to wash the filter. Vax recommends this filter should be checked and cleaned periodically.

4. Once completely dry, return the pre-motor filters and cassette to the vacuum cleaner. Replace the pre-motor filter cover before restarting the vacuum cleaner.

Cleaning the Post-motor filter

NOTE: This is located on the bottom of the vacuum cleaner.

1. Release the post-motor filter cover and remove the cover as shown. Remove the filter by pulling the tabs towards you (Fig.6/7).

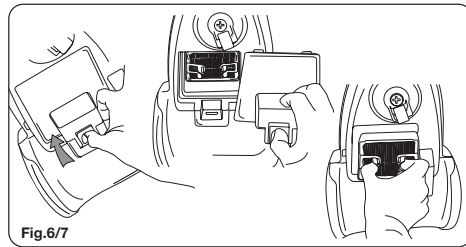

2. The filter can be tapped against the side of a dust bin to remove the excess dirt and dust (Fig.6/8).

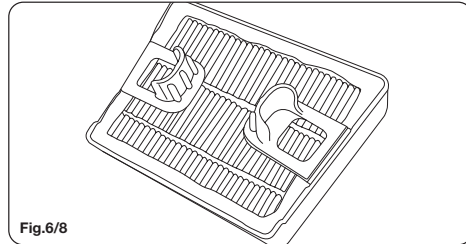

3. The post-motor filter may be rinsed in warm water (max 40°C.). Allow to thoroughly air dry before replacing.

NOTE: Do not use any detergents or boiling water to wash the filters. Vax recommends washing the filter every 3-6 months.

4. Once completely dry, return the post-motor filter to the vacuum cleaner. Replace the post-motor filter cover before restarting the vacuum cleaner.

7. Cleaning Blockages

WARNING: To reduce the risk of injury, the power cord must be disconnected before performing maintenance / troubleshooting checks.

1. Turn the vacuum cleaner off and unplug from the electrical outlet.
2. The flexible hose can be disconnected from the vacuum cleaner by turning the hose to the left and pulling away from the machine. Remove any blockages found then reconnect the hose securely.

2. Parts Overview

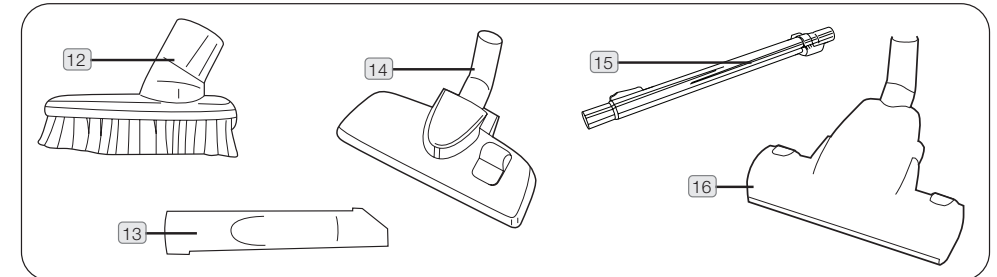
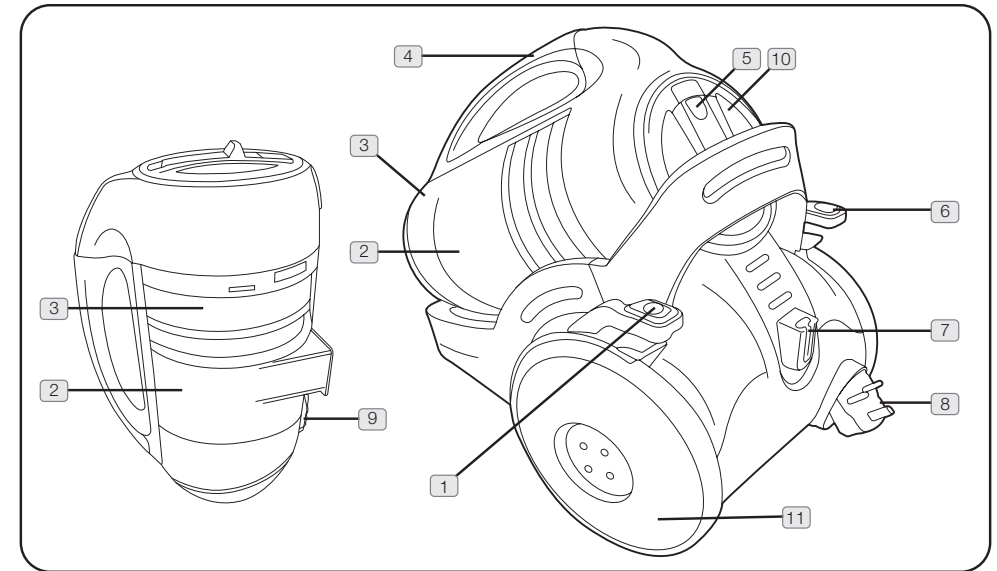

- 1 On/off button
- 2 Dirt container
- 3 Cyclone separator
- 4 Dirt container carry handle
- 5 Dirt bin release button
- 6 Auto cord rewind
- 7 Floor tool parking slot
- 8 Electrical cord
- 9 Quick dirt release button

- 10 Pre-motor filter cover
- 11 Wheel

Accessories

- 12 2-in-1 dusting and upholstery brush
- 13 Crevice tool
- 14 Combination floor head
- 15 Telescopic tube
- 16 TurboBrush head
- 17 Flexible hose with tool caddy

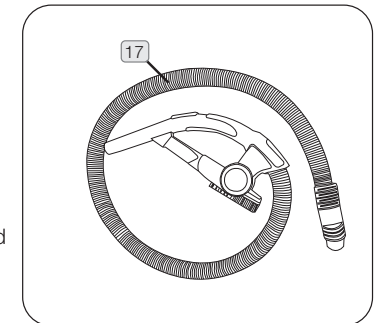

3. How to Assemble

IMPORTANT: Always unplug the vacuum cleaner from the electrical outlet before assembling or removing the accessories.

1. Insert the flexible hose (Fig.3/1) into the inlet on the main body of the vacuum cleaner. Make sure the projected parts on the hose are aligned. Turn the hose to the right until it clicks into lock position.

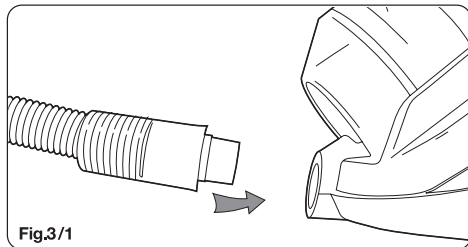

2. Push the telescopic extension tube on to the end of the handle (Fig.3/2).

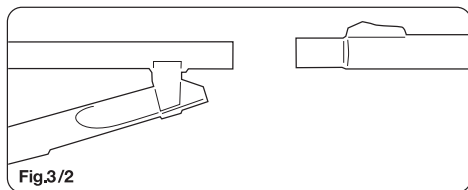

3. The telescopic tube can be lengthened or shortened by pushing the button in and sliding the tube apart or together as required (Fig.3/3).

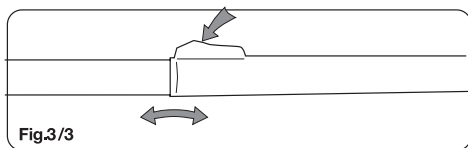

4. Fit the combination floor head or TurboBrush by pushing onto the extension tube (Fig.3/4).

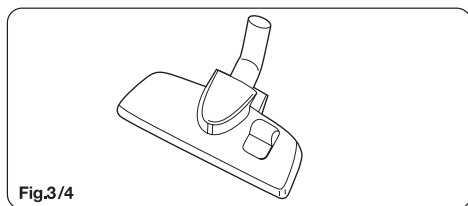

4. How to Operate

Cord Release

Fully unwind the power cord. A yellow mark on the power cord indicates the recommended cord length. Do not unwind the cord beyond this mark.

On/off Button

1. Insert the plug into the electrical outlet.
2. Press the on/off switch located on the top of the vacuum cleaner to switch on the vacuum cleaner and press the button again to turn the vacuum cleaner off.

Carpet Cleaning

For carpet and rug cleaning press the rocker switch on the combination floor head to raise the brushes.

Hard Floor Cleaning

For hard floor cleaning press the rocker switch on the combination floor head to lower the brushes.

Cord Rewind

To rewind the power cord, press the cord rewind button located on the top of the vacuum cleaner and guide the power cord with one hand. Rewind 1-1½ metres of cord at a time. This will prevent the cord from whipping which could cause damage or injury.

Carry Handle

Use the carry handle located on the top of the vacuum cleaner to move from room to room.

Hose Storage

For convenience there is a parking slot located at the rear of the vacuum cleaner where the floor tool and hose can be parked for carrying and storage.

5. Accessories

1. The accessories can be attached directly to the handle by removing the telescopic tubes and pushing in the desired accessory.
2. The accessories can also be attached to the telescopic extension tube for extra reach. Remove the combination floor head and push on the desired accessory.

2-in1 tool:

Dusting brush: for delicate surfaces
Upholstery tool: for carpet, upholstery and stairs etc.

Crevice tool: for crevices, corners and cracks, etc.

TurboBrush: for pet hair and large carpeted areas.

NOTE: Do not use the Turbo Brush on suede and leather surfaces.

6. Dirt Container & Filters Removal & Replacement

IMPORTANT: Always unplug the vacuum cleaner from the electrical outlet before removing the dirt container.

IMPORTANT: Do NOT use the vacuum cleaner without ALL of the filters in place.

Emptying the dirt container

1. Press down the dirt bin release button located on the dirt container and lift to remove (Fig.6/1).

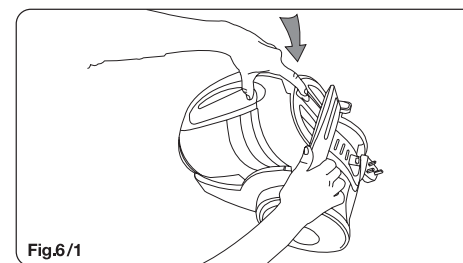

2. Hold the dirt container over a bin and press the quick release button to empty the container (Fig.6/2). When emptied, close the dirt container flap. A click will be heard when closed. Replace the dirt container.



Cleaning the cyclone separator

1. Remove the dirt container from the unit and dispose of dirt inside the container before cleaning.
2. Rotate the lid of the dirt container anti-clockwise to remove the dirt container off the cyclonic separator.

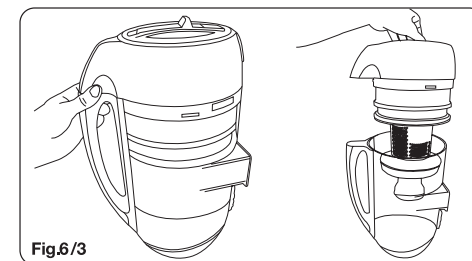

3. The separator should be cleaned with a soft brush and wiped with a damp cloth. The dirt container can be wiped clean (Fig.6/4).

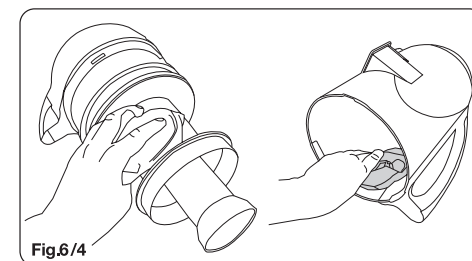

IMPORTANT: The cyclonic separator should not be submerged in water.

4. When the cyclone separator has been cleaned and has dried completely, re-attach the transparent bin to the lid of the separator and return the dust bin to the unit.